

S.M. Wright Phase II Project

I-45 and SH 310 Project



PROJECT OVERVIEW

The S.M. Wright Phase II project will improve the neighborhood environment, safety and mobility in the area of Interstate 45 (I-45) and US 175/C.F. Hawn freeways. The project transforms the existing S.M. Wright freeway into a six-lane, street level boulevard with traffic signals. Freeway overpasses will be removed, and the boulevard will include landscaping and sidewalks. The project will feature enhanced community gateways to help promote neighborhood identity and local connections, while also helping spur community investment, development and rejuvenation. The S.M. Wright Phase II project is \$79 million and is scheduled for completion in fall 2023.

BUILDING FOR THE FUTURE



- Converting the existing freeway-to-freeway connections between I-45 and State Highway 310 (SH 310) to a diamond interchange providing access to two cross-streets: Martin Luther King Jr. Boulevard (MLK) and Al Lipscomb Way (formerly Grand Avenue).



- The proposed improvements will extend SH 310 to connect exclusively to Cesar Chavez Boulevard.



- The existing SH 310 underpass of MLK will be converted to an at-grade, signalized intersection.
- The existing I-45 frontage roads will be extended to MLK, and the existing ramps connecting MLK and I-45 will be relocated to the proposed signalized intersections of the proposed frontage roads and MLK.



- A northbound exit ramp to Al Lipscomb Way from I-45 as well as a southbound entrance ramp from Al Lipscomb Way to I-45 will also be constructed.



- Pedestrian and bicycle improvements, including sidewalks and shared use bicycle lanes, will be constructed along SH 310 to create a continuous network between SH 310, MLK, Al Lipscomb Way and Good Latimer Expressway.

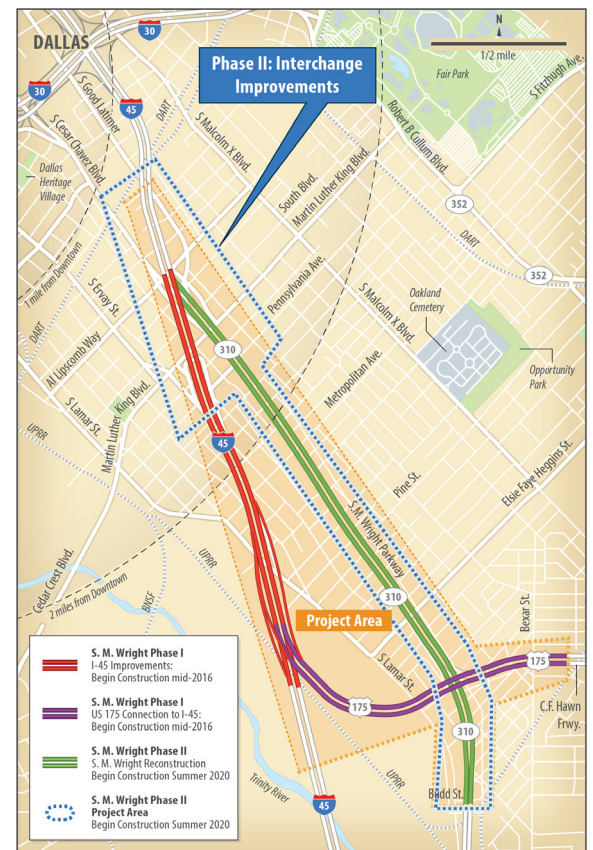

DID YOU KNOW?

The S.M. Wright Phase II construction will consist of the reconfiguration of the existing interchange between IH 45 and SH 310 (S.M. Wright Parkway), Cesar Chavez Boulevard and Good Latimer Expressway.



Project Website:

To learn more about the S.M. Wright Phase II Project, please visit the website at smwrightproject.com.



For Additional Information Contact:

info@smwrightproject.com
214-390-7130

S.M. Wright Phase II Project

I-45 and SH 310 Project



S.M. WRIGHT | SITE PLAN RENDERING

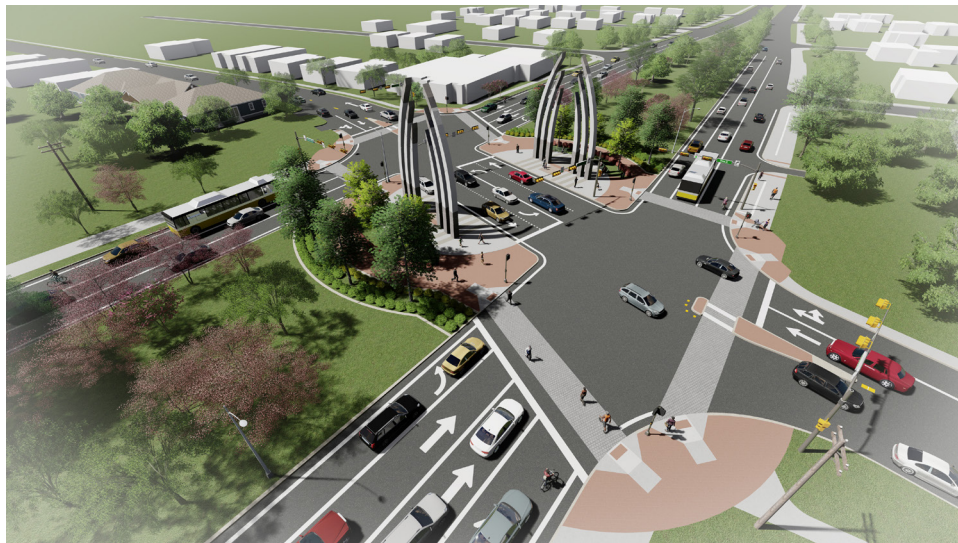

PINE STREET & S.M. WRIGHT | SOUTH EAST CORNER LOOKING WEST



PINE STREET & S.M. WRIGHT | SOUTH EAST CORNER LOOKING WEST