

1 Adam A. Edwards*
 aedwards@milberg.com
 2 William A. Ladnier (CA Bar No. 330334)
 wladnier@milberg.com
 3 Virginia Ann Whitener*
 gwhitener@milberg.com
 4 **MILBERG COLEMAN BRYSON**
PHILLIPS GROSSMAN, PLLC
 5 800 S. Gay Street, Suite 1100
 6 Knoxville, TN 37929
 Tel: (865) 247-0080
 7 Fax: (865) 522-0049

8 Mitchell Breit*
 mbreit@milberg.com
 9 **MILBERG COLEMAN BRYSON**
PHILLIPS GROSSMAN, PLLC
 10 405 E. 50th Street
 11 New York, NY 1002
 Tel: (347) 668-8445

12 * *Pro hac vice forthcoming*

13 *Attorneys for Plaintiffs*
14 *and the Proposed Classes*

15
16
17 **UNITED STATES DISTRICT COURT**
18 **NORTHERN DISTRICT OF CALIFORNIA**

19 JAMES PORTER, BRYAN PEREZ, and
20 DRO ESRAEILI ESTEPANIAN, on behalf
21 of themselves and all others similarly
situated,

22 Plaintiffs,

23 v.

24 TESLA, INC. d/b/a TESLA MOTORS,
25 INC.,

26 Defendant.
27

Case No. _____

CLASS ACTION COMPLAINT

DEMAND FOR JURY TRIAL

1 **CLASS ACTION COMPLAINT**

2 Plaintiffs James Porter, Bryan Perez, and Dro Esraeili Estepanian (collectively,
3 “Plaintiffs”) bring this action on behalf of themselves and all others similarly situated, against
4 Defendant Tesla, Inc. (d/b/a Tesla Motors, Inc.) (“Tesla”). Plaintiffs’ allegations are based upon
5 personal knowledge and belief as to their own acts, upon the investigation of their counsel, and,
6 where specifically stated, upon information and belief.

7 **INTRODUCTION**

8 1. Plaintiffs bring this action individually and on behalf of a proposed class of
9 similarly situated owners of Tesla model vehicles. This action arises out of Tesla’s false
10 advertising of its electric vehicles’ range, which Tesla grossly overvalued when selling the
11 vehicles to consumers.

12 2. Tesla designs, manufactures, advertises, markets, and sells electric vehicles to
13 consumers.

14 3. A key feature of electric vehicles is the “range” of the electric vehicle—that is,
15 the distance the electric vehicle can be driven on a single battery charge, before requiring the
16 driver to stop and recharge the vehicle. The electric vehicle’s range directly correlates to the
17 electric vehicle’s battery charge. An electric vehicle’s range is roughly equivalent to a gas-
18 powered vehicle’s potential range it can be driven on a single tank of gas, or it’s “distance to
19 empty.”

20 4. The electric vehicle’s range is one of the most important features that consumers
21 generally consider when purchasing an electric vehicle, because it correlates to the distance they
22 can travel before needing to recharge the vehicle. In fact, when a consumer visits Tesla’s website
23 to view any of Tesla’s various electric vehicle models, “range” is the *first* listed feature
24 advertised among other key features.

25 5. Understanding that this would be an important feature (if not the most important
26 feature) to many consumers, and preying on this fact, Tesla marketed its electric vehicles as
27 having a grossly overvalued range in an effort to increase sales to consumers. As it so happens,

1 Tesla advertised its vehicles as having ranges that, in some instances, were 26% over the actual
2 average range of the electric vehicle.¹

3 6. After purchasing their Tesla electric vehicles, many Tesla owners noticed that the
4 average range in their vehicles was well-below the range Tesla had advertised prior to their
5 purchase. As some owners grew concerned, they contacted Tesla to schedule service
6 appointments to confirm whether anything was wrong with their electric vehicle or its battery.

7 7. However, many consumers who complained or scheduled appointments with
8 Tesla regarding the below-advertised ranges in their vehicles discovered that Tesla would cancel
9 such appointments and would explain that their electric vehicle was performing as intended.²

10 8. As a result of Tesla's unfair, deceptive, and/or fraudulent business practices in
11 advertising grossly overestimated range statistics for its electric vehicles to consumers, Tesla
12 purchasers, including Plaintiffs, were harmed.

13 9. Had Plaintiffs and putative Class Members known that the advertised range of
14 Tesla vehicles were grossly overestimated, they would not have bought Tesla model vehicles, or
15 else would have paid substantially less for them.

16 10. As a result of Tesla's tactics and false advertising, Plaintiffs and Class Members
17 suffered an injury in fact, incurred damages, and have been harmed by Tesla's conduct.

18 11. Accordingly, Plaintiffs bring this action to redress Tesla's violations of state
19 consumer fraud statutes, fraud, negligent misrepresentation, breach of express warranty, breach
20 of implied warranty, violation of California's Song-Beverly Consumer Warranty Act, and unjust
21 enrichment.

22 **PARTIES**

23 12. Plaintiff James Porter is a resident and citizen of Petaluma (Sonoma County),
24 California. In March 2022, Plaintiff Porter ordered a 2022 Tesla Model Y Performance vehicle.

25 _____
26 ¹ <https://www.reuters.com/investigates/special-report/tesla-batteries-range> (last visited July 28,
2023).

27 ² *Id.*

1 In June 2022, Plaintiff Porter received his Tesla vehicle.

2 13. Plaintiff Bryan Perez is a resident and citizen of Lancaster (Los Angeles County),
3 California. In February 2022, Plaintiff Perez ordered a 2021 Tesla Model 3 Long Range vehicle.
4 In March 2022, Plaintiff Perez received his Tesla vehicle.

5 14. Plaintiff Dro Esraeili Estepanian is a resident and citizen of Palmdale (Los
6 Angeles County), California. In or around December 2021 or January 2022, Plaintiff Estepanian
7 ordered a 2022 Tesla Model 3 Long Range vehicle. In July 2022, Plaintiff Estepanian received
8 his Tesla vehicle.

9 15. Defendant Tesla, Inc. d/b/a Tesla Motors, Inc. is a Delaware corporation, with its
10 principal place of business in Austin, Texas. Accordingly, for jurisdictional purposes, Defendant
11 Tesla, Inc. d/b/a Tesla Motors, Inc. is a citizen of the States of Delaware and Texas.

12 **JURISDICTION AND VENUE**

13 16. This Court has subject matter jurisdiction pursuant to 28 U.S.C. § 1332. This
14 Court also has supplemental jurisdiction over the state law claims pursuant to 28 U.S.C. § 1367
15 because those claims are related to the federal claims and form part of the same case and
16 controversy.

17 17. This Court also has subject matter jurisdiction pursuant to the Class Action
18 Fairness Act, 28 U.S.C. § 1332(d). The aggregated claims of the individual class members
19 exceed the sum or value of \$5,000,000.00, exclusive of interest and costs; there are more than
20 100 putative class members; and at least one putative class member is from a state different from
21 Tesla.

22 18. This Court has personal jurisdiction over Tesla because it conducts substantial
23 business in this District and because Tesla is registered to do business in California. Moreover,
24 Tesla was previously headquartered in this District, and continues to maintain a substantial
25
26
27

1 portion of its business in this District.³

2 19. Venue is proper in this District under 28 U.S.C. § 1391 because a substantial part
3 of the events or omissions giving rise to the claims occurred in this District. Venue is also proper
4 in this District under 18 U.S.C. § 1965 because Tesla transacts its affairs in this District and the
5 ends of justice require it.

6 **DIVISIONAL ASSIGNMENT**

7 20. Assignment to the San Francisco or Oakland Division is proper under Civil Local
8 Rules 3-2(c) and 3-2(d) because a substantial part of the events or omissions giving rise to
9 Plaintiff James Porter’s claims occurred in Sonoma County.

10 **GENERAL FACTUAL ALLEGATIONS**

11 21. Tesla designs, manufactures, advertises, markets, and sells its electric vehicles
12 throughout the United States and worldwide.

13 22. Tesla sells four main models of electric vehicles, each of which includes various
14 “sub-models” or versions: the Model 3, the Model Y, the Model S, and the Model X.

15 **The Tesla Purchasing Experience**

16 23. Tesla sells its vehicles directly to consumers. Although Tesla has dealerships and
17 showrooms, Tesla maintains control over those dealerships and ensures that all sales of its
18 vehicles are directly through Tesla, rather than a third party.

19 24. Consumers wishing to purchase a Tesla vehicle, thus, most often do so through
20 Tesla’s website, by selecting the preferred model and various features to “build” the vehicle they
21 will purchase.

22 25. For example, a consumer wishing to purchase a Tesla Model 3—Tesla’s baseline
23 model vehicle—can view available inventory or create a custom order, by selecting the features
24 they most prefer.

25
26 _____
27 ³ See <https://cleantechnica.com/2023/03/17/teslas-engineering-headquarters-in-california> (last
visited July 28, 2023).

1 26. For the Model 3, for example, Tesla advertises 3 attributes above all others: the
2 price, the vehicle's acceleration from 0-60 mph, and the vehicle's range. See below:⁴

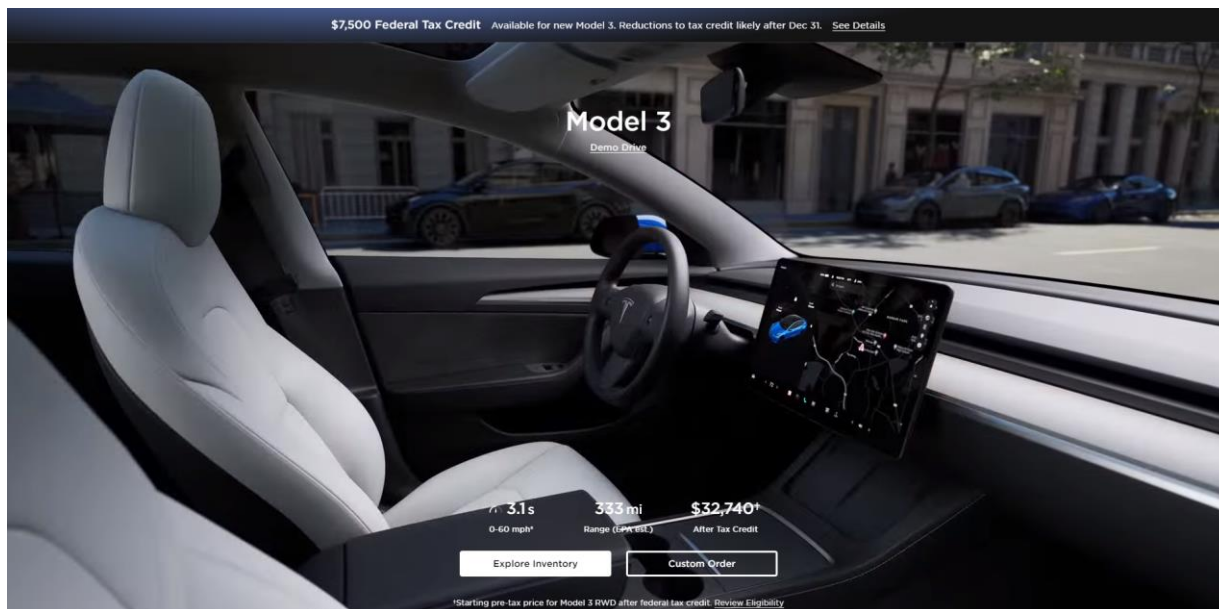

14
15
16 (continued on next page)

17
18
19
20
21
22
23
24
25
26
27 ⁴ <https://www.tesla.com/model3> (last visited July 28, 2023)

27. If a consumer wishes to explore available inventory, Tesla lists options available for purchase directly from Tesla, including “key features” of the vehicle. Among these “key features,” Tesla lists the range, top speed, and vehicle’s acceleration from 0-60 mph, in that order, along with the price, model, and version of the vehicle (as indicated in the example below):⁵



28. Consumers also may “custom order” their Tesla vehicle, by choosing the particular vehicle features and attributes they prefer. With this option, Tesla custom builds the vehicle to the consumer’s preference.

29. By custom ordering, a consumer can ensure they select a custom-tailored Tesla vehicle to their preference, selecting the ideal version, range, wheel style, color, and interior trim. Any time a feature selection is changed, the vehicle’s price, range, top speed, and acceleration from 0-60 mph will be adjusted. While certain features may impact the vehicle’s price, not all features will impact the vehicle’s range, speed, or acceleration. For example, selecting a red paint style and black-and-white interior trim will increase the price by \$3,000 total, it will not impact

⁵https://www.tesla.com/m3/order/5YJ3276_9cf71b05e29b56b2eb5242ecb2f0eafc?postal=37923&range=200®ion=TN&coord=35.9375,-84.073&titleStatus=new&redirect=no#overview (last visited July 28, 2023).

1 the vehicle’s range, speed, or acceleration; but selecting 19” sport wheels will increase the price
2 by \$1,500 total and will impact the vehicle’s range.⁶

3 30. For a rear-wheel drive Model 3 version—the base version of the Model 3—with
4 18” Aero Wheels, the listed range is 272 miles, with a 140-mph top speed, and 5.8 second
5 acceleration from 0-60 mph, as indicated below:⁷

The screenshot displays the Tesla website's configuration interface for the Model 3. On the left, a grey Tesla Model 3 is shown from a front-three-quarter view. The Tesla logo is in the top left corner. On the right, the 'Model 3' title is followed by 'Est. Delivery: Jul - Aug 2023' and 'Delivery ZIP Code: 37929'. Below this, there are two tabs: 'Purchase Price' and 'Potential Savings*'. Performance metrics are listed: '272 mi Range (EPA est.)', '140 mph Top Speed', and '5.8 sec 0-60 mph'. Under 'Rear-Wheel Drive', the 'Model 3' option is selected with a price of '\$40,240'. Below that, 'Dual Motor All-Wheel Drive' options are shown: 'Model 3 Long Range' at '\$47,240' and 'Model 3 Performance' at '\$53,240'. A note at the bottom states: 'All prices are shown without potential incentives or gas savings of \$12,300. Learn More'. A 'Feature Details' button is at the bottom right. At the bottom of the screenshot, a price bar shows '\$40,240 Vehicle Price' and '\$27,940 After Potential Savings'.

18 (continued on next page)

26 ⁶ <https://www.tesla.com/model3/design#overview> (last visited July 28, 2023).

27 ⁷ *Id.*

31. For a Dual Motor All-Wheel Drive Model 3 Long Range version with 18” Aero Wheels, the listed range is 333 miles, with a 145-mph top speed, and 4.2 second acceleration from 0-60 mph, as indicated below:⁸

TESLA

Model 3

Est. Delivery: Jul - Aug 2023
Delivery ZIP Code: 37929

Purchase Price Potential Savings*

333 mi 145 mph 4.2 sec
Range (EPA est.) Top Speed 0-60 mph

Rear-Wheel Drive

Model 3 \$40,240

Learn more about Range and Performance

Dual Motor All-Wheel Drive

Model 3 Long Range \$47,240

Model 3 Performance \$53,240

All prices are shown without potential incentives or gas savings of \$12,300. [Learn More](#)

Feature Details

\$47,240 Vehicle Price | \$34,940 After Potential Savings

32. And for a Dual Motor All-Wheel Drive Model 3 Performance version with 18” Aero Wheels, the listed range is 315 miles, with a 162-mph top speed, and 3.1 second acceleration from 0-60 mph, as indicated below:⁹

TESLA

Model 3

Est. Delivery: Jul - Aug 2023
Delivery ZIP Code: 37929

Purchase Price Potential Savings*

315 mi 162 mph 3.1 sec
Range (EPA est.) Top Speed 0-60 mph

Rear-Wheel Drive

Model 3 \$40,240

Learn more about Range and Performance

Dual Motor All-Wheel Drive

Model 3 Long Range \$47,240

Model 3 Performance \$53,240

All prices are shown without potential incentives or gas savings of \$12,300. [Learn More](#)

Feature Details

\$53,240 Vehicle Price | \$40,940 After Potential Savings

Performance Upgrade
Included
• 20" Uberturbine Wheels

⁸ *Id.*

⁹ *Id.*

1 33. When customizing the vehicle, Tesla further notes that selecting a different style
2 of wheel may impact the vehicle’s range.

3 34. Regardless of the method a consumer uses to purchase a Tesla model vehicle—
4 whether by exploring available inventory of vehicles or by custom ordering a vehicle—Tesla
5 advertises the electric vehicle’s range as a key factor of the vehicle.

6 35. And at every turn, Tesla grossly overinflates the vehicle’s range.

7 **Tesla Vehicles Display Real-Time Range Estimates**

8 36. Each of Tesla’s model vehicles comes equipped with a screen displaying
9 navigation, infotainment, vehicle settings, and key vehicle information, including battery charge
10 indicators and range information.

11 37. Tesla vehicles provide range estimates in real-time. The intention is to provide
12 the driver with real-time updates on the electric vehicle battery’s performance, which directly
13 correlates to the range the vehicle can be driven. Accurate range estimates help to ensure that, as
14 the battery drains, the driver knows to pull over at a charging station before the battery drains
15 completely, leaving the driver and occupants stranded. Inaccurate range estimates can, indeed,
16 lead a driver to being stranded, as the battery drains completely—and unexpectedly, based upon
17 inaccurate range information.

18 38. Tesla vehicles provide range estimates in two ways. First, through a meter on the
19 screen that is always displayed. This meter can be toggled to indicate either the electric vehicle
20 battery percentage remaining or the range (measured in miles or kilometers) remaining. Second,
21 through the vehicle’s navigation system, which estimates the range (indicated in battery
22 percentage) remaining, as compared to the set destination. However, if no destination is input
23 into the navigation system, the vehicle will not indicate a range estimate through this latter
24 method.

25 39. Tesla has developed its own proprietary software and algorithms for estimating
26 and updating in real-time the range and battery performance in its vehicles, as displayed through
27 the Tesla system displayed on the screen.

1 **Tesla Informs Consumers That They Should Not Charge Their Vehicle to Full Capacity**

2 40. Following purchase, each Tesla vehicle sets a suggested charge limit—that is, a
3 an upper limit to stop charging the battery. For example, if an 80% limit is set, the battery will
4 continue to charge until it reaches 80% capacity, then will stop charging. This effectively ensures
5 that the battery cannot be fully charged to 100%.

6 41. A consumer can manually override the charge limit. However, Tesla recommends
7 that consumers *not* exceed the suggested charge limit. Tesla specifically suggests that consumers
8 “[c]harge the battery to the appropriate charge limit for your vehicle based on the installed
9 battery.”¹⁰

10 42. Tesla suggests that Tesla owners should charge their vehicle to full 100% capacity
11 only sparingly. In fact, Tesla’s chief executive officer, Elon Musk, suggests that owners should
12 only charge to 90% or 95% when necessary.¹¹

13 43. Setting charge limits directly impacts total range. Tesla’s advertised total range
14 of its vehicles are based on a full charge. However, because Tesla discourages owners from ever
15 charging their vehicles to 100%, it is increasingly difficult—if not impossible—to ever reach
16 that advertised range. For example, setting the vehicle’s charge limit at 80% can reduce the total
17 range by *hundreds* of miles, compared to the advertised range.

18 44. Effectively, based upon Tesla’s suggested charge limits, Tesla vehicles cannot
19 reach the total ranges Tesla advertises.

20 45. Notably, while Tesla openly advertises its total range estimates (which already
21 are exaggerated) to consumers at the point of purchase, it does not indicate to consumers that
22 they can expect to limit the vehicle’s total range by setting charge limits.

23 _____
24 ¹⁰ <https://www.tesla.com/support/range> (last visited July 28, 2023).

25 ¹¹ <https://mashable.com/article/tesla-battery-charge-max#:~:text=Tesla-,Elon%20Musk%20explains%20why%20you%20shouldn't%20charge%20your%20Tesla,up%20to%2090%2D95%25.&text=Electric%20car%20batteries%20should%20not,up%20to%2090%25%20by%20default> (last visited July 28, 2023); *see also*
26 <https://electrek.co/2017/09/01/tesla-battery-expert-recommends-daily-battery-pack-charging>
27 (last visited July 28, 2023).

1 **How Tesla Calculates the Ranges It Advertises**

2 46. Electric vehicle manufacturers are required by the Environmental Protection
3 Agency (“EPA”) to advertise fuel-efficiency information, as indicated in a miles-per-gallon
4 equivalent (“MPGe”) and estimate of the electric vehicle’s total range. The MPGe indication
5 allows consumers to compare the electric vehicle directly with gasoline and diesel vehicles. The
6 estimates of the vehicle’s total range allow consumers to examine how far an electric vehicle can
7 be expected to travel on a full charge, in combined city and highway driving.

8 47. Although the EPA requires that electric vehicle manufacturers advertise the
9 vehicle’s range, the EPA does not dictate precisely how this range is calculated.

10 48. The EPA provides a standardized formula, which converts fuel-economy results
11 from city and highway driving tests to calculate the vehicle’s total range figure. However,
12 electric vehicle manufacturers may conduct their own testing to establish the range estimates for
13 their vehicles. Generally, the only reason an electric vehicle manufacturer would choose to
14 conduct its own testing is to ensure that it generates a more favorable total range estimate.

15 49. Numerous electric vehicle manufacturers, including Ford, Mercedes, and Porsche
16 choose to simply use the EPA’s standardized formula to calculate the range in their electric
17 vehicles. Doing so ensures that the potential range advertised to consumers reflects *conservative*
18 estimates based on real-world driving conditions.¹²

19 50. Tesla, however, does not use the EPA’s standardized formula for any of its
20 vehicles. Instead, Tesla conducts its own testing to calculate the total range for each of its model
21 vehicles, resulting in inflated estimates compared to the ranges drivers actually experience.¹³

22 51. In a recent audit, the EPA reviewed the estimated ranges in six Tesla models since
23 the 2020 model year. Based on the EPA’s testing, Tesla was required to lower the estimated
24 ranges in all six of those model vehicles, because Tesla consistently was overestimating the range

25 _____
26 ¹² <https://www.reuters.com/investigates/special-report/tesla-batteries-range> (last visited July
27 28, 2023).

¹³ *Id.*

1 of its vehicles.¹⁴

2 52. When selling a used vehicle, for example, Tesla owners can go visit
 3 www.fueleconomy.gov to download a Used Vehicle Fuel Economy label by using the provided
 4 online tool, which employs established EPA standardized formulae for estimating electric
 5 vehicle range.¹⁵

6 53. An example of a fuel economy label developed by using this tool for a 2020 Tesla
 7 Model Y Performance vehicle is included below:

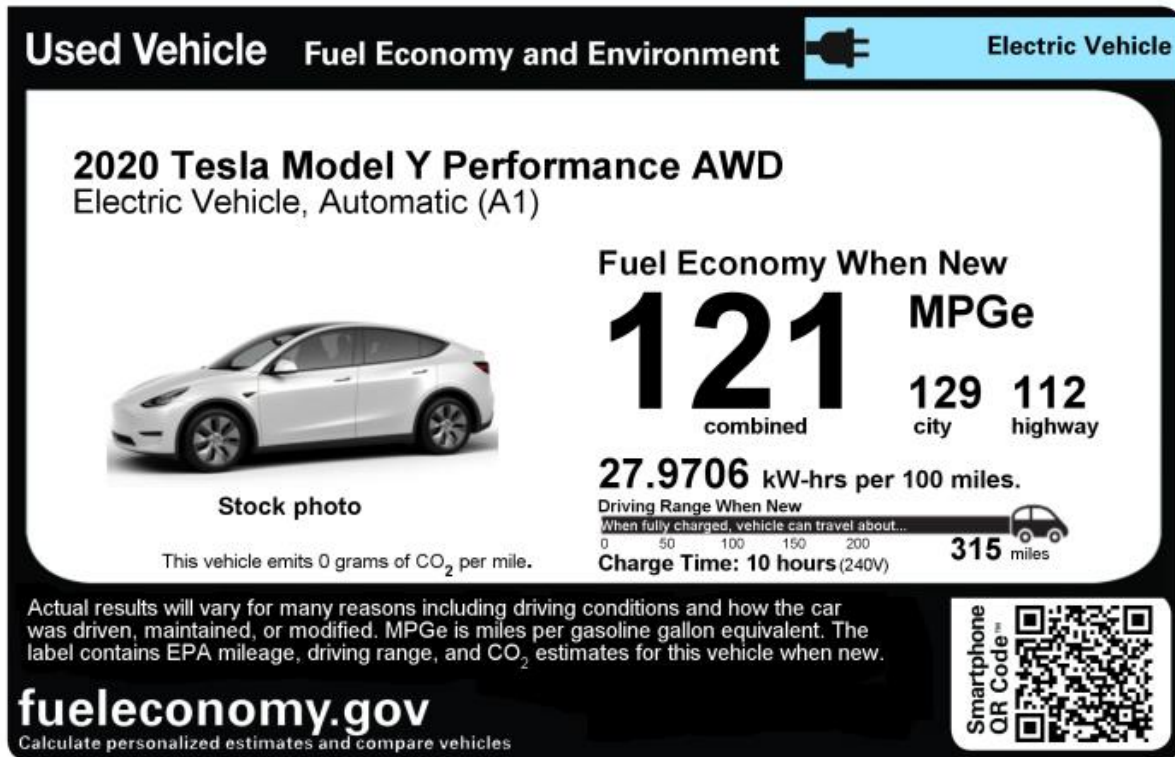

18 54. Notably, this label describes the estimated electric vehicle range in these terms:
 19 “When fully charged, vehicle can travel about . . .” Describing the estimated range in this manner
 20 makes clear that the advertised range is available *only* at full 100% battery charge.

21 55. When purchasing a vehicle directly from Tesla, Tesla does *not* describe the
 22 estimated vehicle range in these terms or with equivalent warnings.

23 ¹⁴ *Id.*

24 ¹⁵ <https://www.fueleconomy.gov/feg/UsedCarLabel.jsp> (last visited July 28, 2023).

1 56. Further, the label makes clear that “[a]ctual results will vary for many reasons
2 including driving conditions.” For a used vehicle, it also indicates that range may be impacted
3 by “how the car was driven, maintained, or modified.”

4 57. When purchasing a vehicle directly from Tesla, Tesla does *not* describe the
5 estimated vehicle range in these terms or with equivalent warnings.

6 **Tesla Exaggerates the Ranges of Its Vehicles**

7 58. For years, Tesla has been exaggerating the range of its vehicles—that is, the
8 vehicle’s potential driving distance before requiring the driver to recharge the electric vehicle’s
9 battery.¹⁶

10 59. On July 27, 2023, Reuters published a special report, by Steve Stecklow and
11 Norihiko Shirouzu, detailing Tesla’s tactics of over-exaggerating the ranges of its vehicles (the
12 “Reuters report”).¹⁷

13 60. Based upon information from those familiar with Tesla’s early vehicle software
14 designs, the Reuters report explains that Tesla developed algorithms for estimating the range of
15 its electric vehicles, which would display to drivers “rosy” projections for the distance the
16 vehicle could travel on a full battery.¹⁸

17 61. However, once the battery reached 50% capacity, the algorithm would change
18 and begin showing the driver more realistic projections. This would cause the estimated range
19 of the vehicle to fluctuate drastically from that point.¹⁹

20 62. The decision to include these algorithms to present inflated range estimates came
21 directly from Tesla’s chief executive officer, Elon Musk.²⁰ As the Reuters report indicates, “Elon
22 [and Tesla] wanted to show good range numbers when fully charged When you buy a car
23

24 _____
25 ¹⁶ *Id.*

26 ¹⁷ *Id.*

27 ¹⁸ *Id.*

¹⁹ *Id.*

²⁰ *Id.*

1 off the lot seeing 350-mile, 400-mile range, it makes you feel good.”²¹

2 63. Tesla’s tactics to inflate the range estimates for its vehicles has continued.
3 Recently, South Korean regulators fined Tesla for false advertising the ranges of its vehicles.
4 Specifically, the Korea Fair Trade Commission found that Tesla exaggerated the “driving ranges
5 of its cars on a single charge, their fuel cost-effectiveness compared to gasoline vehicles as well
6 as the performance of its Superchargers.”²² It was determined that, for example, the range of
7 Tesla electric vehicles could drop by up to 50.5% in cold weather, as compared to the advertised
8 ranges.²³

9 64. Other recent studies determined that various Tesla models averaged 26% below
10 their advertised ranges.²⁴

11 65. Beginning with 2020 model year vehicles, the EPA has required Tesla to reduce
12 the range estimates Tesla advertised to consumers.²⁵

13 66. Various factors can impact a Tesla model vehicle’s range, including: high driving
14 speeds, cold temperatures, “stop-and-go” traffic, driving uphill, and inclement weather (such as
15 rain, snow, or headwinds).²⁶

16 67. However, recent testing has found that Tesla vehicles deliver actual ranges well
17 below their advertised ranges. In 2022 and 2023, Recurrent, an electric vehicle analytics
18 company, surveyed more than 8,000 Tesla model vehicles. The results of this survey determined
19 that Tesla vehicles fail to accurately reflect how various factors or conditions will negatively
20 impact the vehicle’s range.²⁷

21 _____
22 ²¹ *Id.*

23 ²² See <https://www.reuters.com/markets/commodities/south-korea-fines-tesla-22-mln-exaggerating-driving-range-evs-2023-01-03> (last visited July 28, 2023).

24 ²³ *Id.*

25 ²⁴ <https://www.reuters.com/investigates/special-report/tesla-batteries-range> (last visited July 28, 2023).

26 ²⁵ *Id.*

27 ²⁶ <https://www.tesla.com/support/range> (last visited July 28, 2023).

²⁷ <https://www.reuters.com/investigates/special-report/tesla-batteries-range> (last visited July 28, 2023).

1 68. For example, while Tesla itself explains that temperature can negatively impact a
2 vehicle’s range, Recurrent’s testing determined that Tesla model vehicles still overwhelmingly
3 calculated that they could still deliver nearly the advertised full range, regardless of external
4 factors—with Tesla vehicles calculating that they could travel more than 90% of their advertised
5 range. Put simply, Tesla vehicles failed to accurately account for external factors impacting
6 battery performance and vehicle range, leading to a gross overestimate of the vehicle’s range.²⁸

7 69. Other electric vehicle manufacturers do not overestimate the range of their
8 vehicles to the same extent. For example, Recurrent tested the Ford Mustang Mach-E, the
9 Chevrolet Bolt, and the Hyundai Kona—all electric vehicles and direct competitors to Tesla
10 model vehicles—and found their estimated ranges to be more accurate. In fact, the Hyundai
11 Kona generally underestimated the range the vehicle could travel before requiring a recharge.²⁹

12 70. Tesla, however, chose to “take[] a different path from most other automakers.”
13 While other electric vehicle manufacturers advertise *conservative* range estimates, Tesla
14 consistently advertised overly *aggressive* estimates of the range within its vehicles.³⁰

15 71. Another recent study, which compared 21 different brands of electric vehicles,
16 analyzed whether electric vehicles could deliver the advertised range in actual use.³¹ The study
17 found that three Tesla model vehicles posted the *worst* performances, falling short of their
18 advertised ranges by 26%, on average.³²

19 72. In yet another recent study, *all* Tesla vehicles failed to meet their advertised range
20 estimates based on real-world driving tests. Edmunds.com, an automotive review website, tested
21

22 ²⁸ *Id.*

23 ²⁹ *Id.*

24 ³⁰ *Id.*

25 ³¹ Gregory Pannone & Dave VanderWerp, *Comparison of On-Road Highway Fuel Economy*
26 *and All-Electric Range to Label Values: Are the Current Label Procedures Appropriate for*
27 *Battery Electric Vehicles?*, SAE Technical Paper (2023), available at
<https://www.sae.org/publications/technical-papers/content/2023-01-0349> (last visited July 28,
2023).

³² *Id.*; see also <https://www.reuters.com/investigates/special-report/tesla-batteries-range> (last
visited July 28, 2023).

1 various electric vehicle manufacturers’ range estimate claims. As recently as July 2023, no Tesla
2 vehicle was able to meet its advertised range estimate.³³

3 **Tesla Has Already Admitted It Falsely Advertised and Exaggerated Range Estimates**

4 73. South Korean regulators have already fined Tesla for falsely advertising the total
5 ranges of its vehicles in South Korea.

6 74. The Korea Fair Trade Commission determined that Tesla failed to inform
7 consumers that the vehicle’s total range could be negatively impacted by various factors, and
8 that the range would likely be lower in normal driving conditions.³⁴

9 75. South Korean regulators required Tesla to publicly admit that it had misled
10 consumers regarding its range estimates for Tesla vehicles. In a June 19, 2023 statement, Tesla
11 executives, including Elon Musk, acknowledged that Tesla had employed “false/exaggerated
12 advertising.”³⁵

13 **Tesla Owners Have Noticed that the Ranges in Their Vehicles Are Not as Advertised**

14 76. As Tesla owners used their vehicles, they soon realized that their vehicles did not
15 perform as expected or advertised because the electric vehicles were consistently incapable or
16 driving at the advertised ranges.

17 77. As Reuters reported, one Tesla Model 3 owner was required to stop to charge his
18 electric vehicle numerous times during a road trip, and he noticed that he was only receiving
19 about 150 miles of range when his electric vehicle battery was fully charged, which was well
20 below the advertised range.³⁶

21 78. This understandably caused great concern among Tesla owners, who were
22 worried that the batteries in their vehicles were defective or failing. Based on these concerns,
23

24 ³³ [https://www.edmunds.com/car-news/electric-car-range-and-consumption-epa-vs-](https://www.edmunds.com/car-news/electric-car-range-and-consumption-epa-vs-edmunds.html)
25 [edmunds.html](https://www.edmunds.com/car-news/electric-car-range-and-consumption-epa-vs-edmunds.html) (last visited July 28, 2023).

26 ³⁴ <https://www.reuters.com/investigates/special-report/tesla-batteries-range> (last visited July
27 28, 2023).

³⁵ *Id.*

³⁶ *Id.*

1 consumers began contacting Tesla to seek assistance and confirmation that the batteries in their
2 electric vehicles were not failing.

3 79. Tesla provides a mobile app to all Tesla owners, which links to each owner’s
4 Tesla electric vehicle. The application allows the owner to control the vehicle, view information
5 about the vehicle, and, if necessary, to schedule a service appointment for diagnostics or repair
6 with a Tesla dealership or representative.

7 80. Based on their concerns regarding potential issues with the batteries in their Tesla
8 electric vehicles—because the range was consistently falling short of advertised estimates—
9 consumers used their Tesla mobile app to register complaints or schedule service appointments
10 for a representative to check their vehicle.

11 **Tesla Created a “Diversion” Team to Handle Complaints Related to Vehicle Range**

12 81. Facing mounting complaints and appointments regarding range concerns, Tesla
13 created a special “team” that was tasked specifically with handling these complaints.

14 82. However, Tesla’s reasoning for creating this team was not to assuage Tesla
15 owners’ concerns. Rather, Tesla created this team to divert customers away from service
16 appointments, in an effort to save Tesla time and money in handling service appointments.

17 83. This “Diversion Team” was created solely to handle complaints and service
18 appointments regarding concerns over vehicle range. Members of the Diversion Team were
19 tasked with “diverting” customers away from service appointments and would simply cancel any
20 service appointment that was nominally related to concerns over a vehicle’s range.³⁷

21 84. Rather than allowing a customer to attend a service appointment regarding their
22 range concerns, the Diversion Team would run remote diagnostic on a complaining customer’s
23 vehicle. The Diversion Team would call the customer and explain that Tesla’s advertised range
24 was a “prediction,” rather than an actual measurement. The team was trained to explain to
25 customers that the electric vehicle’s batteries naturally degrade over time—and, thus, the

26
27 ³⁷ *Id.*

1 vehicle’s range will be reduced.³⁸ Upon information and belief, the team did not explain to
2 customers that Tesla’s method for calculating the originally advertised range was aggressive, or
3 that the software algorithm displaying the updated vehicle range in real-time did not accurately
4 reflect the range at higher battery percentages.

5 85. Notably, when running diagnostics, if the diagnostic indicated some other issue
6 with a customer’s vehicle, the Diversion Team was instructed *not* to inform the customer and
7 instead was required to simply close the customer’s case.³⁹

8 86. Tesla also updated the Tesla mobile app to disallow any customer who was
9 voicing concern over their vehicle’s range from scheduling a service appointment. Instead, the
10 app would only allow them to ask that a Tesla representative contact them regarding their
11 concern. All such complaints and concerns were routed directly to the Diversion Team.⁴⁰

12 87. Following Tesla mobile app update, any time a customer complained or voiced
13 concerns about their Tesla vehicle’s range, the app would simply provide an explanation that the
14 vehicle’s range “depends on many factors, particularly your environment and personal driving
15 habits.” However, the app also would note that the “[d]isplayed range in your Tesla is adapted
16 based on fixed EPA test data, not your personal driving patterns,” as indicated below.⁴¹

17
18
19
20 (continued on next page)

21
22
23
24
25 ³⁸ *Id.*

26 ³⁹ *Id.*

27 ⁴⁰ *Id.*

⁴¹ <https://www.reuters.com/investigates/special-report/tesla-batteries-range> (last visited July 28, 2023).

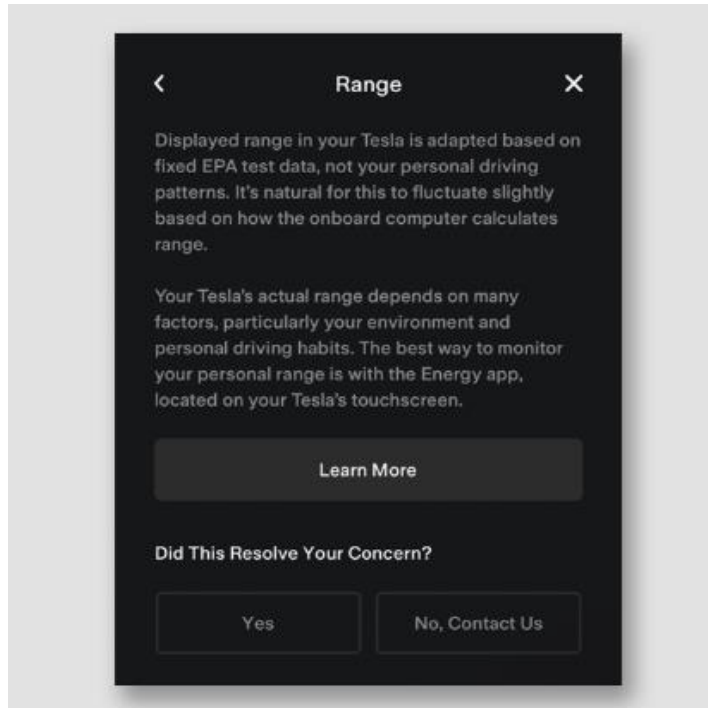

88. Complaints and concerns regarding Tesla vehicle range continued to steadily increase. At one point, the Diversion Team was handling 2,000 complaints a week. Customers voiced understandable frustration over the fact that they were not allowed to book service appointments regarding their concerns over their vehicles' range.⁴²

89. As complaints continued to increase, the Diversion Team was expected to handle and close 750 cases per week. Diversion Team members were told to call complaining customers just once. If the customer did not answer this single call, the Diversion Team would close the customer's case as being "nonresponsive." If a customer did answer, the Diversion Team was required to handle the call as quickly as possible—in five minutes or less.⁴³ This did not afford adequate time to alleviate customers' concerns.

90. By late 2022, the Diversion Team stopped running remote diagnostics on complaining customers' vehicles altogether.⁴⁴

⁴² *Id.*

⁴³ *Id.*

⁴⁴ *Id.*

1 91. Essentially, by late 2022, if a Tesla owner complained or voiced concern over the
2 range of their Tesla electric vehicle, Tesla would not even check to confirm if, in fact, anything
3 was indeed wrong with the electric vehicle or its battery. Put simply, Tesla ensured that its
4 representatives told thousands upon thousands of customers that there was nothing wrong with
5 their electric vehicles without ever first confirming if that was actually the case.⁴⁵

6 92. The Diversion Team was created to alleviate pressure on Tesla, which was
7 mounting due to its inability to deliver its exaggerated advertised vehicle ranges, rather than
8 actually help customers or alleviate their concerns.

9 **Tesla's Conduct Violates Its Warranties**

10 93. Tesla warrants all its electric vehicles.

11 94. New Tesla model vehicles are covered by Tesla's New Vehicle Limited
12 Warranty, which includes Tesla's Basic Vehicle Limited Warranty, Tesla's Supplemental
13 Restraint System Limited Warranty, and Tesla's Battery and Drive Unit Limited Warranty.^{46, 47}

14 95. Tesla's Basic Vehicle Limited Warranty "covers the repair or replacement
15 necessary to correct defects in the materials or workmanship of any parts manufactured or
16 supplied by Tesla under normal use for a period of 4 years or 50,000 miles (80,000 km),
17 whichever comes first."⁴⁸

18 96. Tesla's Battery and Drive Unit Limited Warranty "covers the repair or
19 replacement of any malfunctioning or defective Battery or Drive Unit." If a warranty repair is
20 required, "Tesla will repair the [Battery or Drive] unit, or replace it." "[W]hen replacing a
21 Battery, Tesla will ensure that the energy capacity of the replacement Battery is at least equal to
22 that of the original Battery before the failure occurred." For Tesla Model S and Model X vehicles,
23

24 ⁴⁵ *Id.*

25 ⁴⁶ <https://www.tesla.com/support/vehicle-warranty> (last visited July 28, 2023).

26 ⁴⁷ Tesla's Supplemental Restraint System Limited Warranty addresses defects in the vehicle's
27 seat belts or air bag system, and thus is not relevant to Plaintiffs' claims here.

⁴⁸ <https://www.tesla.com/sites/default/files/downloads/tesla-new-vehicle-limited-warranty-en-us.pdf> (last visited July 28, 2023).

1 the Battery and Drive Unit Limited Warranty offers coverage for “8 years or 150,000 miles
2 (240,000 km), whichever comes first, with minimum 70% retention of Battery capacity over the
3 warranty period.” For Tesla Model 3 Rear-Wheel Drive vehicles, the Battery and Drive Unit
4 Limited Warranty offers coverage for “8 years or 100,000 miles (160,000 km), whichever comes
5 first, with minimum 70% retention of Battery capacity over the warranty period.” For Tesla
6 Model 3 Long Range, Model 3 Performance, Model Y All-Wheel Drive, Model Y Long Range,
7 and Model Y Performance vehicles, the Battery and Drive Unit Limited Warranty offers
8 coverage for “8 years or 120,000 miles (192,000 km), whichever comes first, with minimum
9 70% retention of Battery capacity over the warranty period.” The “measurement method used to
10 determine Battery capacity . . . [is] at the sole discretion of Tesla.”⁴⁹

11 97. Notably, the Battery and Drive Unit Limited Warranty explains that “the vehicle’s
12 range estimates are an imperfect measure of Battery capacity because they are affected by
13 additional factors separate from Battery capacity.”⁵⁰

14 98. Tesla also offers a Used Vehicle Limited Warranty on all used vehicles purchased
15 through Tesla, which offers coverage for “the remainder of 4 years or 50,000 miles left on the
16 Basic Vehicle Limited Warranty,” and after its expiration, “provides additional coverage of 1
17 year or 10,000 miles.”⁵¹

18 99. Despite offering coverage under the Battery and Drive Unit Limited Warranty,
19 including coverage for any “malfunctioning battery,” Tesla refused to provide such coverage to
20 Tesla owners who complained or voiced concerns regarding their electric vehicles’ range.

21 100. Normally, in order to receive warranty coverage, a Tesla owner would schedule
22 a service appointment to determine whether the battery in their electric vehicle was
23 “malfunctioning.” If the battery was determined to be malfunctioning, under the Battery and
24

25 ⁴⁹ *Id.*; <https://www.tesla.com/support/vehicle-warranty> (last visited July 28, 2023).

26 ⁵⁰ <https://www.tesla.com/sites/default/files/downloads/tesla-new-vehicle-limited-warranty-en-us.pdf> (last visited July 28, 2023).

27 ⁵¹ <https://www.tesla.com/support/vehicle-warranty> (last visited July 28, 2023).

1 Drive Unit Limited Warranty, Tesla would be required to offer a repair or replacement.

2 101. However, as explained above, Tesla established a Diversion Team that was
3 specifically tasked with canceling such service appointments. This ensured that customers' Tesla
4 vehicles could not be reviewed to determine whether their range complaints arose, in fact, from
5 a malfunctioning battery. This effectively ensured that Tesla would not be required to potentially
6 offer more warranty repair or replacement coverages.

7 102. Tesla's conduct, effectuated through the Diversion Team, violated and breached
8 its warranties.

9 **Tesla Knew That Its Advertised Range Estimates Exceeded the Actual Range of Its Vehicles**

10 103. Tesla was aware that its advertised electric vehicle ranges were exaggerated and
11 exceeded the actual range of the vehicle when driven in real-world driving conditions. Tesla,
12 which employs its own method for calculating the range of its electric vehicles, was aware that
13 this method of calculation produced aggressive and exaggerated range estimates.

14 104. Further, Tesla was aware that various factors impacted the electric vehicle's
15 range. Tesla understood that these factors were likely to occur in real-world driving conditions.
16 For example, Tesla stated in its Battery and Drive Unit Limited Warranty that "the vehicle's
17 range estimates are an imperfect measure of Battery capacity because they are affected by
18 additional factors separate from Battery capacity." Thus, Tesla was fully aware that its advertised
19 range estimates were an "imperfect measure" and that its electric vehicles' ranges would vary
20 and be impacted by normal driving conditions.

21 105. Nevertheless, despite knowing this, Tesla did not inform consumers of this
22 information when advertising their electric vehicle range estimates. For example, Tesla could
23 have warned potential purchasers that cold weather would drastically lower the electric vehicle's
24 range, but Tesla did not issue such a warning, instead only advertising an exaggerated range
25 estimate.

26 106. Tesla also was aware that its advertised range estimates were based on driving
27 the electric vehicle with a full 100% charge of the electric vehicle battery. However, because

1 Tesla suggests to customers that they establish a charge limit on their vehicles well-below full
2 capacity, Tesla was aware that, in reality, customers would be unable to ever actually experience
3 the full advertised range.

4 107. Moreover, Tesla was aware that its software algorithms for displaying the vehicle
5 range in real-time to Tesla electric vehicle owners provided exaggerated, “rosy” projections—
6 particularly at higher percentages. Tesla understood that these algorithms did not accurately
7 reflect the actual range of the electric vehicle, again exaggerating the range.

8 108. At the latest, Tesla was aware that its advertised range estimates exceeded the
9 vehicle’s actual capabilities under real-world driving and charging conditions when Tesla
10 established a Diversion Team to summarily handle, divert, and close customer complaints and
11 concerns regarding vehicle range issues.

12 109. Tesla knew, or at the very least should have known, that the actual range of each
13 of its model vehicles was lower than the advertised estimated range before Tesla advertised such
14 ranges.

15 **Had Tesla Honestly Advertised Its Vehicle Ranges, Consumers Would Have Acted Differently**

16 110. Had Tesla honestly advertised its electric vehicle ranges, consumers either would
17 not have purchased Tesla model vehicles, or else would have paid substantially less for them.

18 111. Tesla, based on its superior knowledge, could have and should have warned
19 customers that its range estimates were based just that—estimates and hopeful projections that
20 did not reflect regular conditions.

21 112. Tesla should have warned potential purchasers that the ranges of Tesla model
22 vehicles could be negatively impacted by various driving and environmental factors that were
23 likely to exist; but Tesla did not.

24 113. Tesla should have warned potential purchasers that the ranges of Tesla model
25 vehicles were estimated based on full 100% battery charge, but that Tesla suggested that its
26 model vehicles not be charged to full 100% battery charge on a regular basis.

27 114. Tesla should have warned potential purchasers that the ranges of Tesla model

1 vehicles were not estimated based on EPA standardized formulae—despite Tesla advertising the
2 range estimates as “EPA estimates”—but instead based on Tesla’s own proprietary method for
3 calculating range, which allowed for a more aggressive estimate of total electric vehicle range.

4 115. In fact, Tesla could have described the estimated range of its electric vehicles in
5 terms similar to those included on fueleconomy.gov fuel economy labels, as described above,
6 including but not limited to explaining that the advertised range is based on “[w]hen [the vehicle
7 is] fully charged” or by warning consumers that the advertised range “will vary for many reasons
8 including driving conditions.” Tesla did not do so.

9 116. Had Tesla revealed any of this information to potential purchasers at the time of
10 purchase, by issuing a warning or addendum attached to its advertised estimated vehicle ranges,
11 Plaintiffs and Class Members would have either not purchased Tesla model vehicles or else
12 would have paid substantially less for them.

13 117. Tesla’s conduct in false advertising its estimated vehicle ranges harmed Plaintiffs
14 and Class Members at the point of sale.

15 **PLAINTIFFS’ ALLEGATIONS**

16 **Plaintiff James Porter**

17 118. Plaintiff James Porter is a resident of Petaluma, Sonoma County, California.
18 Plaintiff Porter ordered a 2022 Tesla Model Y Performance vehicle in March 2022. He took
19 delivery of the vehicle in June 2022 from the Tesla dealership in Vallejo, California. Plaintiff
20 Porter purchased his vehicle for approximately \$72,000.

21 119. Plaintiff Porter originally went to the Tesla dealership in Vallejo, California to
22 test drive a Tesla electric vehicle in March 2022. After test driving one of the vehicles, he spoke
23 with a Tesla sales representative at the dealership, discussing various features of the vehicle,
24 including its range. However, at no point did the Tesla representative warn or explain to Plaintiff
25 Perez that the advertised range did not account for normal driving conditions or that it was
26 exaggerated.

27 120. After returning home from the Tesla dealership, Plaintiff Porter went to Tesla’s

1 website and custom ordered a Tesla Model Y Performance vehicle. As Plaintiff Porter selected
2 the features and attributes of his vehicle, at no point did Tesla warn or explain to Plaintiff Porter
3 that the advertised range did not account for normal driving conditions or that it was exaggerated.

4 121. Plaintiff Porter’s vehicle came with all Tesla applicable warranties, including
5 Tesla’s New Vehicle Limited Warranty, Basic Vehicle Limited Warranty, and Battery and Drive
6 Unit Limited Warranty.

7 122. After taking delivery of his Tesla vehicle in June 2022, Plaintiff Porter fully
8 charged his vehicle to 100% battery charge and took a 2-hour trip to visit family, approximately
9 92 miles away. When he arrived at his destination, Plaintiff Porter noticed that the vehicle was
10 left with approximately 40% charge.

11 123. Plaintiff Porter’s electric vehicle should have had an advertised range of
12 approximately 303 miles, based upon a full 100% charge. Thus, following Plaintiff Porter’s trip,
13 his vehicle lost approximately 182 miles of range—despite only driving 92 miles.

14 124. Shortly thereafter, Plaintiff Porter called Tesla to voice concerns over his
15 vehicle’s range, and Tesla made an appointment to review his vehicle. However, before he could
16 bring his vehicle to the scheduled service appointment, a Tesla representative reached out to
17 Plaintiff Porter and canceled the appointment.

18 125. Plaintiff Porter voiced his concerns to the Tesla representative, complaining that
19 he was not receiving the advertised range in his vehicle. The Tesla representative explained that
20 the range advertised by Tesla was based on a full 100% battery charge, without use of any other
21 electronics in the vehicle (including, for example, use of air conditioning, use of the radio, etc.)
22 and without accounting for weather, headwinds, temperature, traffic, amount of passengers, and
23 other driving conditions. The Tesla representative explained that it was normal and expected that
24 the Tesla vehicle’s range would drop below the advertised range with normal driving conditions
25 and use of other vehicle features. The Tesla representative claimed that there was nothing wrong
26 with the range Plaintiff Porter was experiencing in his vehicle, and the representative canceled
27 the service appointment to review the vehicle and confirm whether the vehicle or battery was, in

1 fact, malfunctioning.

2 126. At no point when Plaintiff Porter was custom ordering his vehicle did Tesla warn
3 or explain that the advertised range required the vehicle to be fully charged to 100% battery
4 capacity, required the driver not to use other vehicle features (including other electronics), did
5 not account for normal, expected driving conditions, or that it was exaggerated. Further, at no
6 point when speaking with Tesla representatives, did Tesla representatives warn or explain that
7 the advertised range required the vehicle to be fully charged to 100% battery capacity, required
8 the driver not to use other vehicle features (including other electronics), did not account for
9 normal, expected driving conditions, or that it was exaggerated.

10 127. The electric vehicle's range was one of the most important factors Plaintiff Porter
11 considered when choosing to purchase his Tesla vehicle.

12 128. Had Tesla truthfully revealed that the advertised range was exaggerated and not
13 based on normal driving conditions, Plaintiff Porter would not have purchased his Tesla vehicle,
14 or else would have paid substantially less for it.

15 129. Plaintiff Porter would consider buying another Tesla vehicle in the future if Tesla
16 were ordered to truthfully reveal the actual range of the vehicle, based on normal driving
17 conditions.

18 **Plaintiff Bryan Perez**

19 130. Plaintiff Bryan Perez is a resident of Lancaster, Los Angeles County, California.
20 Plaintiff Porter ordered a 2022 Tesla Model 3 Long Range vehicle in February 2022. He took
21 delivery of the vehicle in March 2022. Plaintiff Perez purchased his vehicle for approximately
22 \$60,128.86.

23 131. Plaintiff Perez went to Tesla's website and custom ordered a Tesla Model 3 Long
24 Range vehicle. As Plaintiff Perez selected the features and attributes of his vehicle, at no point
25 did Tesla warn or explain to Plaintiff Perez that the advertised range did not account for normal
26 driving conditions or that it was exaggerated.

27 132. Shortly after custom ordering his Tesla vehicle, Plaintiff Perez scheduled a test

1 drive at a local Tesla dealership to confirm whether he did, in fact, wish to purchase a Tesla
2 vehicle. After test driving one of the vehicles, he spoke with a Tesla sales representative at the
3 dealership, discussing various features of the vehicle, including its range. However, at no point
4 did the Tesla representative warn or explain to Plaintiff Perez that the advertised range did not
5 account for normal driving conditions or that it was exaggerated.

6 133. Plaintiff Perez's vehicle came with all Tesla applicable warranties, including
7 Tesla's New Vehicle Limited Warranty, Basic Vehicle Limited Warranty, and Battery and Drive
8 Unit Limited Warranty.

9 134. After receiving his Tesla vehicle, Plaintiff Perez fully charged his vehicle to
10 100% battery charge and took an approximately 90-mile trip to visit his parents. After returning
11 home from the approximately 180-mile round trip, he noticed that his vehicle showed that it had
12 roughly 10-15% charge remaining.

13 135. Plaintiff Perez's electric vehicle should have had an advertised range of
14 approximately 333 miles, based upon a full 100% charge. Thus, following Plaintiff Perez's trip,
15 his vehicle lost approximately 283 miles of range—despite only driving approximately 180 miles
16 round trip.

17 136. Plaintiff Perez called Tesla to voice concerns over his vehicle's range. A Tesla
18 representative reached out to Plaintiff Perez and performed a mobile diagnostic on his vehicle
19 and its battery, without scheduling a service appointment to review the vehicle and confirm
20 whether the vehicle or battery was, in fact, malfunctioning.

21 137. Plaintiff Perez voiced his concerns to the Tesla representative, complaining that
22 he was not receiving the advertised range in his vehicle. The Tesla representative explained that
23 the range advertised by Tesla was based on a full 100% battery charge, without use of any other
24 electronics in the vehicle (including, for example, use of air conditioning, use of the radio, etc.)
25 and without accounting for weather, headwinds, temperature, traffic, amount of passengers, and
26 other driving conditions. The Tesla representative explained that it was normal and expected that
27 the Tesla vehicle's range would drop below the advertised range with normal driving conditions

1 and use of other vehicle features. The Tesla representative claimed that there was nothing wrong
2 with the range Plaintiff Perez was experiencing in his vehicle.

3 138. At no point when Plaintiff Perez was custom ordering his vehicle did Tesla warn
4 or explain that the advertised range required the vehicle to be fully charged to 100% battery
5 capacity, required the driver not to use other vehicle features (including other electronics), did
6 not account for normal, expected driving conditions, or that it was exaggerated. Further, at no
7 point when speaking with Tesla representatives, did Tesla representatives warn or explain that
8 the advertised range required the vehicle to be fully charged to 100% battery capacity, required
9 the driver not to use other vehicle features (including other electronics), did not account for
10 normal, expected driving conditions, or that it was exaggerated.

11 139. The electric vehicle's range was one of the most important factors Plaintiff Perez
12 considered when choosing to purchase his Tesla vehicle.

13 140. Had Tesla truthfully revealed that the advertised range was exaggerated and not
14 based on normal driving conditions, Plaintiff Perez would not have purchased his Tesla vehicle,
15 or else would have paid substantially less for it.

16 141. Plaintiff Perez would consider buying another Tesla vehicle in the future if Tesla
17 were ordered to truthfully reveal the actual range of the vehicle, based on normal driving
18 conditions.

19 **Plaintiff Dro Esraeili Estepanian**

20 142. Plaintiff Dro Esraeili Estepanian is a resident of Palmdale, Los Angeles County,
21 California. Plaintiff Estepanian ordered a 2022 Tesla Model 3 Long Range vehicle in or around
22 December 2021 or January 2022. He took delivery of the vehicle in July 2022. Plaintiff
23 Estepanian purchased his vehicle for approximately \$62,000.

24 143. Prior to ordering his Tesla vehicle, Plaintiff Estepanian test drove a Tesla electric
25 vehicle at a local Tesla dealership. After test driving one of the vehicles, he spoke with a Tesla
26 sales representative at the dealership, discussing various features of the vehicle, including its
27 range. However, at no point did the Tesla representative warn or explain to Plaintiff Estepanian

1 that the advertised range did not account for normal driving conditions or that it was exaggerated.

2 144. Plaintiff Estepanian went to Tesla’s website and custom ordered a Tesla Model 3
3 Long Range vehicle. As Plaintiff Estepanian selected the features and attributes of his vehicle,
4 at no point did Tesla warn or explain to Plaintiff Estepanian that the advertised range did not
5 account for normal driving conditions or that it was exaggerated.

6 145. Plaintiff Estepanian’s vehicle came with all Tesla applicable warranties,
7 including Tesla’s New Vehicle Limited Warranty, Basic Vehicle Limited Warranty, and Battery
8 and Drive Unit Limited Warranty.

9 146. Plaintiff Estepanian travels 140 to 150 miles round trip for his daily commute,
10 and he routinely charges his vehicle to 90% battery charge (which equates to approximately 299
11 miles), per Tesla’s recommendation. Based on a 90% battery charge (and 299-mile starting
12 range), he typically returns from his approximately 150-mile round trip each day and his Tesla
13 vehicle’s screen displays that approximately 100 to 110 miles of range remain, which equates to
14 roughly 33% battery charge remaining. Thus, Plaintiff Estepanian’s electric vehicle consistently
15 loses approximately 189 miles of range during his daily commute—despite only driving
16 approximately 140 to 150 miles round trip each day.

17 147. Plaintiff Estepanian took his vehicle to a Tesla dealership and service center near
18 where he worked, complaining and voicing concerns over his vehicle’s range. He was told that
19 his vehicle was not covered by any applicable Tesla warranty, and any review or service of the
20 vehicle to determine if the vehicle or battery was malfunctioning would incur a service charge,
21 and he would not be given a loaner vehicle. Plaintiff Estepanian told Tesla representatives that
22 he could not leave the vehicle, because he needed to drive it home. Plaintiff Estepanian left
23 without Tesla reviewing the vehicle to confirm whether the vehicle or battery was, in fact,
24 malfunctioning.

25 148. Some time later, Tesla representatives performed a mobile diagnostic on his
26 vehicle and explained to him that nothing was wrong with the vehicle. The Tesla representative
27 explained that the range advertised by Tesla was based on a full 100% battery charge, without

1 accounting for various factors, such as weather, headwinds, temperature, traffic, amount of
2 passengers, and other driving conditions. The Tesla representative claimed that there was nothing
3 wrong with the range Plaintiff Estepanian was experiencing in his vehicle.

4 149. At no point when Plaintiff Estepanian was custom ordering his vehicle did Tesla
5 warn or explain that the advertised range required the vehicle to be fully charged to 100% battery
6 capacity, required the driver not to use other vehicle features (including other electronics), did
7 not account for normal, expected driving conditions, or that it was exaggerated. Further, at no
8 point when speaking with Tesla representatives, did Tesla representatives warn or explain that
9 the advertised range required the vehicle to be fully charged to 100% battery capacity, required
10 the driver not to use other vehicle features (including other electronics), did not account for
11 normal, expected driving conditions, or that it was exaggerated.

12 150. The electric vehicle's range was one of the most important factors Plaintiff
13 Estepanian considered when choosing to purchase his Tesla vehicle.

14 151. Had Tesla truthfully revealed that the advertised range was exaggerated and not
15 based on normal driving conditions, Plaintiff Estepanian would not have purchased his Tesla
16 vehicle, or else would have paid substantially less for it.

17 152. Plaintiff Estepanian would consider buying another Tesla vehicle in the future if
18 Tesla were ordered to truthfully reveal the actual range of the vehicle, based on normal driving
19 conditions.

20 **CLASS ACTION ALLEGATIONS**

21 153. Plaintiffs bring this suit as a class action on behalf of themselves and on behalf
22 of all others similarly situated pursuant to Federal Rule of Civil Procedure 23. This action
23 satisfies the numerosity, typicality, adequacy, predominance, and superiority requirements of the
24 provisions of Rule 23.

25 154. Plaintiffs seek to represent the following class:

26 All persons in California who purchased a new Tesla Model 3,
27 Model S, Model Y, and Model X vehicle.

1
2 155. Plaintiffs reserve the right to modify or amend the definition of the proposed
3 Class before the Court determines whether certification is appropriate and as the parties engage
4 in discovery.

5 156. **Numerosity:** Members of the Class are so numerous that joinder of all members
6 is impracticable. While the exact number of Class Members remains unknown at this time, upon
7 information and belief, there are thousands of putative Class Members who are generally
8 ascertainable by appropriate discovery.

9 157. **Commonality:** This action involves common questions of law and fact, which
10 predominate over questions affective individual Class Members. These common legal and
11 factual questions include, but are not limited to, the following:

- 12 a. Whether Tesla model vehicles fail to deliver the advertised estimated
13 vehicle range in normal driving conditions;
- 14 b. Whether Tesla exaggerated its advertised estimated vehicle ranges;
- 15 c. Whether Tesla knew that its advertised estimated vehicle ranges were
16 exaggerated and could not be met under normal driving conditions;
- 17 d. When Tesla gained such knowledge;
- 18 e. Whether Tesla designed, manufacture, marketed, advertised, sold, or
19 otherwise placed its model vehicles into the stream of commerce with
20 such knowledge;
- 21 f. Whether Tesla intentionally concealed the fact that its advertised
22 estimated vehicle ranges were exaggerated or otherwise could not be met
23 under normal driving conditions;
- 24 g. Whether Tesla's conduct to divert complaints from Class Members who
25 voiced concerns over their Tesla model vehicle's range violated the terms
26 of Tesla's warranties;
- 27 h. Whether Plaintiffs and Class Members were harmed by the fraud and

1 deceptive practices alleged herein;

2 i. Whether Tesla was unjustly enriched by its deceptive practices; and

3 j. Whether Plaintiffs and the Class are entitled to equitable or injunctive
4 relief.

5 158. **Typicality:** Plaintiffs' claims are typical or those of the other Class Members
6 because, *inter alia*, all Class Members were injured through the common misconduct described
7 above and were subject in the same manner to Tesla's unfair, deceptive, and unlawful conduct.
8 Plaintiffs are advancing the same claims and legal theories on behalf of themselves and all
9 members of the Class.

10 159. **Adequacy of Representation:** Plaintiffs will fairly and adequately represent and
11 protect the interests of the Class in that they have no disabling conflicts of interest that would be
12 antagonistic to those of the other Class Members. Plaintiffs seek no relief that is antagonistic or
13 adverse to the other Class Members, and the infringement of the rights and the damages Plaintiffs
14 have suffered are typical of other Class Members. Plaintiffs have retained counsel experienced
15 in complex consumer class action litigation, and Plaintiffs intend to prosecute this action
16 vigorously.

17 160. **Superiority:** Class litigation is an appropriate method for the fair and efficient
18 adjudication of the claims involved. Class action treatment is superior to all other available
19 methods for the fair and efficient adjudication of the controversy alleged herein; it will permit a
20 large number of Class Members to prosecute their common claims in a single forum
21 simultaneously, efficiently, and without the unnecessary duplication of evidence, effort, and
22 expense that hundreds of individual actions would require. Class action treatment will permit the
23 adjudication of relatively modest claims by certain Class Members, who could not individually
24 afford to litigate a complex claim against large corporate defendants. Further, even for those
25 Class Members who could afford to litigate such a claim, it would still be economically
26 impractical.

27 161. The nature of this action and the nature of laws available to Plaintiffs and the

1 Class make the use of the class action device a particularly efficient and appropriate procedure
2 to afford relief to Plaintiffs and the Class for the wrongs alleged because Tesla would necessarily
3 gain an unconscionable advantage since it would be able to exploit and overwhelm the limited
4 resources of each individual Class Member with superior financial and legal resources; the costs
5 of individual suits could unreasonably consume the amounts that would be recovered; proof of
6 a common course of conduct to which Plaintiffs were exposed is representative of that
7 experienced by the Class and will establish the right of each Class Member to recover on the
8 cause of action alleged; and individual actions would create a risk of inconsistent results and
9 would be unnecessary and duplicative of this litigation.

10 162. The class action is superior to all other available methods for the fair and efficient
11 adjudication of this controversy. Because of the number and nature of common questions of fact
12 and law, multiple separate lawsuits would not serve the interest of judicial economy.

13 163. Notice of a certified class action and of any result or resolution of the litigation
14 can be provided to Class Members by first-class mail, email, or publication, or such other
15 methods of notice as deemed appropriate by the Court.

16 164. Plaintiffs do not anticipate any difficulty in the management of this litigation.

17 **CAUSES OF ACTION**

18 **FIRST CLAIM FOR RELIEF**
19 **BREACH OF EXPRESS WARRANTY**
20 **(By All Plaintiffs on Behalf of the Class)**

21 165. Plaintiffs incorporate by reference all allegations of the preceding paragraphs as
22 though fully set forth herein.

23 166. Tesla provided Plaintiffs and Class Members with Tesla’s New Vehicle Limited
24 Warranty.

25 167. Included in the New Vehicle Limited Warranty, Tesla provided Plaintiffs and
26 Class Members with Tesla’s Basic Vehicle Limited Warranty, which expressly “covers the repair
27 or replacement necessary to correct defects in the materials or workmanship of any parts

1 manufactured or supplied by Tesla under normal use for a period of 4 years or 50,000 miles
2 (80,000 km), whichever comes first.”

3 168. Tesla further provided Plaintiffs and Class Members with Tesla’s Battery and
4 Drive Unit Limited Warranty, which expressly “covers the repair or replacement of any
5 malfunctioning or defective Battery or Drive Unit.” If a warranty repair is required, “Tesla will
6 repair the [Battery or Drive] unit, or replace it.” “[W]hen replacing a Battery, Tesla will ensure
7 that the energy capacity of the replacement Battery is at least equal to that of the original Battery
8 before the failure occurred.” For Tesla Model S and Model X vehicles, the Battery and Drive
9 Unit Limited Warranty offers coverage for “8 years or 150,000 miles (240,000 km), whichever
10 comes first, with minimum 70% retention of Battery capacity over the warranty period.” For
11 Tesla Model 3 Rear-Wheel Drive vehicles, the Battery and Drive Unit Limited Warranty offers
12 coverage for “8 years or 100,000 miles (160,000 km), whichever comes first, with minimum
13 70% retention of Battery capacity over the warranty period.” For Tesla Model 3 Long Range,
14 Model 3 Performance, Model Y All-Wheel Drive, Model Y Long Range, and Model Y
15 Performance vehicles, the Battery and Drive Unit Limited Warranty offers coverage for “8 years
16 or 120,000 miles (192,000 km), whichever comes first, with minimum 70% retention of Battery
17 capacity over the warranty period.”

18 169. Tesla also offers a Used Vehicle Limited Warranty on all used vehicles purchased
19 through Tesla, which offers coverage for “the remainder of 4 years or 50,000 miles left on the
20 Basic Vehicle Limited Warranty,” and after its expiration, “provides additional coverage of 1
21 year or 10,000 miles.”

22 170. The above express warranties became part of the basis of the bargain between
23 Plaintiffs and Class Members and Tesla.

24 171. Plaintiffs presented concerns with their vehicles’ range to Tesla for repairs. Tesla,
25 however, refused to remedy or even address these concerns, instead choosing to divert the claim
26 and dismiss it.

27 172. As explained above, Tesla established a Diversion Team that was specifically

1 tasked with canceling such service appointments. This ensured that customers' Tesla vehicles
2 could not be reviewed to determine whether their range complaints arose, in fact, from a
3 malfunctioning battery. This effectively ensured that Tesla would not be required to potentially
4 offer more warranty repair or replacement coverages. It also effectively rendered the warranties
5 null.

6 173. Plaintiffs and Class Members notified Tesla of the breaches within a reasonable
7 time and/or were not required to do so because affording Tesla a reasonable opportunity to cure
8 its breach of written warranty would have been futile.

9 174. Plaintiffs and Class Members have complied with all obligations under the
10 warranty, or otherwise have been excused from performance of said obligations as a result of
11 Tesla's conduct described herein.

12 175. Plaintiffs and Class Members are entitled to legal and equitable relief against
13 Tesla, including damages, consequential damages, specific performance, attorney fees, costs of
14 suit, and other relief as appropriate.

15 **SECOND CLAIM FOR RELIEF**
16 **BREACH OF IMPLIED WARRANTY**
17 **(By All Plaintiffs on Behalf of the Class)**

18 176. Plaintiffs incorporate by reference all allegations of the preceding paragraphs as
19 though fully set forth herein.

20 177. Tesla provided Plaintiffs and Class Members with an implied warranty that the
21 Tesla vehicles and any parts thereof are merchantable and fit for the ordinary purposes for which
22 they were sold. However, the Tesla vehicles are not fit for their ordinary purpose as electric
23 vehicles because the vehicles fail to deliver adequate range when operated under normal driving
24 conditions.

25 178. Tesla impliedly warranted that the vehicles were of merchantable quality and fit
26 to provide adequate driving range for normal driving conditions.

27 179. Contrary to the applicable implied warranties, the vehicles at the time of sale and

1 thereafter were not fit for their ordinary and intended purpose of providing Plaintiffs and Class
2 Members with reliable vehicles.

3 180. Tesla’s actions, as complained of herein, breached the implied warranty that the
4 Tesla vehicles were of merchantable quality and fit for such use.

5 **THIRD CLAIM FOR RELIEF**
6 **VIOLATIONS OF THE MAGNUSON-MOSS WARRANTY ACT**
7 **15 U.S.C. § 2301, *et seq.***
8 **(By All Plaintiffs on Behalf of the Class)**

9 181. Plaintiffs incorporate by reference all allegations of the preceding paragraphs as
10 though fully set forth herein.

11 182. The Magnuson-Moss Warranty Act (“MMWA”), 15 U.S.C. § 2301, *et seq.*,
12 imposes civil liability on any “warrantor” for failing to comply with any obligation under written
13 and implied warranties. 15 U.S.C. § 2310(d)(1).

14 183. This Court has jurisdiction over this matter under CAFA and can therefore assert
15 alternative jurisdiction over Plaintiffs’ MMWA claims.

16 184. The Tesla vehicles are “consumer products” as defined by 15 U.S.C. § 2301(1).

17 185. Plaintiffs and Class Members are “consumers” as defined by 15 U.S.C. § 2301(3).

18 186. Tesla is a “warrantor” and “supplier” as defined by 15 U.S.C. § 2301(4) and (5).

19 187. As detailed above, Tesla breached its warranty obligations by failing to provide
20 a product that conformed to the promises and affirmations Tesla made about the Tesla vehicles,
21 by failing to truthfully advertise and warrant the range of its vehicles, and by establishing a
22 scheme to divert and systematically cancel customers’ customer complaints, concerns, and
23 service appointments relating to the range of their vehicles, which in turn created a system that
24 prevented the warranties from functioning as intended (and, thus, rendered the warranties null
25 and caused them to fail of their essential purpose).

26 188. Tesla’s breach of warranty deprived Plaintiffs and Class Members of the benefit
27 of their bargain.

1 189. The amount in controversy meets or exceeds the sum or value of \$50,000
2 (exclusive of interest and costs) computed on the basis of all claims to be determined in this suit.

3 190. Tesla has been afforded reasonable opportunity to cure its breaches of warranty.
4 Plaintiffs previously provided reasonable notice to Tesla of their concerns and complaints
5 regarding the range of their vehicles, creating service appointments to address the issues, which
6 Tesla ultimately canceled. Despite this notice, to Plaintiffs' knowledge, Tesla has taken no steps
7 to correct its business practices or cure its breaches.

8 191. Further, pursuant to the provisions of 15 U.S.C. § 2310(e), Plaintiffs, on behalf
9 of themselves and Class Members, sent notice to Tesla on August 2, 2023, to provide it with
10 reasonable opportunity to correct its business practices and cure its breach of warranties under
11 the MMWA.

12 192. In addition, resorting to any sort of informal dispute settlement procedure or
13 affording Tesla another opportunity to cure its breach of warranty is unnecessary and futile. Any
14 remedies available through any informal dispute settlement procedure would be inadequate
15 under the circumstances, as Tesla has repeatedly misrepresented the true quality and nature of its
16 vehicles, has established a scheme to divert and systematically dispose of reasonable concerns
17 and warranty complaints regarding the range of its vehicles, and has indicated no desire to
18 participate in such a process at this time. Any requirement under the MMWA or otherwise that
19 Plaintiffs submit to any informal dispute settlement procedure or otherwise afford Tesla a
20 reasonable opportunity to cure its breaches of warranty is excused and/or has been satisfied.

21 193. As a direct and proximate result of Tesla's warranty breaches, Plaintiffs and Class
22 Members sustained damages and other losses to be determined at trial. Tesla's conduct damaged
23 Plaintiffs and Class Members, who are entitled to recover damages, specific performance, costs,
24 attorneys' fees, and other appropriate relief.

25 **FOURTH CLAIM FOR RELIEF**
26 **VIOLATIONS OF THE SONG-BEVERLY CONSUMER WARRANTY ACT**
27 **Cal. Civ. Code § 1790, *et seq.***
(By All Plaintiffs on Behalf of the Class)

1 194. Plaintiffs incorporates by reference all allegations of the preceding paragraphs as
2 though fully set forth herein.

3 195. Plaintiffs and Class Members are “buyers” as that term is defined in the California
4 Civil Code § 1791(b).

5 196. The Tesla vehicles are “consumer goods” as that term is defined in the California
6 Civil Code § 1791(a).

7 197. At all relevant times, Tesla was the “manufacturer, distributor, warrantor and/or
8 seller” of the Tesla vehicles within the meaning of the California Civil Code § 1791.

9 198. Tesla provided Plaintiffs and Class Members with express warranties that “covers
10 the repair or replacement necessary to correct defects in the materials or workmanship of any
11 parts manufactured or supplied by Tesla under normal use” and “covers the repair or replacement
12 of any malfunctioning or defective Battery or Drive Unit.”

13 199. Plaintiffs presented concerns with their vehicles’ range to Tesla for repairs. Tesla,
14 however, refused to remedy or even address these concerns, instead choosing to divert the claim
15 and dismiss it.

16 200. As explained above, Tesla established a Diversion Team that was specifically
17 tasked with canceling such service appointments. This ensured that customers’ Tesla vehicles
18 could not be reviewed to determine whether their range complaints arose, in fact, from a
19 malfunctioning battery. This effectively ensured that Tesla would not be required to potentially
20 offer more warranty repair or replacement coverages.

21 201. Tesla’s conduct as complained herein breached applicable warranties and
22 violated the Song-Beverly Consumer Warranty Act.

23 **FIFTH CLAIM FOR RELIEF**
24 **FRAUD**
25 **(By All Plaintiffs on Behalf of the Class)**

26 202. Plaintiffs incorporate by reference all allegations of the preceding paragraphs as
27 though fully set forth herein.

1 the average, reasonable consumer would be misled by Tesla’s misleading and deceptive
2 advertisements and statements, which falsely exaggerate the true nature of its vehicles’ range.

3 213. Plaintiffs and Class Members justifiably relied on Tesla’s misrepresentations and
4 omissions and were actually misled and deceived and were induced by Tesla to purchase the
5 vehicles. Had Tesla truthfully advertised the vehicle’s range, Plaintiffs and Class Members
6 would have either not purchased the vehicles, or else would have paid substantially less for them

7 214. As a result of Tesla’s conduct, Plaintiffs and Class Members have been damaged
8 in an amount to be determined at trial.

9 **SEVENTH CLAIM FOR RELIEF**
10 **VIOLATIONS OF THE CALIFORNIA CONSUMER LEGAL REMEDIES ACT**
11 **Cal. Civ. Code § 1750, *et seq.***
(By All Plaintiffs on Behalf of the Class)

12 215. Plaintiffs incorporate by reference all allegations of the preceding paragraphs as
13 though fully set forth herein.

14 216. Tesla is a “person” as that term is defined in California Civil Code § 1761(c).

15 217. Plaintiffs and Class Members are “consumers” as that term is defined in
16 California Civil Code § 1761(d).

17 218. Tesla engaged in unfair and deceptive acts in violation of the California Legal
18 Remedies Act (“CLRA”) by the practices described above, and by knowingly and intentionally
19 misleading Plaintiffs and Class Members in a material way in the process of purchasing the Tesla
20 vehicles by advertising estimated vehicle ranges that were exaggerated or otherwise could not
21 be met under normal driving conditions, without explaining or warning consumers of that fact.

22 These acts and practices violate, at a minimum, the following sections of the CLRA:

23 California Civil Code § 1770(a)(2) Misrepresenting the source,
24 sponsorship, approval or certification of goods or services;

25 California Civil Code § 1770(a)(5) Representing that goods or
26 services have sponsorships, characteristics, uses, benefits or
27 quantities which they do not have, or that a person has a sponsorship,
approval, status, affiliation or connection which he or she does not
have;

1 California Civil Code § 1770(a)(7) Representing that goods or
2 services are of a particular standard, quality, or grade, or that goods
3 are of a particular style or model, if they are of another; and

4 California Civil Code § 1770(a)(9) Advertising goods and services
5 with the intent not to sell them as advertised.

6 219. Tesla's unfair or deceptive acts or practices occurred repeatedly in Tesla's trade
7 or business and were capable of deceiving, and did deceive, a substantial portion of the
8 purchasing public.

9 220. Throughout the relevant period, Tesla knew or should have known that the Tesla
10 vehicles failed to deliver the advertised estimated vehicle range under normal driving conditions.

11 221. Tesla was under a duty to Plaintiffs and Class Members to disclose the true nature
12 of the estimated vehicle range of the Tesla vehicles because:

- 13 a. Tesla was in a superior position to know the true state of facts about the
14 vehicle range of the Tesla vehicles;
- 15 b. Plaintiffs and the Class Members could not reasonably have been
16 expected to learn or discover that the vehicle range was exaggerated and
17 could not be met under normal driving conditions and thus were not in
18 accordance with Tesla's advertisements and representations;
- 19 c. Tesla knew that Plaintiffs and the Class Members could not reasonably
20 have been expected to learn or discover the true state of facts about the
21 vehicle range; and
- 22 d. Tesla actively concealed and failed to disclose the fact that its advertised
23 estimated vehicle ranges were exaggerated or otherwise could not be met
24 under normal driving conditions from Plaintiffs and the Class.

25 222. In exaggerating the true state of facts for the vehicle range at the time of sale,
26 Tesla has knowingly and intentionally misrepresented material facts and breached its duty not to
27 do so.

1 223. Plaintiffs and Class Members considered the Tesla vehicles’ driving range to be
2 an important factor when purchasing their Tesla vehicles. The vehicle’s advertised range is
3 material to the average, reasonable consumer.

4 224. The misrepresented facts concerning the vehicle range are also material because
5 they concern central functions of the electric vehicles (*e.g.*, the distance the vehicle can travel
6 before needing to be recharged).

7 225. Finally, the facts concerning the vehicle range that Tesla exaggerated in its
8 advertisements to customers are also material because they contradict affirmative representations
9 about Tesla vehicle range.

10 226. Had Tesla disclosed the true vehicle range in its advertising, on its website’s
11 listing of Tesla vehicles for sale or the website’s custom order tool, or through its authorized
12 dealerships, Plaintiffs and the Class Members would have learned of the true vehicle range and
13 would have acted differently. Had Plaintiffs and Class Members known about the true state of
14 facts of the vehicle range capabilities of Tesla vehicles, they either would not have purchased
15 the vehicles or else would have paid substantially less for them. Accordingly, Plaintiffs and Class
16 Members overpaid for their Tesla vehicles and did not receive the benefit of their bargain.

17 227. Plaintiffs plausibly would have learned of the true state of facts of the vehicle
18 range if Tesla had accurately represented it through its advertising or to the sales representatives
19 at Tesla dealerships. Plaintiffs and the other Class Members’ injuries were proximately caused
20 by Tesla’s fraudulent and deceptive business practices.

21 228. Pursuant to California Civil Code § 1782(a), Plaintiffs provided Tesla with notice
22 of its violations under the CLRA on August 2, 2023. Therefore, Plaintiffs seek injunctive relief
23 under the CLRA. Plaintiffs reserve their right to amend this Complaint to seek damages under
24 the CLRA, following the period prescribed by California Civil Code § 1782(a).

25 229. Plaintiffs have attached their Declarations of Venue as Collective Exhibit A to
26 this Complaint, establishing that this Action has been properly commenced in this District,
27 because a significant portion of the relevant facts occurred in Sonoma County and other counties

1 in the State of California. *See* Collective Exhibit A.

2 230. Pursuant to California Civil Code § 1780, Plaintiffs seek an order enjoining Tesla
3 from the unlawful practices described above and a declaration that Tesla’s conduct violated the
4 CLRA.

5 231. Plaintiffs, on behalf of themselves and Class Members, seek equitable relief as
6 well as actual and punitive damages and attorneys’ fees and costs.

7 **EIGHTH CLAIM FOR RELIEF**
8 **VIOLATIONS OF THE CALIFORNIA UNFAIR COMPETITION LAW**
9 **Cal. Bus. & Prof. Code § 17200, *et seq.***
10 **(By All Plaintiffs on Behalf of the Class)**

11 232. Plaintiffs incorporate by reference all allegations of the preceding paragraphs as
12 though fully set forth herein.

13 233. The California Unfair Competition Law (“UCL”) prohibits acts of “unfair
14 competition,” including any “unlawful, unfair or fraudulent business act or practice” and “unfair,
15 deceptive, untrue or misleading advertising.” Cal. Bus. & Prof. Code § 17200.

16 234. Tesla has engaged in unfair competition and unfair, unlawful, or fraudulent
17 business practices by the conduct and statements described above, and by knowingly and
18 intentionally misleading Plaintiffs and Class Members about the true nature of the vehicle range
19 (and the costs and diminished value of the Tesla vehicles as a result of Tesla’s conduct). Tesla
20 knew or reasonably should have known about the true nature of the vehicle range throughout the
21 relevant period. Tesla should have disclosed accurate and truthful information concerning the
22 vehicle range in its advertising and through its authorized dealerships. Tesla was in a superior
23 position to know the true facts related to the vehicle range, and Plaintiffs and Class Members
24 could not reasonably be expected to learn or discover the true facts related to the vehicle range.

25 235. These acts and practices have deceived Plaintiffs and are likely to deceive the
26 public. In misrepresenting the vehicle range, Tesla breached its duties to disclose these facts,
27 violated the UCL, and caused injuries to Plaintiffs and Class Members.

236. Plaintiffs and Class Members considered the Tesla vehicles’ driving range to be

1 an important factor when purchasing their Tesla vehicles. The vehicle’s advertised range is
2 material to the average, reasonable consumer.

3 237. The misrepresented facts concerning the vehicle range are also material because
4 they concern central functions of the electric vehicles (*e.g.*, the distance the vehicle can travel
5 before needing to be recharged).

6 238. Had Tesla disclosed the true vehicle range in its advertising, on its website’s
7 listing of Tesla vehicles for sale or the website’s custom order tool, or through its authorized
8 dealerships, Plaintiffs and the Class Members would have learned of the true vehicle range and
9 would have acted differently. Had Plaintiffs and Class Members known about the true state of
10 facts of the vehicle range capabilities of Tesla vehicles, they either would not have purchased
11 the vehicles or else would have paid substantially less for them. Accordingly, Plaintiffs and Class
12 Members overpaid for their Tesla vehicles and did not receive the benefit of their bargain.

13 239. The injuries suffered by Plaintiffs and Class Members are greatly outweighed by
14 any potential countervailing benefit to consumers or to competition, nor are they injuries that
15 Plaintiffs and Class Members should have, or could have, reasonably avoided.

16 240. Tesla’s acts and practices are unlawful because they violate California Civil Code
17 §§ 1668, 1709, 1710, and 1750, *et seq.*, and California Commercial Code § 2313.

18 241. Plaintiffs, on behalf of themselves and Class Members, seek to enjoin further
19 unlawful, unfair and/or fraudulent acts or practices by Tesla, to obtain restitutionary
20 disgorgement of all monies and revenues generated as a result of such practices, and all other
21 relief allowed under California Business & Professions Code § 17200 and under California law.

22 **NINTH CLAIM FOR RELIEF**
23 **VIOLATIONS OF THE CALIFORNIA FALSE ADVERTISING LAW**
24 **Cal. Bus. & Prof. Code § 17500, *et seq.***
25 **(By All Plaintiffs on Behalf of the Class)**

26 242. Plaintiffs incorporate by reference all allegations of the preceding paragraphs as
27 though fully set forth herein.

243. The California False Advertising Law (“FAL”) states: ““It is unlawful for any . .

1 . corporation . . . with intent directly or indirectly to dispose of real or personal property . . . to
2 induce the public to enter into any obligation relating thereto, to make or disseminate or cause
3 to be made or disseminated . . . from this state before the public in any state, in any newspaper
4 or other publication, or any advertising device, . . . or in any other manner or means whatever,
5 including over the Internet, any statement . . . which is untrue or misleading, and which is known,
6 or which by the exercise of reasonable care should be known, to be untrue or misleading.” Cal.
7 Bus. & Prof. Code § 17500.

8 244. Tesla caused to be made or disseminated throughout California and the United
9 States, through advertising, marketing and other publications, statements that were untrue or
10 misleading, and which were known, or which by the exercise of reasonable care should have
11 been known to Tesla, to be untrue and misleading to consumers, including Plaintiffs and Class
12 Members.

13 245. Tesla has violated the FAL because the misrepresentations and omissions
14 regarding the vehicle range in its vehicles as set forth in this Complaint were material and likely
15 to deceive a reasonable consumer.

16 246. Plaintiffs and Class Members considered the Tesla vehicles’ driving range to be
17 an important factor when purchasing their Tesla vehicles. The vehicle’s advertised range is
18 material to the average, reasonable consumer.

19 247. The misrepresented facts concerning the vehicle range are also material because
20 they concern central functions of the electric vehicles (*e.g.*, the distance the vehicle can travel
21 before needing to be recharged).

22 248. Plaintiffs and the other Class Members have suffered an injury in fact, including
23 the losses of money or property, as a result of Tesla’s unfair, unlawful, and/or deceptive
24 practices.

25 249. Had Tesla disclosed the true vehicle range in its advertising, on its website’s
26 listing of Tesla vehicles for sale or the website’s custom order tool, or through its authorized
27 dealerships, Plaintiffs and the Class Members would have learned of the true vehicle range and

1 would have acted differently. Had Plaintiffs and Class Members known about the true state of
2 facts of the vehicle range capabilities of Tesla vehicles, they either would not have purchased
3 the vehicles or else would have paid substantially less for them. Accordingly, Plaintiffs and Class
4 Members overpaid for their Tesla vehicles and did not receive the benefit of their bargain.

5 250. All of the wrongful conduct alleged herein occurred in the conduct of Tesla's
6 business.

7 251. Plaintiffs, on behalf of themselves and Class Members, seek to enjoin further
8 unlawful, unfair and/or fraudulent acts or practices by Tesla, to obtain restitutionary
9 disgorgement of all monies and revenues generated as a result of such practices, and all other
10 relief allowed under California Business & Professions Code § 17200 and under California law.

11 **TENTH CLAIM FOR RELIEF**
12 **UNJUST ENRICHMENT**
13 **(By All Plaintiffs on Behalf of the Class)**

14 252. Plaintiffs incorporate by reference all allegations of the preceding paragraphs as
15 though fully set forth herein.

16 253. Plaintiffs and Class Members conferred a benefit on Tesla by purchasing the
17 Tesla vehicles.

18 254. Tesla had knowledge that this benefit was conferred upon it.

19 255. Because of its wrongful acts and misrepresentations and omissions, Tesla charged
20 a higher price for the vehicles than the vehicles' true value and Tesla obtained money which
21 rightfully belongs to Plaintiffs and Class Members.

22 256. Tesla has been unjustly enriched at the expense of Plaintiffs and Class Members,
23 and its retention of this benefit under the circumstances would be inequitable.

24 257. Plaintiffs seek an order requiring Tesla to make restitution to Plaintiffs and Class
25 Members.

26 **PRAYER FOR RELIEF**

27 WHEREFORE, Plaintiffs, on behalf of themselves and members of the proposed Class,

1 respectfully request that the Court:

- 2 a. Determine that the claims alleged herein may be maintained as a class action
3 under Federal Rule of Civil Procedure 23, and issue an order certifying one or
4 more classes as defined above;
- 5 b. Appoint Plaintiffs as the representatives of the Class and their counsel as Class
6 counsel;
- 7 c. Award all actual, general, special, incidental, statutory, punitive, and
8 consequential damages and restitution to which Plaintiffs and the Class Members
9 are entitled;
- 10 d. Award pre-judgment and post-judgment interest on such monetary relief;
- 11 e. Grant appropriate injunctive and/or declaratory relief, including, without
12 limitation, an order that enjoins Tesla from falsely advertising the estimated
13 ranges of its model vehicles;
- 14 f. Award reasonable attorneys' fees and costs; and
- 15 g. Grant such further relief that this Court deems appropriate.

16 **DEMAND FOR JURY TRIAL**

17 Plaintiffs demand a trial by jury on all issues so triable.

18
19
20 DATED: August 2, 2023

21 */s/ William A. Ladnier* _____
22 Adam A. Edwards*
23 William A. Ladnier (CA Bar No. 330334)
24 Virginia Ann Whitener*
25 **MILBERG COLEMAN BRYSON**
26 **PHILLIPS GROSSMAN, PLLC**
27 800 S. Gay Street, Suite 1100
Knoxville, TN 37929
Tel: (865) 247-0080
Fax: (865) 522-0049
aedwards@milberg.com
wladnier@milberg.com

gwhitener@milberg.com

Mitchell Breit*
**MILBERG COLEMAN BRYSON
PHILLIPS GROSSMAN, PLLC**
405 E. 50th Street
New York, NY 1002
Tel: (347) 668-8445
mbreit@milberg.com

* *Pro hac vice forthcoming*

*Attorneys for Plaintiffs
and the Proposed Class*

1
2
3
4
5
6
7
8
9
10
11
12
13
14
15
16
17
18
19
20
21
22
23
24
25
26
27