



UNITED STATES OFFICE OF PERSONNEL MANAGEMENT

Washington, DC 20415

Merit System Audit
and Compliance

VR-2012

Attorney General of the United States
Department of Justice
Washington, DC 20530

RE: Election of August 16, 2022
(Date)

Alaska
(State)

Dillingham
(Census Area) (County)

Koliganek
(Municipality)

Anton Johnson Village
(Name of Polling Place) Community Building

37-724
(Precinct/Election District)

Dear Attorney General:

Pursuant to Section 8 of the Voting Rights Act of 1965, the undersigned served as U.S. Office of Personnel Management Observers for the election described above. Enclosed is the report for that election, which we certify to be an accurate report of our observations.

Respectfully yours,

Observers:

Name Monica Rodriguez
(Print)

Monica Rodriguez
(Sign)

Name Otilia G. Gomez
(Print)

Otilia G. Gomez
(Sign)

Name _____
(Print)

(Sign)

The Time Observers:

Arrived at Polls 10:40 a.m.

Departed Polls 2:30 p.m.

*Instructions to Observers: Complete this report in **black ink only**. Each team member must sign the coversheet and initial all subsequent pages of the report, including charts, in the lower-left corner.*

1. VOTING STATISTICS

Precinct, if applicable: 37-724

A. Number of Persons Attempting to Vote at the Polls	Total	Alaska Native American	Hispanic	Asian	Black	White	Other
1. Persons voting regular/unchallenged ballot (including unchallenged curbside and emergency ballots) (See Chart A, p. 22)	25	24	Ø	Ø	Ø	1	Ø
2. Persons not permitted to vote or turned away for any reason, including being sent elsewhere (See Charts B, p. 25)	Ø	Ø	Ø	Ø	Ø	Ø	Ø
3. ^{Questioned} Persons voting provisional, challenged, or affidavit ballot (See Charts D, p. 30)	1	1	Ø	Ø	Ø	Ø	Ø
Total of 1, 2, and 3	26 o.s.	25	Ø	Ø	Ø	1	Ø

B. Number of Persons Receiving Any Minority Language Assistance (Cumulative Totals from Chart A1, p. 23. Specify language or dialect; e.g., Navajo, Spanish, Cantonese, Mandarin.)	Language	Yup'ik			
	Total	0			
<input type="checkbox"/> Section 1B is not applicable to this coverage.					

C. Number of Persons Receiving Any Assistance Other than Language Assistance (Cumulative Totals from Chart A2, p. 24)	Total	Alaska Native American	Hispanic	Asian	Black	White	Other
	Ø	Ø	Ø	Ø	Ø	Ø	Ø
<input type="checkbox"/> Section 1C is not applicable to this coverage.							

D. Notes on Totals. Regarding the totals in the above sections (1A, 1B, and 1C), explain any circumstances (e.g., high turnout) at the polling site that may have prevented you from providing a complete count.

Non-Observed.

Initials:

o.s. jls

E. If direct recording electronic (DRE) machines or scanners were used:

1. Which type of equipment was used? ☐ DRE ☐ Scanner ☐ Other _____

2. Complete the table below.

Machine #	Counter Number at Poll Opening	Counter Number When Observers Departed	Seal Number (if used) at Poll Opening	Seal Number (if used) at Poll Closing

If seals were used, please note any discrepancies or problems (e.g., required seals broken or missing before poll officials arrived at the polling place), and the actions, if any, of poll officials in response.

☒ Section 1E is not applicable to this coverage.

F. Other Counts

1. Complete the table below. Mark "N/A" for questions that are not applicable.

	Number of Ballots Issued to Voters
a. If optical scan ballots were used and there was no scanner, how many optical scan ballots were issued?	
b. How many paper (not optical scan) ballots were issued?	
c. How many curbside ballots were issued?	
d. How many emergency ballots were issued (when DRE machines were not working)?	

☒ Section 1F is not applicable to this coverage.

Initials:

011
ell

2. DESCRIPTION OF POLLING PLACE

A. Draw a diagram of the polling place showing the location of the following:

1. Voting machines or booths
2. Tables for poll officials
3. Any officially designated interpreters or bilingual poll officials
4. Voting instruction signs or cards
5. Sample ballots (if any)
6. Telephone (if any)
7. Federal observers
8. Poll watchers (if any)

* All signs in English

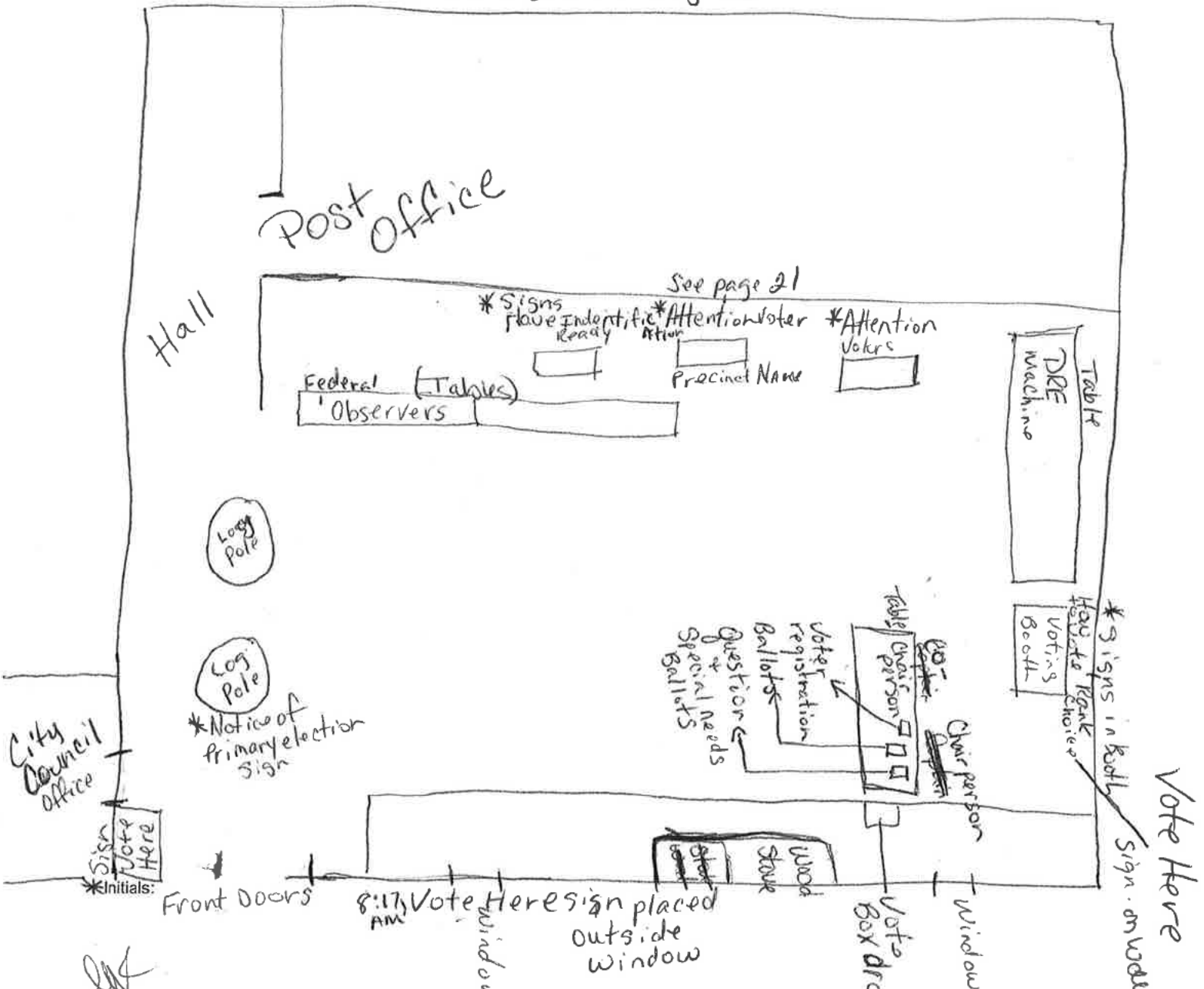

☐ Not applicable to this coverage

B. Signage

Describe information found on election-related signs observed in and around the polling place.

Precinct, if applicable: _____

Sign Observed Include title, description, color, etc.	Where was the sign posted?	Was it easily visible to voters?	In what language(s) was the sign printed?
Vote Here (white) Has District/Precinct Name Poll times phone #'s for regions + language assistance	At front door	<input checked="" type="checkbox"/> Yes <input type="checkbox"/> No	English
Notice of Primary Election (white) purpose of election Date held. On first poll in building	On first wood pole in building	<input checked="" type="checkbox"/> Yes <input type="checkbox"/> No	English
Have Identification Ready (white) If no identification will be asked to vote questioned ballot	By the Federal observers table	<input checked="" type="checkbox"/> Yes <input type="checkbox"/> No	English
Attention Voters (white) Precinct Name and are you in need of assistance. (See pg 21)	By the Federal observers table	<input checked="" type="checkbox"/> Yes <input type="checkbox"/> No	English
Vote Here Sign (white) Big Letter sign	8:17 AM to chair Placed on outside of polling area	<input checked="" type="checkbox"/> Yes <input type="checkbox"/> No	English
Vote Here Sign (white) Big Letter Sign	Behind voting booth	<input checked="" type="checkbox"/> Yes <input type="checkbox"/> No	English
Instruction booklet on how to set up voting tablet v upat printer	DRE machine table	<input checked="" type="checkbox"/> Yes <input type="checkbox"/> No	English
How to Vote sign (white)	Voting Booth	<input checked="" type="checkbox"/> Yes <input type="checkbox"/> No	English
Ranking Choice Voting (white) explanation of how to fill out ballot	Voting Booth	<input checked="" type="checkbox"/> Yes <input type="checkbox"/> No	English
		<input type="checkbox"/> Yes <input type="checkbox"/> No	

Did observe a folder labeled Language assistant that was unopened by poll workers.

Initials:

Q.A. J.A.

C. Phones

1. What type of telephone equipment was available for use by the poll officials in the polling place?

☐ Land line ☐ Jurisdiction-provided cell phone ☒ Personal cell phone ☐ None

2. Did the poll officials use the phone to contact jurisdiction officials? ☒ Yes ☐ No
(If "yes," describe circumstances.)

@ 7:19 a.m. - Poll official Brianna Nelson used pers. cell phone to call Region 4 office to advise of DRE machine not turning on.
(See 21)

@ 11:05 AM Brianna called region ~~4~~ talked to Jessica to advise DRE is set to 4 instead of ~~0~~. Per Brianna Jessica with region office told Brianna not to use machine.

3. ELECTION OFFICIALS

A. List each poll official on duty, **including interpreters**. (Interpreters are persons assigned specifically to provide language assistance to voters who speak a language other than English and have no other pre-assigned responsibilities.)

Poll Official (List precinct, if applicable.)	Race or Ethnicity	Title/Function/Duties	Language(s)/Dialect(s) Spoken (including English)
Brianna Nelson	AN	Chair Person	English
Charlene Larson	AN	CO-Chair Person	English

Did Bilingual poll official wear "Can I help" badge?
In Yup'ik / Gwich'in? NO. No language speaker available.
(See pg. 21)

Initials:

o.s. [signature]

☐ Not applicable to this coverage

B. Language Skills of Poll Officials

1. Did any poll officials claim to speak a language other than English? ☐ Yes ☒ No

If "yes," describe their level of fluency (e.g., completely fluent, moderately proficient, basic skills, no ability).

2. Were any of the poll officials unable to speak English? ☐ Yes ☒ No

If "yes," who? _____

3. Did any poll officials have as their **only** duty to provide language assistance to voters?

☐ Yes ☒ No *If "yes," who?* _____

- C. Note the times each poll official was absent from the polls: Precinct, if applicable: N/A

<u>Bilingual</u> Poll Official	Out	In	Out	In	Out	In	Out	In
<u>None</u>								

- D. Identify any poll official(s) who acted as the leader. Brianna Nelson

- E. Were there any disagreements among the poll officials?

☐ Yes ☒ No *(If "yes," describe the disagreement(s). Also identify any poll official(s) who were excluded from or did not participate in efforts to resolve these controversies.)*

Initials:

☐ Not applicable to this coverage

F. Training of All Poll Officials

1. List each poll official on duty, including interpreters.

Poll Official	Received Election Training? (Yes or No)	When	Where	Length of Training (Hours)	Who Conducted Training
Brianna Nelson	NO	Last trained in 2020	N/A	N/A	N/A
Charlene Larson	Yes	6/21/22	Dillingham	4 hrs.	Jeff

2. Describe the training generally, and identify poll officials who provided this information to you.

Poll Co-chairperson Charlene, said that the training was conducted by Jeff but she couldn't remember his last name. Charlene said she was given sample ballots to review and Jeff walked them through the ballots. Charlene also said they discussed the different ^{types} of ~~of~~ ^{of} ballots but she couldn't remember ~~them~~ ^{what} types.

Poll Chairperson Brianna said she did not receive any training for this election but she did receive ⁸ training in 2020. Brianna

said the training she received in 2020 was through a DVD that Brianna said was very thorough. due to Covid

Initials:

O.S. [Signature]

G. Training of Bilingual Poll Officials or Interpreters

1. Did any of the bilingual poll officials or interpreters listed above receive training from the jurisdiction on **how to translate the contents of the ballot** or **how to provide procedural instructions in the minority language**?

☐ Yes ☐ No (If "yes," identify the poll officials who attended and describe the training. Also, identify the poll officials that you interviewed for this question.)

Not applicable as no bilingual poll officials or interpreters were present ~~for this election~~ for this election, (See page 21) at this site.

2. Was the training conducted separately from the general training described in Question F.2?

☐ Yes ☐ No (If "yes," describe when and where the training occurred and who conducted it.)

Not applicable.

3. Were voting procedures and ballot content discussed in the minority language during the training? ☐ Yes ☐ No

Not applicable.

4. Did the jurisdiction use any audio-visual aids (e.g., audio tape, video tape, flip chart) during the training on minority language procedures?

☐ Yes ☐ No (If "yes," describe.)

Not applicable.

5. a. Before election day, did the jurisdiction provide a copy of any audio-visual aids to any of the bilingual poll officials or interpreters?

☐ Yes ☐ No If "yes," who? _____

Not applicable.

- b. If "yes," did any of the bilingual poll officials or interpreters use the audio-visual aids after the training session?

☐ Yes ☐ No (If "yes," give their names and explain how they used the audio-visual aids.)

Not applicable

Initials:

0.9. JLB

4. VOTING PROCEDURES

A. Prior to Opening the Polls

Precinct, if applicable: 37-724

1. What time did the poll officials arrive at the polling place? 10:57 a.m.

Information obtained by ☒ observation or ☐ questioning poll officials.

2. Were the poll officials given an oath of office?

☐ Yes ☒ No If "yes," by whom? _____

Information obtained by ☐ observation or ☒ questioning poll officials.

3. What items (such as envelopes, forms, notices, cards, sample ballots, provisional/challenged affidavit ballots, etc.) were provided to the polling site? (Do not include signs identified on p. 5. Identify any items printed in a language other than English and specify the language. Indicate if a document was only partially translated.)

Handwritten notes: Poll Chair Person Brianna told Fed. Observers that she did not take an oath but they did sign an oath on Reg. form. & Co-Chair Person Charlene
Fed. Observer Otilia asked Chair Person Brianna what documents were provided to the polling site. Chair Person Brianna told Fed. Obs. that she was provided with a check-list and corresponding documents that included everything in the list except 1 item which was unused envelopes. All other documents included instructions, ballots, envelopes, lang. asst. packet and Questioned and Special needs ballots & envelopes.

4. Did the polling place open on time? ☐ Yes ☒ No (If "no," explain reason for delay.)

What time did the polls open? 7:17 a.m.

Handwritten notes: Poll Chair Person Brianna arrived at the polling site at 10:57 a.m. and ^{started} setting up the equipment and voting area. At 7:17 a.m. Federal Observers asked Chair Person Brianna if the Polls were open as no formal announcement was made and Brianna responded "Yeah, I guess so."

5. Was all voting equipment operational when the polls opened?

☐ Yes ☒ No ☐ Not Observed (If "no," explain what poll officials did to resolve problems.)

• The DRE machine would not power on.

Poll Chair Person Brianna called the Region 4 office (@ 7:19 a.m.) to let them know the machine wouldn't turn on.

Brianna was told by the Region office that they would call her back. Federal Observers, Monica & Otilia both heard the conversation and asked

Initials:

Handwritten notes: O.S. [initials] Brianna what the name of the Region 4 person was but Brianna could not remember the name of the person she spoke to.

6. Were there long lines at this site when the polls opened? ☐ Yes ☒ No (If "yes," explain.)

~~7. Were the names of voters who cast absentee or early ballots marked on the poll list?~~

~~☐ Yes ☐ No~~

~~8. Were the absentee ballots delivered to the polls by the jurisdiction?~~

~~☐ Yes ☐ No If "yes," by whom? _____~~

B. Poll Watchers

Precinct, if applicable: 37-724

1. Were any poll watchers present?

☐ Yes (If "yes," complete Questions 2 through 4.) ☒ No (If "no," skip to Section C.)

2. Obtain the following information about the poll watchers: N/A

Poll Watcher	Race/Ethnicity	Candidate or Party Representing	Approximate Time at Polls

3. Did the poll officials require the poll watchers to present any type of authorization?

☐ Yes ☐ No If so, what? Not Observed

4. Were poll watchers permitted to observe all aspects of the voting process, other than the actual marking of the ballots? Not observed

☐ Yes ☐ No (Describe any limitations imposed on poll watchers throughout the day.)

Initials:

O. H. [Signature]

C. While the Polls Were Open

Precinct, if applicable: 37-704

1. What voting system(s) were available for voters to cast regular ballots?

(Check all that apply.)

- ☒ Direct Recording Electronic (DRE) Machines (Complete Question 2.)
- ☒ Optical Scan Ballots (Complete Question 3.)
- ☐ Other Voting Methods (Complete Question 4.)

2. DRE Machines

- a. Was the counter set to zero before voting began? ☐ Yes ☒ No ☐ Not Observed
DRE machine was set to 1. Which is why pollworkers were not
- b. Did the poll official give voters any forms indicating that they were permitted to vote? *instructed not to use machine.*
☐ Yes ☒ No If "yes," from whom? _____
- c. Were voters given an activator card (a device to insert into the machine to begin voting)?
Not observed - machine not used.
☐ Yes ☐ No If "yes," who programmed the activator card? _____
- d. If the DRE machines were not working, did the poll officials offer voters an alternative way to cast their ballots?
☒ Yes ☐ No (If "yes," describe the alternative method.)
Voters were provided optical scan ballots.
- e. Were headsets connected to at least one machine to allow voters to listen to an audio version of the ballot?
☒ Yes ☐ No If "yes," in what language(s)? *English per Co Chair Charlene*
- f. Was any time limitation imposed on voters? ☐ Yes ☒ No If "yes," how long? *NA*
- g. If voters attempted to use marked sample ballots, were all voters allowed to do so?
☒ Yes ☐ No ☐ Not Applicable (If "no," explain, including who prevented their usage.)
** DRE machine was not operable.*

Initials:

3. **Optical Scan Ballots**

- a. From whom did voters receive their ballots? Chair Person Brianna
- b. Where did voters go to mark their ballots? Voters sat at tables and chairs and sometimes voters booth.
- c. Was any time limitation imposed on voters? ☐ Yes ☒ No If "yes," how long? _____
- d. If voters attempted to use marked sample ballots, were **all** voters allowed to do so?
- ☒ Yes ☐ No ☐ Not Applicable (If "no," explain, including who prevented their usage.)

- e. Where were cast ballots deposited?

☒ Ballot Box ☐ Scanner ☐ Elsewhere (Explain.)

- f. Who deposited the ballots? ☒ Voter ☐ Poll Official

- g. If a scanner was used:

Was it set to zero before voting began? ☐ Yes ☐ No ☒ Not Observed

Did it reject any ballots voters inserted? ☐ Yes ☐ No ☒ Not Observed

Were privacy sleeves used to keep the ballot choices secret?

☒ Yes ☐ No ☒ Not Observed
Obs all

- h. Was another ballot made available to any voter who spoiled his/her first ballot?

Not observed
☐ Yes ☐ No If "yes," where were spoiled ballots deposited? _____

4. **Other Voting Methods** (If applicable, describe any other voting equipment or types of voting systems used.)

Questioned ballots and special needs ballots

Initials:

D. Determining a Person's Eligibility to Vote

Identify each individual not permitted to vote on Charts B, "Persons Not Permitted to Vote" (p. 25). At the end of the day, include a summary of those responses in the questions below.

1. Describe generally what registration book(s) or list(s) were consulted at the entrance to the polling place or at the check-in table to determine voters' registration status.

Brianna was given a registration list of people. Brianna would check voters in with the list of names provided and have voters sign it to receive the ballot. When Brianna was away Charlene would do the same process.

2. If voters' names were not found in the registration book(s) or list(s), what did poll officials do?

This was not observed. However, Chair-Person Brianna told Fed. Observers that if the voter's name is not found in Reg. book, the voter would be given a Questioned Ballot.

3. Did poll officials attempt to contact off-site election officials to verify or determine voters' registration status? ☐ Yes ☒ No (If "yes," explain circumstances and who was called.)

4. If voters were told that they were not on the registration list at the polling site, what (if anything) were they told to do (e.g., directed elsewhere, offered a provisional ballot)?

Voters were offered a questioned ballot.

5. Were registration forms available for voters who were not registered? ☐ Yes ☒ No

6. Describe any other actions, not included above, that were taken to determine voters' registration status.

None observed

Initials:

O.G. [Signature]

☐ Not applicable to this coverage

E. Minority Language Assistance from Poll Officials and Interpreters

Language assistance is any conversation in the minority language concerning the election process (e.g., finding names in the poll book, giving instructions on how to use the machine, translating the ballot, providing a provisional ballot), whether inside **or** outside the voting booth. Provide individual accounts of language assistance on Charts C1, C2, C3, and C4 (pp. 26-29). At the end of the day, answer the following general questions about language assistance.

1. General

- a. How was it determined who received minority language assistance (e.g., did the poll officials ask voters if they needed assistance, was each minority voter automatically given such assistance, was help given only at the request of the voter, or did officials offer this help to only certain minority voters)?

none observed

- b. Did poll officials fail to provide minority language assistance to any voter who requested such assistance?

☐ Yes, details captured on ☐ Charts C1-C4 and/or ☐ page(s) _____.

☒ No *not observed*

- c. Did poll officials fail to provide minority language assistance to any voters who struggled to speak in English?

☐ Yes, details captured on ☐ Charts C1-C4 and/or ☐ page(s) _____.

☒ No *not observed*

- d. Did poll officials try to prevent any voter from using an assistor-of-choice (e.g., a relative) in providing minority language assistance?

☐ Yes, details captured on ☐ Charts C1-C4 and/or ☐ page(s) _____.

☒ No *not observed*

2. Did any poll official provide instruction in a minority language on how to cast the ballot (e.g., how to use the machine, how to mark the ballot, how to cast a write-in vote, how to vote by party if straight-ticket voting is allowed, how many votes may be cast for a given office)?

☐ Yes, details captured on ☐ Charts C1-C4 and/or ☐ page(s) _____.

☒ No

Initials:

O.G. [signature]

3. Was an oral interpretation of the ballot provided in the minority language to voters?

☐ Yes, details captured on ☐ Charts C1-C4 and/or ☐ page(s) _____.
☒ No

4. Other Conversation in Minority Language

If poll officials/interpreters used a minority language for general greetings or general conversation with voters concerning non-election-related topics, describe the nature of the conversations, how frequently they occurred, the languages spoken, etc.

None observed

F. Delays in Voting

1. What was the average number of voters waiting in line to vote during the day? 0

2. What was the average length of time voters had to wait to vote? No waiting

3. At any time during the day, did voters have to wait more than 15 minutes to vote?

☐ Yes ☒ No If "yes," provide the following information:

a. When did the line form? N/A How many voters were in line? _____

b. What were voters waiting for (e.g., to sign in, to receive help from an interpreter, to enter a voting booth)?

N/A

c. What action, if any, did poll officials take to alleviate the delay?

N/A

Initials:

O. A. [signature]

G. Provisional, Challenged, or Affidavit Ballots

☐ Not applicable to this coverage

Identify any voters who cast provisional, challenged, or affidavit ballots in Charts D (p. 30). At the end of the day, summarize those responses in the questions below.

1. Were provisional, challenged, or affidavit ballots available for use?

☒ Yes ☐ No ☐ Not Observed

a. In what languages were the ballots printed?

English only. Chairperson Brianna told Fed. Observers that the Questioned ballots are available in English only.

b. Describe the ballot used to cast provisional ballots (e.g., optical scan ballot).

0.5 ~~Optical~~ Questioned Special needs ballots were available as optical scan ballots at check-in table.

2. Interview poll officials in detail about their provisional ballot procedures (e.g., When are provisional ballots used? What are the procedures for provisional ballots? Do poll officials check with jurisdiction officials or other sources to determine if voters are in the correct precinct?).

Polico-chairperson did not know if Questioned Ballots were available in any other language or when the Quest. Ballots would be used. Poll Chair-Person Brianna, told Fed. Observers that the Ballots are only available in English. Brianna said they are to use Quest. Ballots if the voter is not on the Registration list, or if the pollworkers don't know them or if ~~on~~ the voter does not have I.D. *

3. Did the poll officials follow the procedures explained in Question 2?

☒ Yes ☐ No ☐ Not Observed (If "no," explain how stated procedures differed from actual practice.)

4. Were voters given envelopes or forms (other than the ballot itself) to fill out before they cast their provisional ballots?

☒ Yes ☐ No ☐ Not Observed

If "yes," in what languages? English

Initials:

* Federal Observers ¹⁷ ~~did not~~ did not observe pollworkers call officials regarding Questioned ballot procedures.

5. Did poll officials have written information (e.g., a handout or receipt) for voters casting provisional ballots (other than the envelope described in Question 4)?

☒ Yes

☐ No

If "yes," in what languages?

English

- a. What did the handout say (e.g., information on how voters could determine if their provisional ballots were counted)?

Explained why voter had to fill out a questioned ballot. Explained how to find out if voters questioned ballot was counted.

- b. Did poll officials offer a handout to **every** voter casting a provisional ballot (see Charts D)?

☒ Yes

☒ No

☐ Not Observed

6. How were the ^{Questioned} provisional ballots kept (e.g., separate from other ballots)?

Yes, the Questioned ballots were kept in a separate file in a folder then the other ballots.

7. Were the provisional ballots counted at the polls? ☐ Yes ☐ No ☒ Not Observed
(If "yes," complete p. 36.)

☒ Not applicable to this coverage

H. Identification (ID) Requirements

To obtain some of the following information, you may have to ask questions of one or more poll officials. Obtain this information only during times when doing so would not interrupt or interfere with the voting or assistance process. Identify poll official(s) interviewed.

1. Under what circumstances, if any, did the poll officials say that they would ask a voter for ID?

2. Did the poll officials receive training on any ID requirements?

☐ Yes

☐ No

☐ Not Applicable

(If "yes," interview the poll officials about the training.)

Initials:

O.S. J.M.

3. Did the list of registered voters "flag" or otherwise indicate that certain voters needed to present identification?

☐ Yes ☐ No (If "yes," describe.)

4. Did you observe **any** voters being asked for identification? ☒ Yes ☐ No

If "yes," answer the questions below.

a. Which voters were asked for identification? (All? Some? Explain.)

b. What form(s) of identification were the poll officials willing to accept?

c. If voters did not have identification, what did poll officials tell them to do in order to cast a ballot (e.g., complete a form first)?

Initials:

O. H. H.

5. GENERAL

- A. Describe poll officials' willingness to answer your questions. Describe any difficulties (if any) you had with poll officials in performing your duties (e.g., observing assistance to voters, obtaining information about persons not permitted to vote, or obtaining information about training, etc.).

Chair-person Brianna and co-Chairperson Cherlene, were both very approachable and answered any and all questions asked by Federal observers. Both poll workers were engaged and receptive to both Federal observers. Chair-person Brianna told Fed. Observers to "ask away" for any information that was needed.

- B. Provide information regarding the presence of any law enforcement officials and any of their activities you observed.

Not observed. No law enforcement and/or officials were present.

- C. Provide information regarding the presence of any media (e.g., newspaper, radio, television, etc.) and any of their activities you observed. Identify media names and/or call letters.

Not observed. No media ^{O.G.} ~~presence~~ was present during the time the Federal Observers were at the polling site.

- D. If you observed the voters or others being treated rudely by poll officials or others, describe in detail what happened. Include actual words used and whether poll officials took any actions in response.

The poll workers greeted all voters in the same manner. They welcomed all voters and provided the materials necessary to cast their ballots. ~~to the voters.~~ O.G.

Initials:

O.G. 

E. Describe any election-related incidents that occurred but are not recorded elsewhere in the report.
Use blank continuation sheets for additional items, as needed.

Page 6 ^{Ci} #2 pollworkers

7:19 AM Brianna and Charlene could not get the DRE machine screen to turn on. Brianna called Region 4 office to advise that ^{DRE} machine screen was not turning on. Office told Brianna they would call Brianna back.

Page 6, #3 A. and Page 9 section 6

Poll Chair-person Brianna told Fed. observers that there were no bilingual speakers available to help work the election. Brianna stated that they posted for help ^{up} from bilingual workers, however, nobody responded. When Fed. observers asked the pollworkers what they would do if anybody needed language assistance, co-chair person ^{obs.} Charlene, said that they are supposed to call the office but she was not sure what office.

Cont. Pg. 6-C2
At 10:46 a.m.

Co-Chair-person, Charlene, went over to the DRE machine in an attempt to get it started and was successful. Both chair-person Brianna & co-chairperson Charlene worked together to ^{obs.} set the DRE machine up. The audio ~~were~~ ^{obs.} hooked-up as well. The DRE instructions were only ^{obs.} ~~available~~ ^{available} in English.

At 11:19 AM

Initials:

Chairperson Brianna was told ^{By Jessica with region #4} that the pollworks are not ~~able~~ ^{ME} to use the DRE machine because ²¹ the machine was set to 1.

O.J.

Throughout the day, there was a lot of activity going on at the polling site. The Post Office was situated behind the wall of the polling site and several locals were coming in and out to pick-up their mail throughout the day. There were also several children running in and out of the polling site throughout the day. Several family members stopped by to visit with Chair Person Brianna and co-chair person Charlene. [REDACTED]

[REDACTED]. The Council office was also located in the same building as the polling site and was frequented by many of the locals throughout the day.

Initials:

21A

Precinct, if applicable: 37-724

☐ None observed ☐ Not applicable to this coverage

CHART A – VOTING TALLY SHEET

PERSONS PERMITTED TO VOTE									
Time*	Race or Ethnicity	Tally of Voters Who Cast a Regular Ballot	Hourly Totals			Cumulative Totals			
Start: 7:00 AM	AN	0	0			0			
	W	0		0			0		
End: 8:20 AM	O	0			0			0	
					/				/
Start: 8:20 AM	AN		5			5			
	W			0			0		
End: 9:20 AM	O				0			0	
					/				/
Start: 9:20 AM	AN		7			12			
	W	'		1			1		
End: 10:20 AM	O				0			0	
					/				/
Start: 10:20 A.M.	AN		3			15			
	W			0			1		
End: 11:20 A.M.	O				0			0	
					/				/

* Indicate the starting and ending times of each interval (e.g., Start: 7:00 a.m.; End: 8:00 a.m.).

Initials:

[Handwritten signature]

Precinct, if applicable: 37-724

☐ None observed ☐ Not applicable to this coverage

CHART A – VOTING TALLY SHEET

PERSONS PERMITTED TO VOTE									
Time*	Race or Ethnicity	Tally of Voters Who Cast a Regular Ballot	Hourly Totals				Cumulative Totals		
Start: 11:20 a.m. End: 12:20 p.m.	AN	111	6				21		
	W			0				1	
	O				0				0
						/			/
Start: 12:20 p.m. End: 1:20 p.m.	AN	111	3				24		
	W			0				1	
	O				0				0
						/			/
Start: End:									
Start: End:									

* Indicate the starting and ending times of each interval (e.g., Start: 7:00 a.m.; End: 8:00 a.m.).

Initials:

01-211

22 A

Precinct, if applicable: 37-724

☒ None observed ☐ Not applicable to this coverage

CHART A1 – LANGUAGE ASSISTANCE TALLY SHEET

Time	Language/ Dialect	Tally - Official 1 Name:	Tally - Official 2 Name:	Tally - Official 3 Name:	Tally for Family/Friends	Hourly Total	Cuml. Total
Start:							
End:							
Start:							
End:							
Start:							
End:							
Start:							
End:							
Start:							
End:							
Start:							
End:							

Initials:

O. H.
elw

Precinct, if applicable: 37-724

☒ None observed ☐ Not applicable to this coverage

CHART A2 – NON-LANGUAGE ASSISTANCE TALLY SHEET

Time	Voters' Race/Ethnicity	Tally of Assistance Given by Poll Officials	Name(s) of Poll Officials Who Assisted	Tally of Assistance Given by Family/Friends	Hourly Total	Cuml. Total
Start:						
End:						
Start:						
End:						
Start:						
End:						
Start:						
End:						
Start:						
End:						
Start:						
End:						

Initials:

O.S. [Signature]

Precinct, if applicable: 37724

☒ None observed ☐ Not applicable to this coverage

CHART B – PERSONS NOT PERMITTED TO VOTE

Voter's Name	Race	Voter's Phone	Time of Interaction
Voter's Address			
Name/Title of Official Not Permitting Vote	Race	Language(s) Spoken During the Interaction	
Official's Reason for Not Permitting Vote		Actions/Suggestions Made by Official	
Did the voter state to the official that s/he had voted at this site before? <input type="checkbox"/> Yes <input type="checkbox"/> No			
Any Other Statements Made by Voter (e.g., when and where registered)			
Information obtained by <input type="checkbox"/> observation or <input type="checkbox"/> questioning voter			

Voter's Name	Race	Voter's Phone	Time of Interaction
Voter's Address			
Name/Title of Official Not Permitting Vote	Race	Language(s) Spoken During the Interaction	
Official's Reason for Not Permitting Vote		Actions/Suggestions Made by Official	
Did the voter state to the official that s/he had voted at this site before? <input type="checkbox"/> Yes <input type="checkbox"/> No			
Any Other Statements Made by Voter (e.g., when and where registered)			
Information obtained by <input type="checkbox"/> observation or <input type="checkbox"/> questioning voter			

Initials:

o.g. [signature]

Precinct, if applicable: 37-724

<input checked="" type="checkbox"/> None observed	<input type="checkbox"/> Not applicable to this coverage
---	--

CHART C1 – VOTERS NEEDING ASSISTANCE

Voter: _____ Race: _____ Begin Time: _____ End Time: _____

Address: _____ Phone: _____

Interpreter or Poll Official: _____ Observer: _____

Assistance Occurred: ☐ Outside the booth (or before voter begins voting)
 ☐ Inside the booth (or while voter is voting)
 ☐ After voting was completed

Reason Voter Needed Assistance (e.g., language *[specify]*, disability, literacy): _____

Description of Interaction

1. *Describe the assistance or denial/lack of assistance (e.g., poll official asked if assistance was needed, voter failed to receive assistance, voter denied assistor-of-choice). Note if a family member or friend assisted the voter.*

2. If assistance was observed, did the poll official/interpreter mark the ballot contrary to the voter's wishes or mark the ballot without input from the voter?

☐ Yes ☐ No ☐ Not Observed (If "yes," describe.)

3. *For Minority Language Coverage Only:* If the poll official/interpreter translated the ballot, did the official translate **every** part of the ballot into the minority language (e.g., each candidate's office, each proposition, instructions on the number of candidates the voter can select)?

☐ Yes ☐ No ☐ Not Observed (If "no," describe what was not translated into the minority language and any statements made by the voter.)

Initials:

Precinct, if applicable: 37-724

☒ None observed ☐ Not applicable to this coverage

CHART C2 – ASSISTANCE IN A MINORITY LANGUAGE (OFFICES)

Interpreter/Poll Official: _____ Observer: _____

Office	Translation by the Interpreter/Poll Official (Include words spoken in English in brackets [].)

Initials:

O.S. ell

Precinct, if applicable: _____

☐ None observed

☒ Not applicable to this coverage

CHART C3 – ASSISTANCE IN A MINORITY LANGUAGE (PROPOSITIONS)

Interpreter/Poll Official: _____ Observer: _____

Proposition	Number	Translation by the Interpreter/Poll Official (Include words spoken in English in brackets [] .)

Initials:

OK elk

Precinct, if applicable: 37-724

☒ None observed ☐ Not applicable to this coverage

CHART C4 – ASSISTANCE IN A MINORITY LANGUAGE (VOTING PROCEDURES)

Interpreter/Poll Official: _____ Observer: _____

Procedure	Translation by the Interpreter/Poll Official (Include words spoken in English in brackets [].)

Initials:
OK. ell

Precinct, if applicable: 37-724

☐ None observed ☐ Not applicable to this coverage

CHART D – VOTERS CASTING *Questioned*
☐ PROVISIONAL, ☐ CHALLENGED, OR ☐ AFFIDAVIT BALLOTS

Voter's Name <i>Federal Observers unable to obtain name</i>	Race <i>AN</i>	Voter's Phone <i>Unknown</i>	Time of Interaction <i>11:10 a.m.</i>
Voter's Address <i>Unknown</i>			
Name of Official Challenging/Providing Ballot <i>Brianna Nelson</i>	Race <i>AN</i>	Language(s) Spoken During the Interaction <i>English</i>	
Reason Provided by Official <i>Voter not found in registration book</i>		1. Did the official check with off-site election officials? <input type="checkbox"/> Yes <input checked="" type="checkbox"/> No 2. Did the official tell the voter to check with off-site election officials? <input type="checkbox"/> Yes <input checked="" type="checkbox"/> No 3. Did the officials tell the voter that s/he was registered elsewhere? <input type="checkbox"/> Yes <input checked="" type="checkbox"/> No If "yes," where? 4. Did the official provide voter with a handout on how s/he could determine if the provisional ballot was counted? <input checked="" type="checkbox"/> Yes <input type="checkbox"/> No 5. Was the ballot kept separate from the unchallenged ballots? <input checked="" type="checkbox"/> Yes <input type="checkbox"/> No	
Voter's Response <i>Voter did not object to completing questioned ballot</i>			
Information obtained by <input checked="" type="checkbox"/> observation or <input type="checkbox"/> questioning voter			

Voter's Name	Race	Voter's Phone	Time of Interaction
Voter's Address			
Name of Official Challenging/Providing Ballot	Race	Language(s) Spoken During the Interaction	
Reason Provided by Official		1. Did the official check with off-site election officials? <input type="checkbox"/> Yes <input type="checkbox"/> No 2. Did the official tell the voter to check with off-site election officials? <input type="checkbox"/> Yes <input type="checkbox"/> No 3. Did the officials tell the voter that s/he was registered elsewhere? <input type="checkbox"/> Yes <input type="checkbox"/> No If "yes," where? 4. Did the official provide voter with a handout on how s/he could determine if the provisional ballot was counted? <input type="checkbox"/> Yes <input type="checkbox"/> No 5. Was the ballot kept separate from the unchallenged ballots? <input type="checkbox"/> Yes <input type="checkbox"/> No	
Voter's Response			
Information obtained by <input type="checkbox"/> observation or <input type="checkbox"/> questioning voter			

Initials:

O. G. [Signature]

Precinct, if applicable: _____

☒ Not applicable to this coverage

CHART E – PROCEDURES AFTER THE POLLS CLOSE

1. What time did the polls close? _____
2. How many persons were in line to vote when the polls closed? _____
3. Were all persons who were in line when the polls closed permitted to vote? ☐ Yes ☐ No
If "no," who would not permit them to vote, and what reason(s), if any, was given?

-
4. a. Was an observer present for any procedures related to the counting of the ballots at the polls?
☐ Yes ☐ No (If "no," skip all questions in the remainder of Chart E.)
 - b. Did an observer accompany the ballot box or voting machines to the jurisdiction's elections office after the polls closed? ☐ Yes ☐ No (If "yes," explain procedures.)

5. DRE or Lever Voting Machines

☐ Not applicable to this coverage

- a. Were the machines locked and sealed against further voting?
☐ Yes ☐ No If "yes," by whom? _____
- b. Who read the count from the machine? _____
- c. Was the count verified by another official? ☐ Yes ☐ No If "yes," by whom? _____
- d. Was it read correctly? ☐ Yes ☐ No
- e. Who recorded the vote on the official return sheets? _____
- f. Was the vote recorded accurately? ☐ Yes ☐ No

Initials:

0.92 llk

- g. List the machines' serial numbers and record the public counter of each machine at the end of voting.

Machine	Public Counter	Machine	Public Counter	Machine	Public Counter

- h. Were the results announced by the poll officials? ☐ Yes ☐ No
- i. Were the poll watchers provided an opportunity to compare the announced results with the figure on the counter?
- ☐ Yes ☐ No
- j. Were the absentee votes counted and tabulated with the votes shown on the machines?
- ☐ Yes ☐ No
- k. Was the statement of results signed and certified by the poll officials? ☐ Yes ☐ No
- l. As soon as the count was completed and the results announced, was the counter compartment locked?
- ☐ Yes ☐ No If "yes," by whom? _____
- m. What was done with the election supplies such as poll lists, challenged ballots, etc.?

6. Optical Scan Ballots

☒ Not applicable to this coverage

- a. Was a report of the number of persons voting prepared?
- ☐ Yes ☐ No If "yes," by whom? _____
- b. What was done with the election supplies such as ballot stubs, etc.? (Describe supplies.)
- c. Was the ballot box sealed? ☐ Yes ☐ No If "yes," by whom? _____
- d. If appropriate, who took the ballot box to the counting center? _____
- e. Did an observer accompany the ballot box? ☐ Yes ☐ No

Initials:

①. J. L. K.

7. Paper Ballots (**Not** Optical Scan Ballots)

☒ Not applicable to this coverage

- a. Describe the procedures used by poll officials to count paper ballots by hand. Identify the names of poll officials who engaged in the count and their responsibilities. Identify whether ballots were kept separate from other materials on the table. Describe where the ballots were placed after they were counted.

- b. Complete the table below:

	Total
1. Ballots accepted	
2. Ballots partially rejected	
3. Ballots totally rejected	
4. Spoiled ballots	
5. Unused ballots	
Total	

- c. In the chart below, give reasons for total rejection of individual ballots.

Reason for Rejection	Candidates Voted For

Initials:

O.P. MK

d. In the chart below, give reasons for partial rejection of individual ballots.

Office Voted For	Reason for Rejection			
	More Names Marked than Persons to be Elected (Double Vote)	Fewer Names Marked than Persons to be Elected	No Clear Choice	Other (Specify)

e. Were the poll watchers and all other interested persons allowed the opportunity to view the counting process?

☐ Yes ☐ No (If "no," explain.)

f. What time did the ballot box leave the polling place? _____

Who took it? _____

Was it locked? ☐ Yes ☐ No Was it sealed? ☐ Yes ☐ No

8. Absentee Ballots

☒ Not applicable to this coverage

a. Were the absentee ballots counted at the polls? ☐ Yes ☐ No ☐ Not Observed

If "no," where did poll officials say the absentee ballots would be counted?

b. Were absentee ballots opened and stacked? ☐ Yes ☐ No If "yes," by whom? _____

c. Who read the absentee ballots? _____

d. Did anyone hand the ballots to the reader? ☐ Yes ☐ No If "yes," who? _____

e. Was each ballot read as marked? ☐ Yes ☐ No

Initials:

O.S. JR

If "no," how many were not properly read? _____ (Explain how they were misread.)

f. What was done with the ballots after they were read?

g. How many absentee ballots were totally rejected? _____ (Give reasons in chart below.)

Name of Voter	Reason for Rejection	Other Notes

h. How many absentee ballots were partially rejected? _____ (Give reasons in chart below.)

Office Voted For	Reason for Rejection			
	More Names Marked than Persons to be Elected (Double Vote)	Fewer Names Marked than Persons to be Elected	No Clear Choice	Other (Specify)

i. Give the totals for unchallenged and challenged absentee ballots.

Absentee Ballots	Total
Unchallenged	
Challenged	

Initials:

D.S. J.K.

9. Provisional, Challenged, or Affidavit Ballots

☒ Not applicable to this coverage

- a. Were the provisional/challenged/affidavit ballots counted at the polls? ☐ Yes ☐ No

(If "yes," describe the procedures used by poll officials, and identify their names and responsibilities.)

- b. How many provisional/challenged/affidavit ballots were totally rejected? _____
(Give reasons in table.)

Name of Voter	Reason for Rejection	Other Notes

- c. How many provisional/challenged/affidavit ballots were partially rejected? _____
(Provide complete information in table.)

Office Voted For	Reason for Rejection			
	More Names Marked than Persons to be Elected (Double Vote)	Fewer Names Marked than Persons to be Elected	No Clear Choice	Other (Specify)

Initials:

095 llp

10. Election Results

☒ Not applicable to this coverage

- a. Provide election results in the following table. Mark N/A if a certain type of ballot is not counted separately at the polls.

Candidates	Official Regular Ballot Count	Official Challenged Ballot Count	Official Absentee Ballot Count
Office:			
Name:			
Name:			
Name:			
Office:			
Name:			
Name:			
Name:			
Office:			
Name:			
Name:			
Name:			
Office:			
Name:			
Name:			
Name:			
Office:			
Name:			
Name:			
Name:			
Office:			
Name:			
Name:			
Name:			

- b. Describe any problems with the count or controversies that occurred during the count. Identify above (with an asterisk) and describe any contests in which the official count differed from your tallies or observation.

Initials:

O.S. [Signature]