

ASLS 81-149
TRACT A
Plat 84-446

GIRDWOOD
ELEMENTARY
SCHOOL TRACT B
PLAT 85-38

TRACT A1A
GIRDWOOD ELEMENTARY
SCHOOL SUB
PLAT 2014-15

HOLTAN HILLS
TRACT 1
15.0 ACRES

HOLTAN HILLS
TRACT 2
18.0 ACRES

HOLTAN HILLS
TRACT 3
26.3 ACRES

ALYESKA PRINCE
ADDITION 1
TRACT 1
Plat 87-131

GIRDWOOD AIRPORT
PLAT 75-42

CURRENT ZONING:
GR-3, GR-5, GIP, GRST-2, GRR,
GDR and G.O.S.

LEGEND:

	IDITAROD TRAIL
	ORDINARY HIGH WATER
	GRAVEL ROAD
	16" PRIMARY WATERLINE
	GRAVEL PATHWAY
	WETLAND MAPPING PER HDR
	STREAM CENTERLINE

NOTES:

1. AN APPLICATION TO VACATE THE SECTION LINE EASEMENT HAS BEEN MADE TO THE STATE OF ALASKA, DNR.

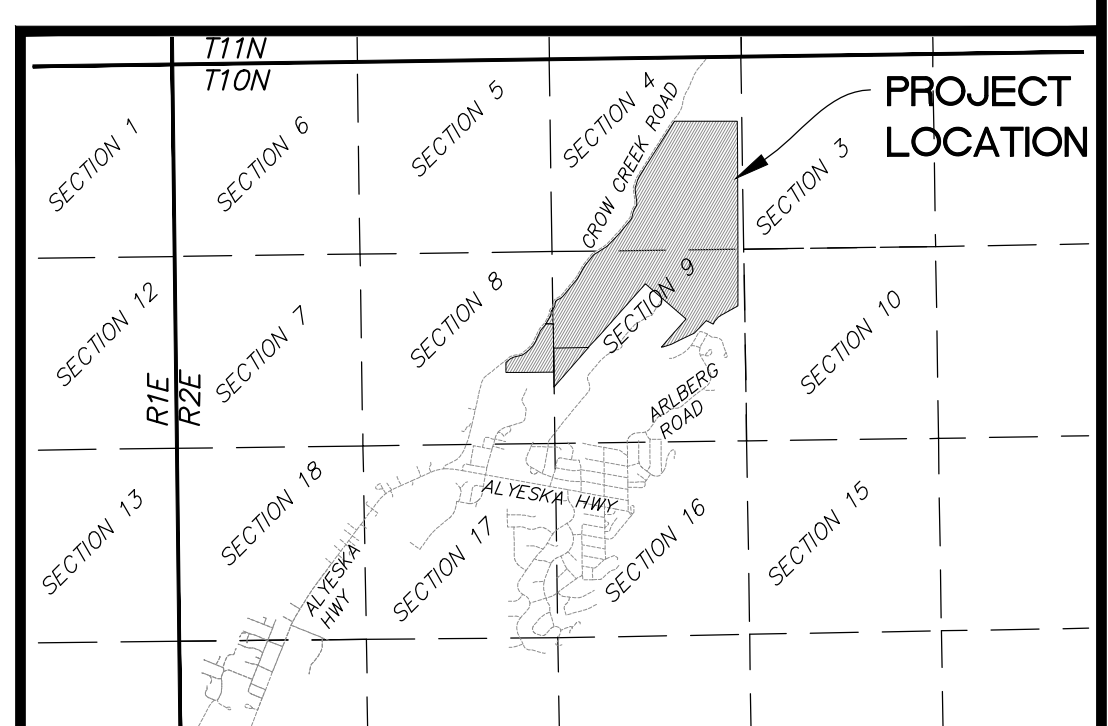
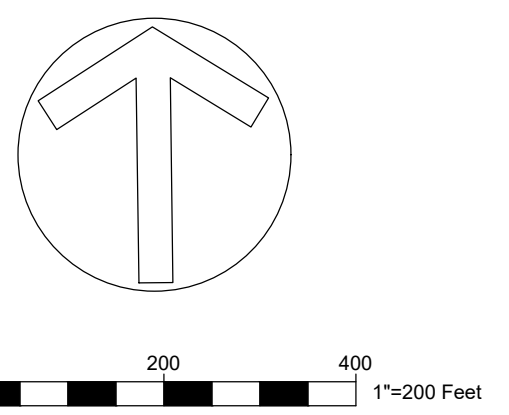

Vicinity Map Scale: 1" = 1 Mile T10N R2E Seward Meridian

PRELIMINARY PLAT
Holtan Hills
Tracts 1 through 3

A Subdivision of:
Tract 1, Alyeska Subdivision, Prince Addition, (Plat 87-131), and
Tract 9A, Supplemental Cadastral Survey, T10N, R2E, S.M., (Plat
73-220) and Tract B, Girdwood Elementary School Subdivision (Plat
85-38) Located within the SE 1/4, Section 8, and Section 4,
T10N, R2E, Seward Meridian, Anchorage Recording District, Alaska.
Creating 4 Tracts in approximately 414.1 acres.

4715, 4716, 4615, 4616,
Grid: 4617, 4517, 4516 & 4417
Scale: 1"=200'
Drawn: TH / Checked: JZ
FB/Page: 2021-8/42-52
Date: 6/14/2022
MOA Case No.: N/A



The Boutet Co.
601 East 57th Place, Suite #102
Anchorage Alaska, 99518
PHONE (907) 522-6776 FAX (907) 522-6779