



**SPECIAL BOARD STUDY SESSION**

**TUESDAY, MARCH 17, 2020**

**5:30 p.m.**

Visalia Unified School District in Boardroom  
5000 West Cypress Avenue, Visalia, CA 93277

**AGENDA**

If documents are distributed to Board members concerning an agenda item within 72 hours of a regular Board meeting, at the same time the documents will be made available for public inspection at the Visalia Unified School District, Superintendent’s Office located at 5000 W. Cypress Avenue, Visalia, CA 93277.

This meeting is held in an area accessible to the disabled. In compliance with the American Disabilities Act, if you need special assistance to participate in meetings, call (559) 730-7529 forty-eight (48) hours in advance of the meeting. For Hearing-Impaired, call (559) 730-7375 (TDD) forty-eight (48) hours in advance of the scheduled meeting time to request signing services. Visually Impaired - if enlarged print or a Braille copy is desired, please request in advance of the meeting and services will be provided as soon as possible after the meeting.

**Estimated  
Timeline**

- 5:30 p.m. 1. **OPENING BUSINESS**
  - 1.1 CALL PUBLIC SESSION TO ORDER
  - 1.2 ESTABLISH QUORUM
  - 1.3 INTRODUCE INTERPRETER
  - 1.4 MEETING ANNOUNCEMENT  
This meeting is being recorded. The recording may capture sounds of those attending the meeting.
  - 1.5 PLEDGE OF ALLEGIANCE – BOARD MEMBER

- 2. **STUDY SESSION**
  - 2.1 FIFTH HIGH SCHOOL DESIGN AND RECOMMENDATIONS
  - 2.2 CORONAVIRUS (COVID19) UPDATE

- 7:00 p.m. 3. **ADJOURNMENT**

**NEXT MEETING**

The next regularly scheduled Board Meeting will be March 24, 2020, with Open Session – Public Comment starting at 5:30 p.m. in the Boardroom at the VUSD District Office located at 5000 West Cypress Avenue, Visalia, and then adjourning into Closed Session. The regular meeting will start at 7:00 p.m. in the Boardroom (unless otherwise posted).

# CONCEPTUAL DESIGN

School Board Study Session  
March 17, 2020

# NEW HIGH SCHOOL

Visalia Unified School District

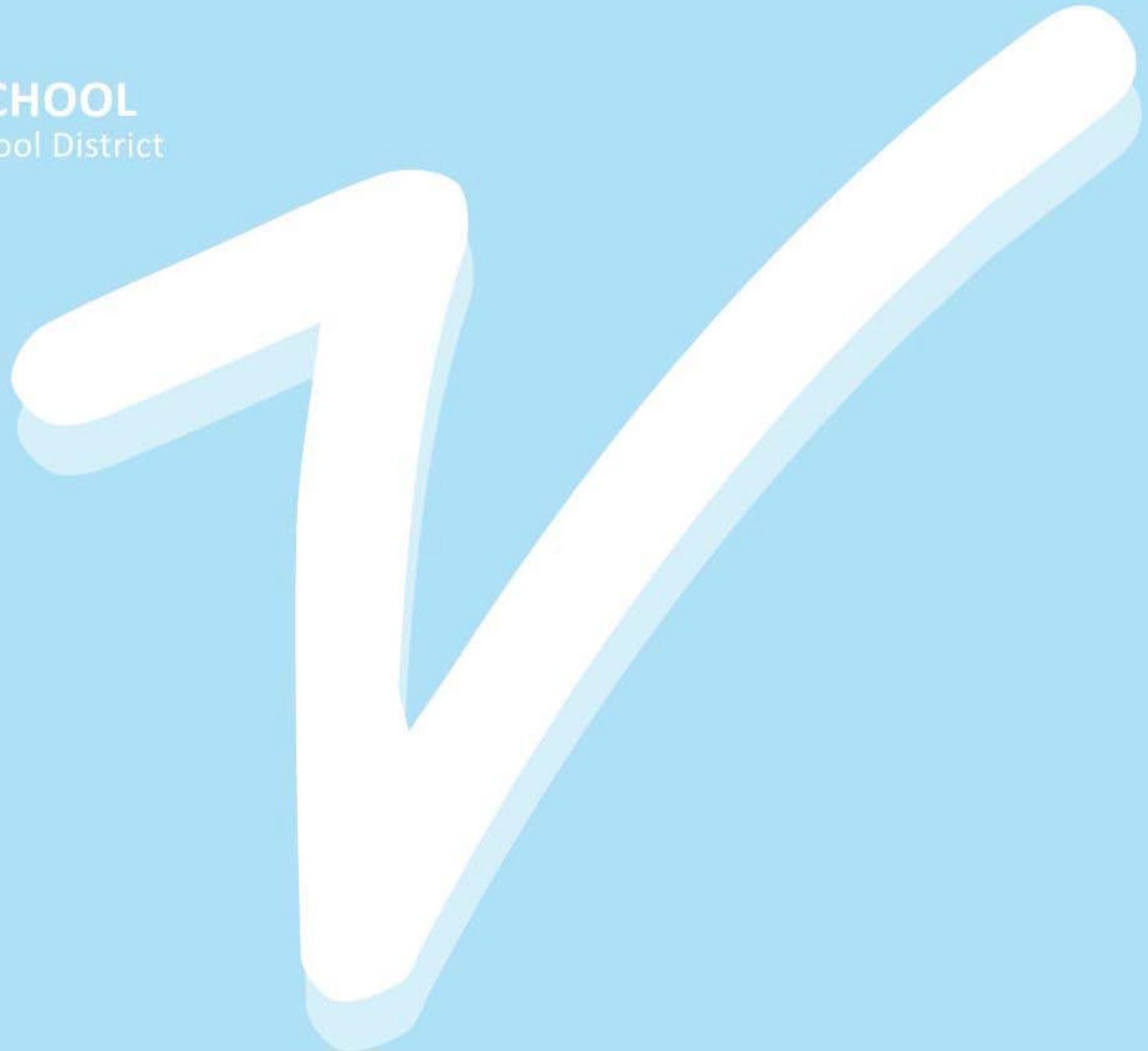

## STUDY SESSION AGENDA

- Review of Previously Presented Scope Options.
- Presentation of Scope Option 4.
- Follow up Q&A Time.

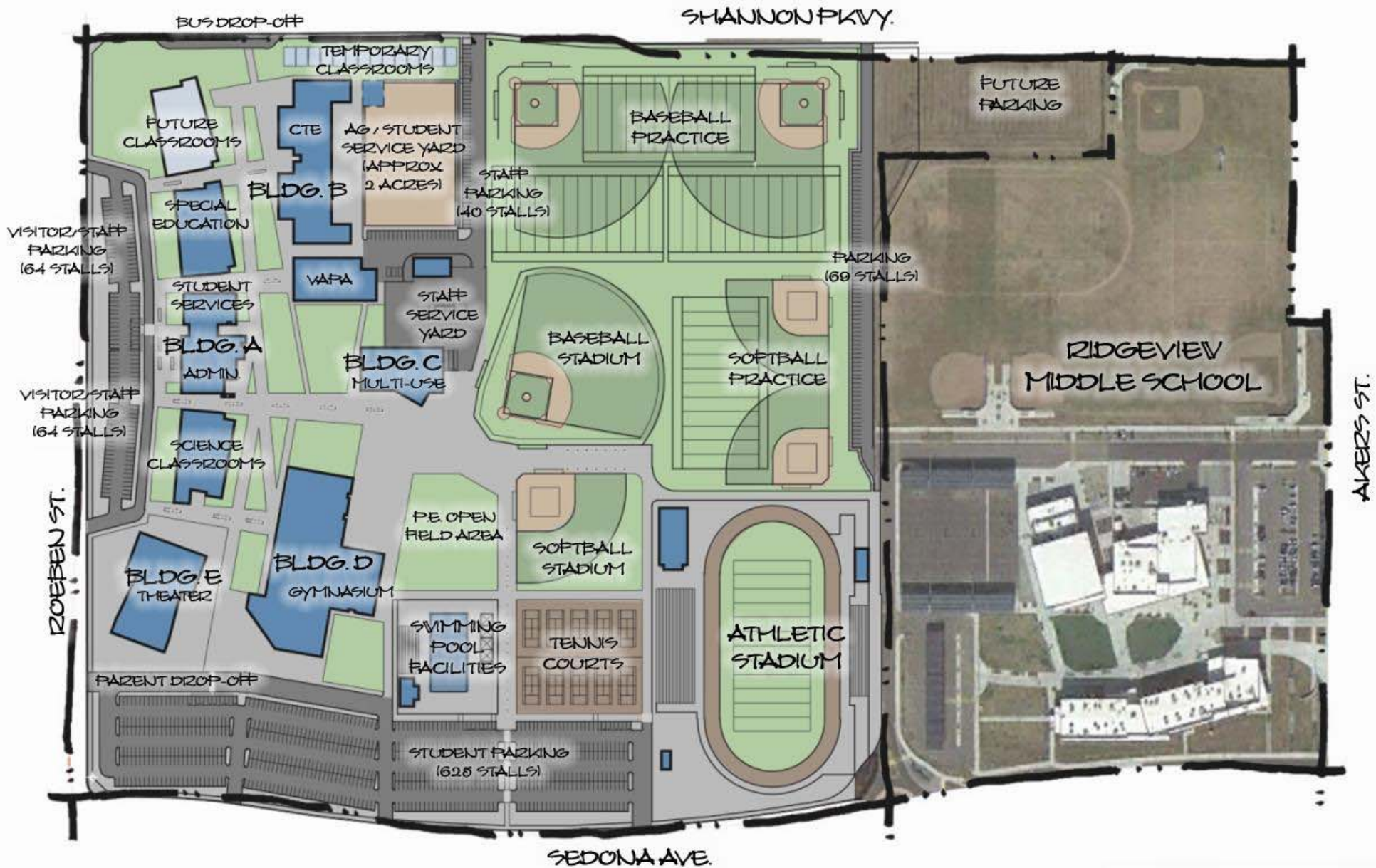

# MASTER PLAN CONCEPTUAL DESIGN

NEW HIGH SCHOOL (1800 STUDENTS)  
VISALIA UNIFIED SCHOOL DISTRICT

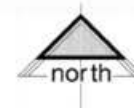

03/17/20

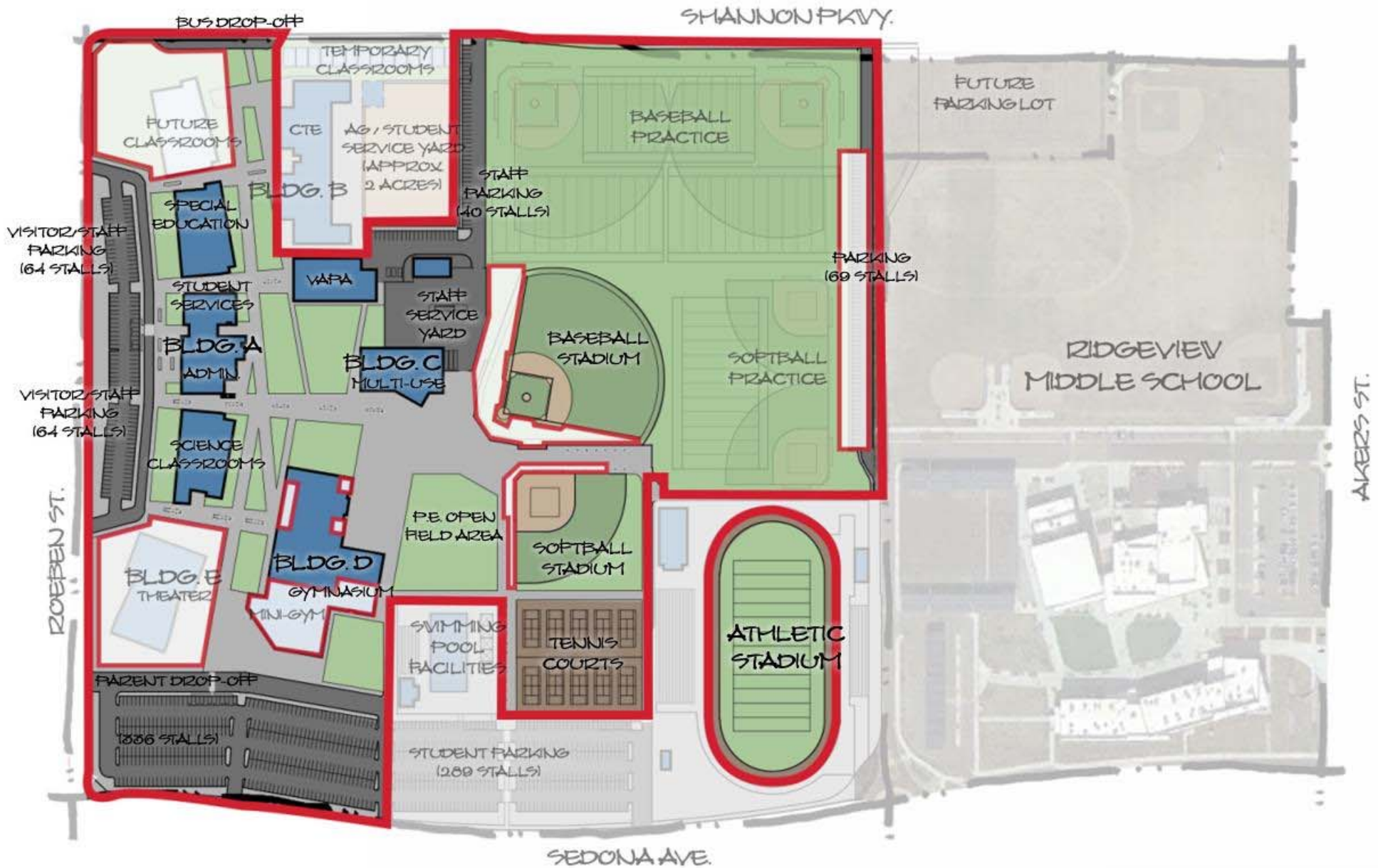

**OPTION 1: \$95M Construction Cost (\$108M Total Budget)  
CONCEPTUAL DESIGN**

NEW HIGH SCHOOL (1450 STUDENTS)  
VISALIA UNIFIED SCHOOL DISTRICT



01/21/20

<b>Option 1</b>	
Construction Cost Estimate	\$94,500,000
Soft Cost Estimate (12%)	\$13,800,000
<b>Total Project Estimate</b>	<b>\$108,300,000</b>
State Funding Estimate (1450 Students)	\$33,300,000
District Funding from Measure "A"	\$75,000,000

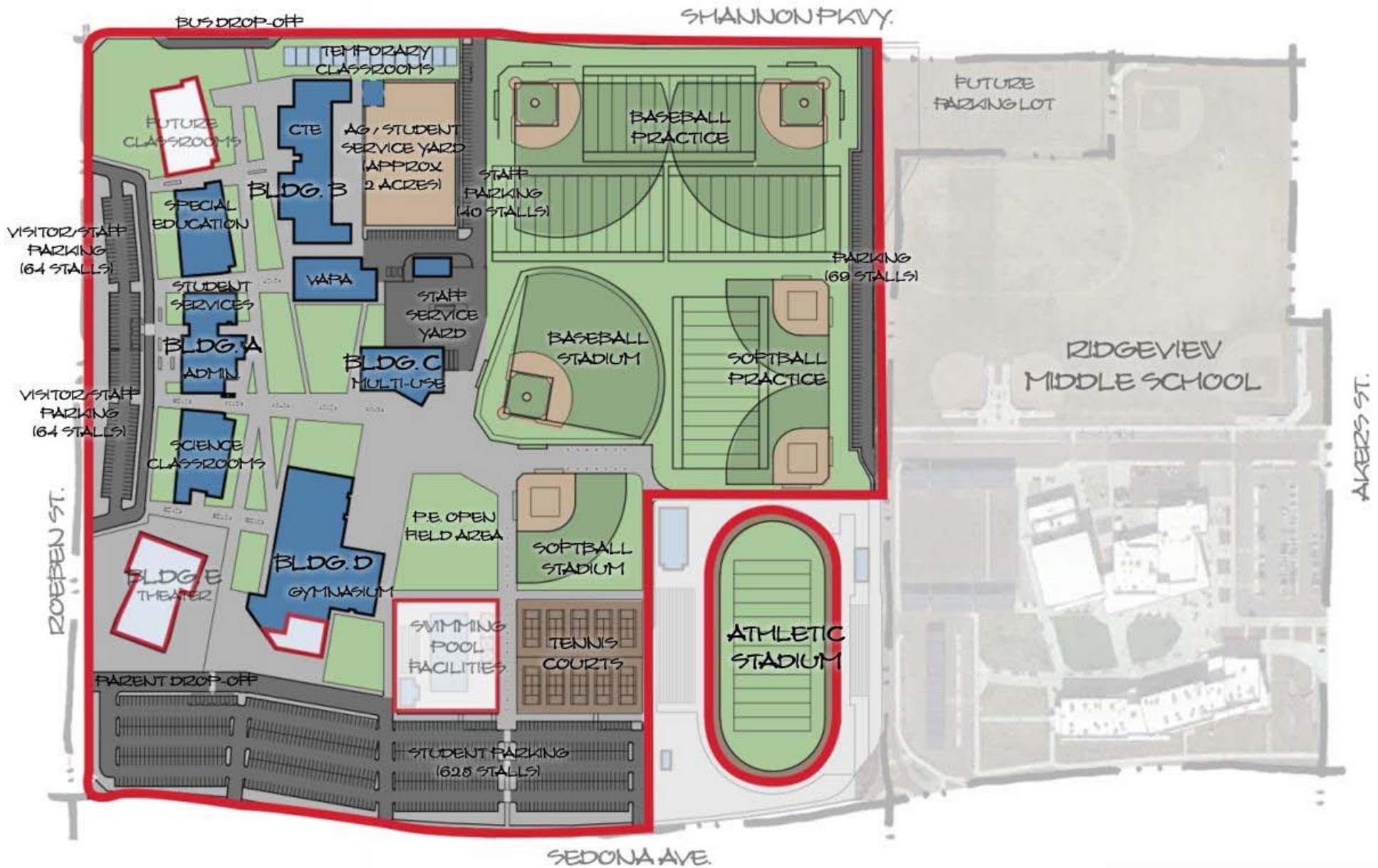

**OPTION 2: \$132M Construction Cost (\$150M Total Budget)**  
**CONCEPTUAL DESIGN**

NEW HIGH SCHOOL (1800 STUDENTS)  
VISALIA UNIFIED SCHOOL DISTRICT

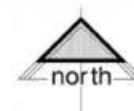

01/21/20

<b>Option 2</b>	
Construction Cost Estimate	\$132,000,000
Soft Cost Estimate (12%)	\$18,000,000
<b>Total Project Estimate</b>	<b>\$150,000,000</b>
State Funding Estimate (1800 Students)	\$44,600,000
District Funding from Measure "A"	\$75,000,000
<b>Additional District Funding Required</b>	<b>\$30,400,000</b>



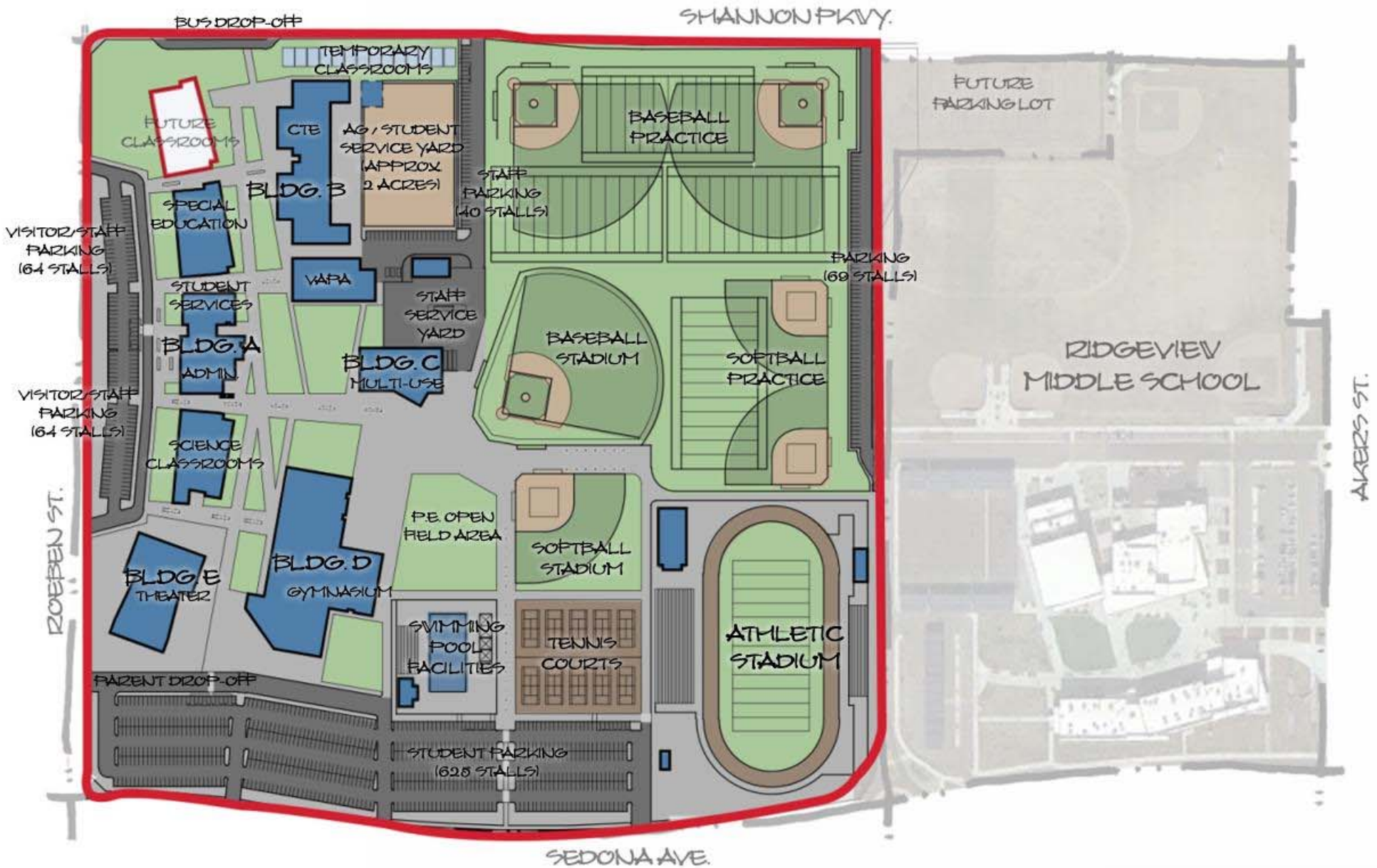

**OPTION 3: \$168M Construction Cost (\$190M Total Budget)**  
**CONCEPTUAL DESIGN**

NEW HIGH SCHOOL (1800 STUDENTS)  
VISALIA UNIFIED SCHOOL DISTRICT

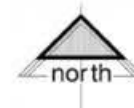

01/21/20

<b>Option 3</b>	
Construction Cost Estimate	\$168,000,000
Soft Cost Estimate (11%)	\$21,500,000
<b>Total Project Estimate</b>	<b>\$189,500,000</b>
State Funding Estimate (1800 Students)	\$44,600,000
District Funding from Measure "A"	\$75,000,000
<b>Additional District Funding Required</b>	<b>\$69,900,000</b>

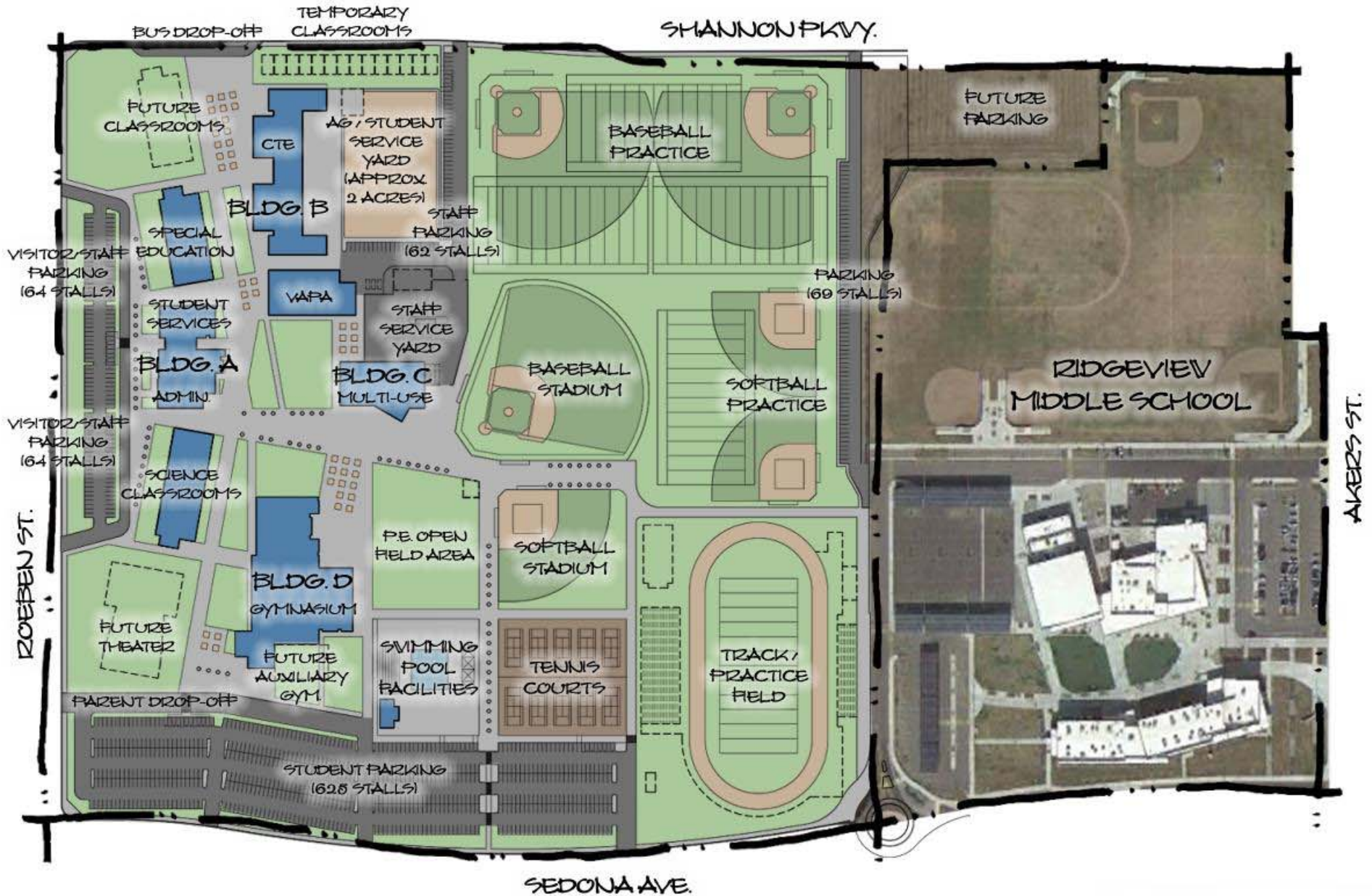

**OPTION 4: \$132M Construction Cost (\$150M Total Budget)**  
**CONCEPTUAL DESIGN**

NEW HIGH SCHOOL (1800 Students)  
VISALIA UNIFIED SCHOOL DISTRICT

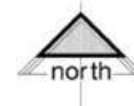

03/17/20

<b>Option 4</b>	
Construction Cost Estimate	\$132,000,000
Soft Cost Estimate (12%)	\$18,000,000
<b>Total Project Estimate</b>	<b>\$150,000,000</b>
State Funding Estimate (1800 Students)	\$44,600,000
District Funding from Measure "A"	\$75,000,000
<b>Additional District Funding Required</b>	<b>\$30,400,000</b>

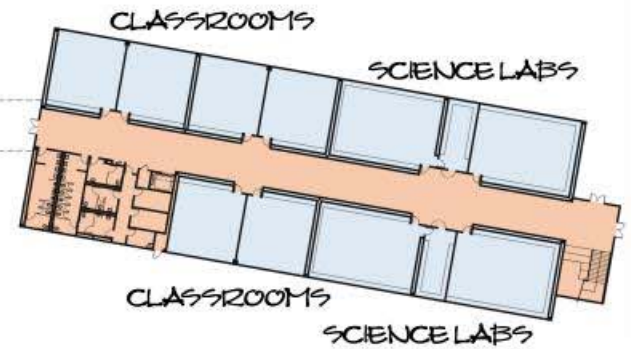
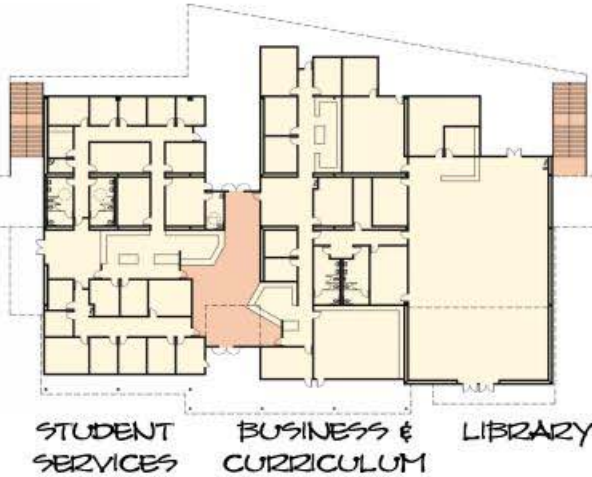
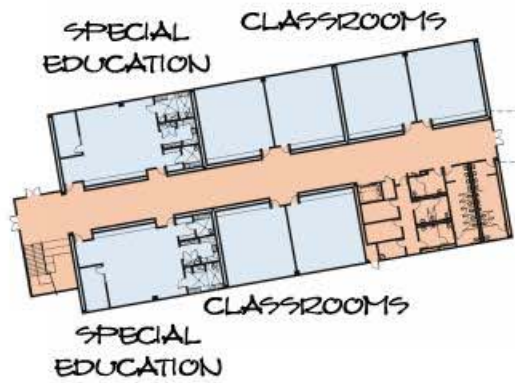
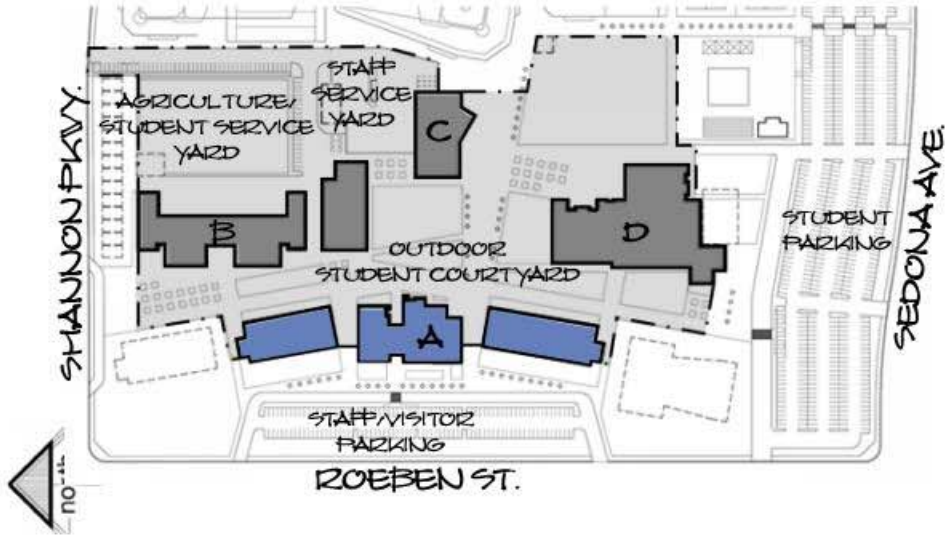

# BUILDING A - FLOOR 1

## CONCEPTUAL DESIGN

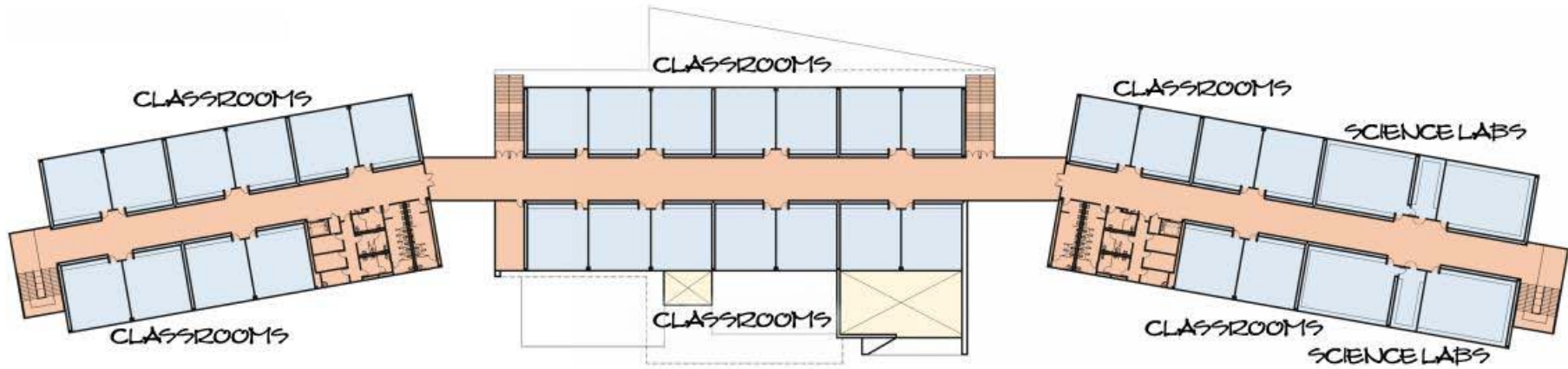
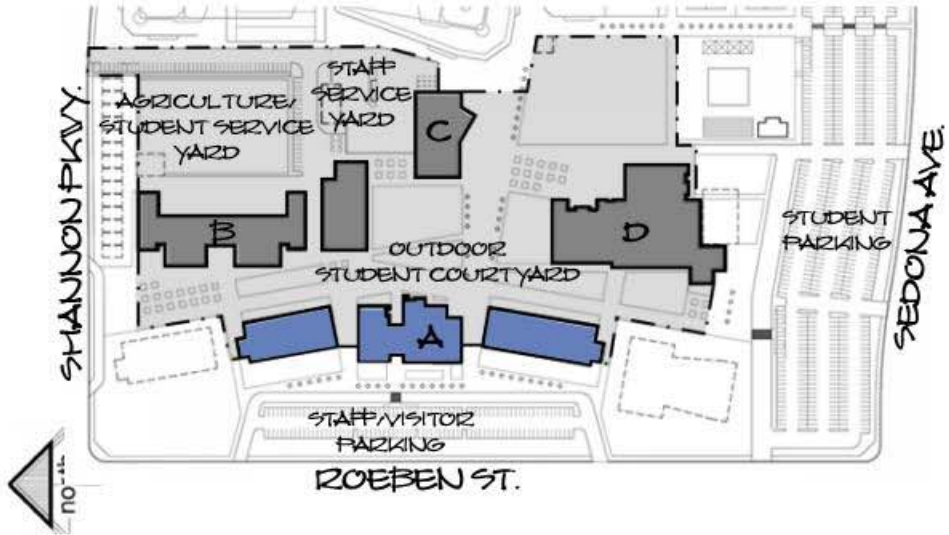

## BUILDING A - FLOOR 2 CONCEPTUAL DESIGN

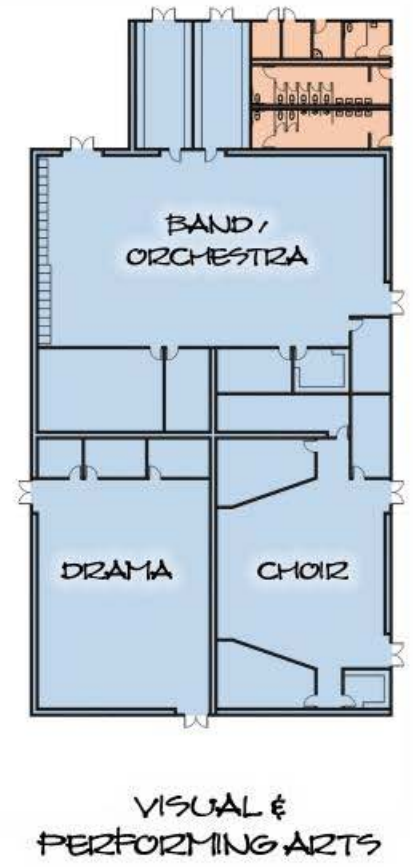
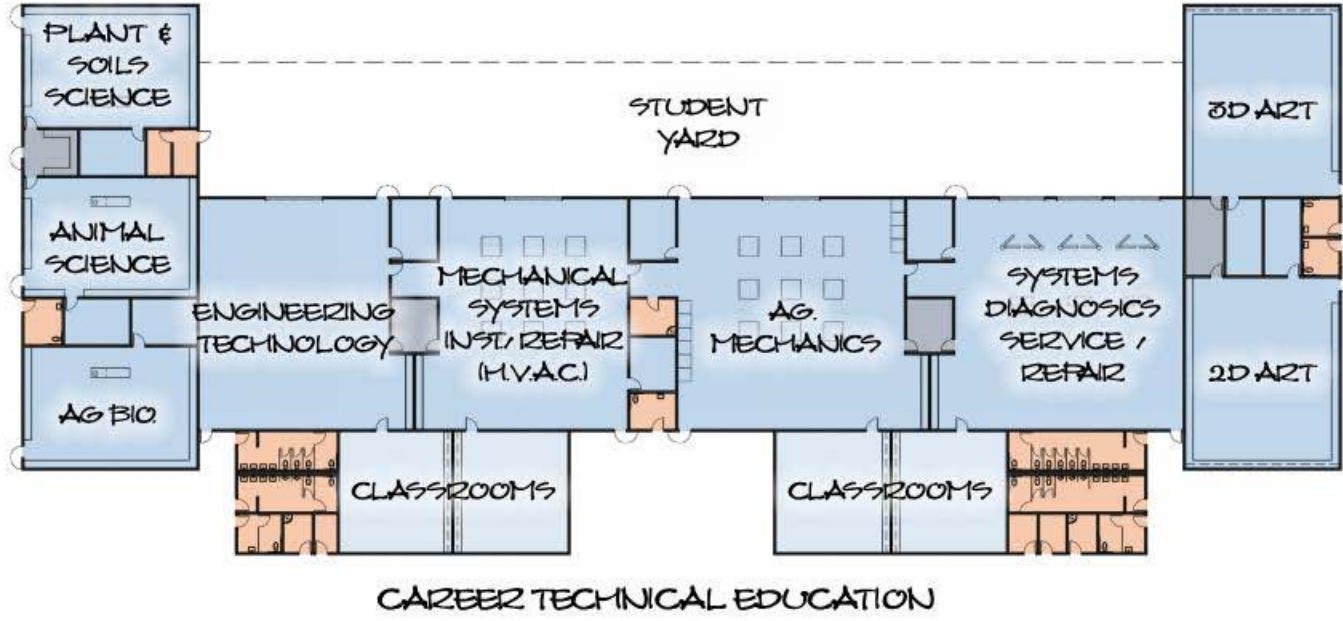
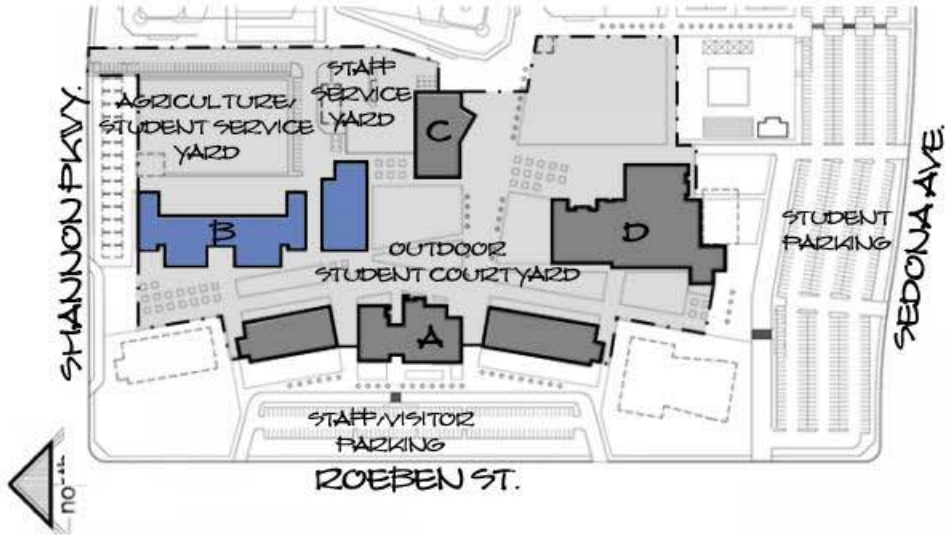

# BUILDING B - CTE/VAPA CLASSROOMS

## CONCEPTUAL DESIGN

NEW HIGH SCHOOL  
VISALIA UNIFIED SCHOOL DISTRICT

03/17/20



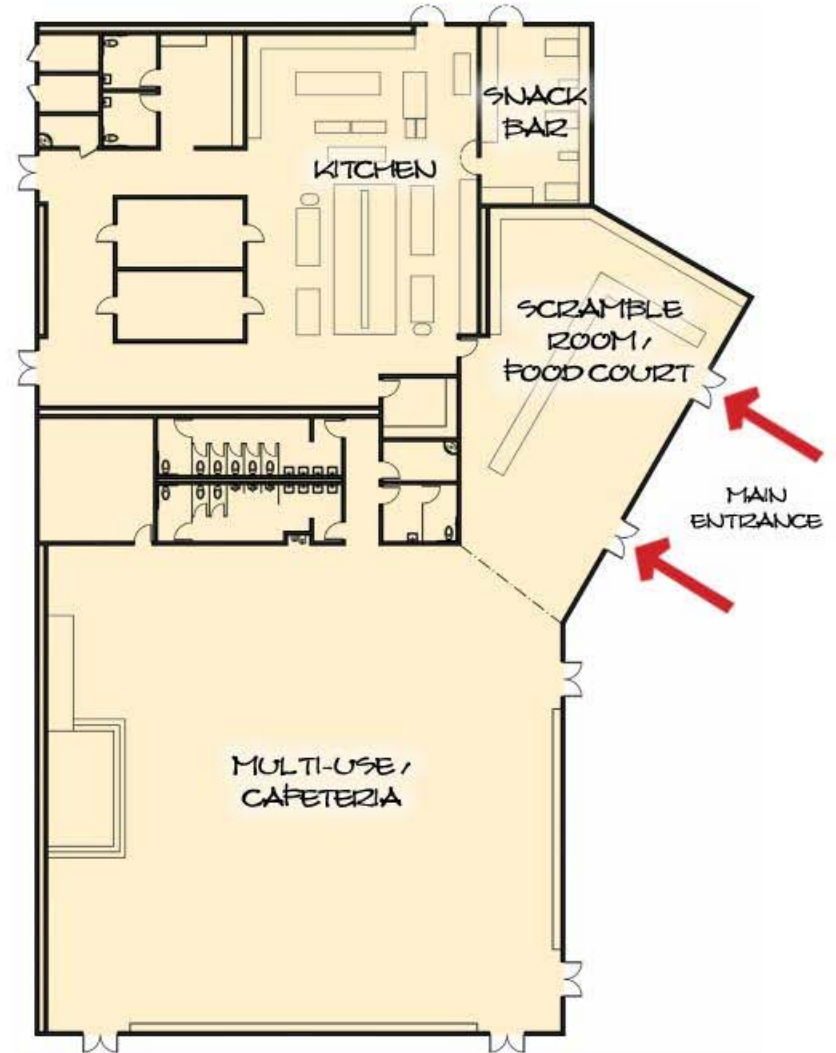
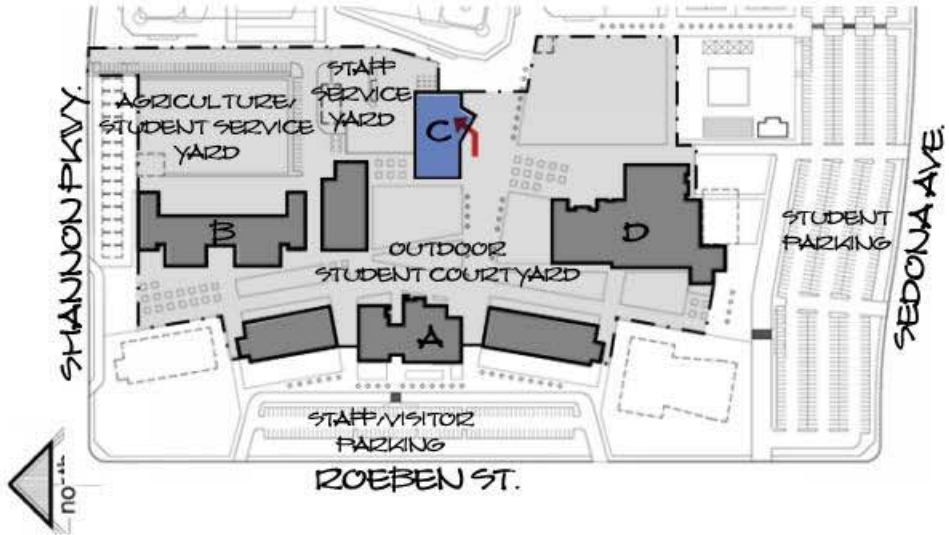

**BUILDING C - MULTI-USE**  
CONCEPTUAL DESIGN



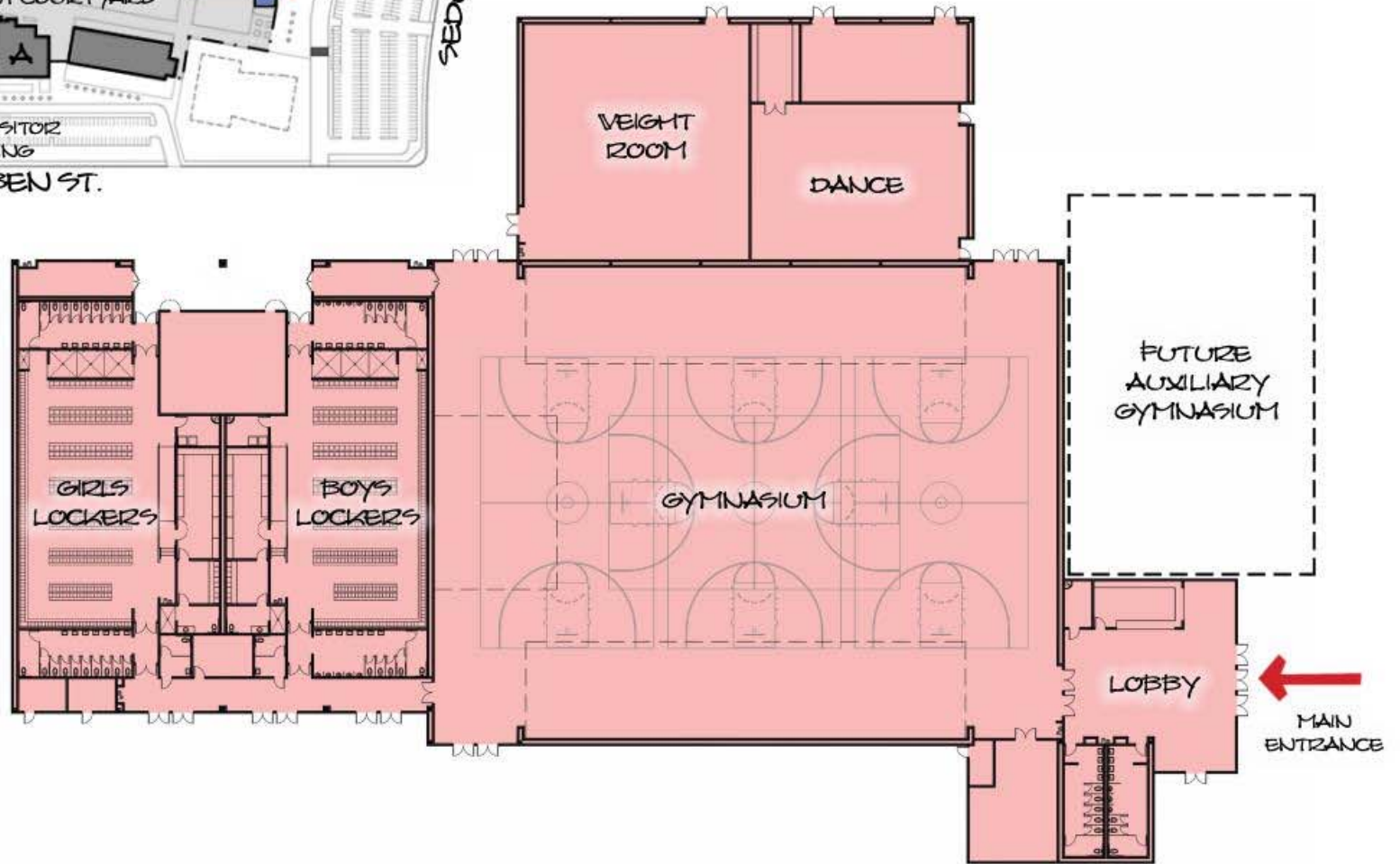
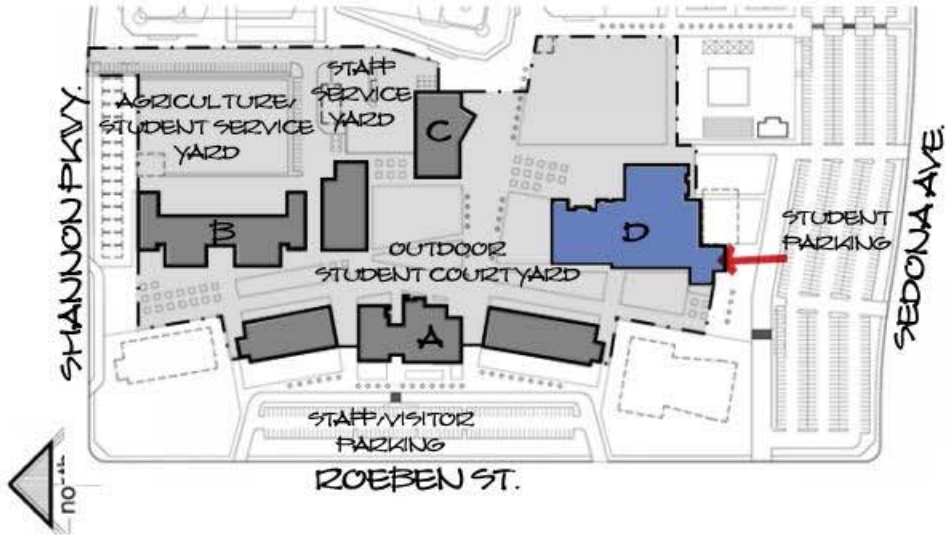

## BUILDING D - GYMNASIUM

### CONCEPTUAL DESIGN

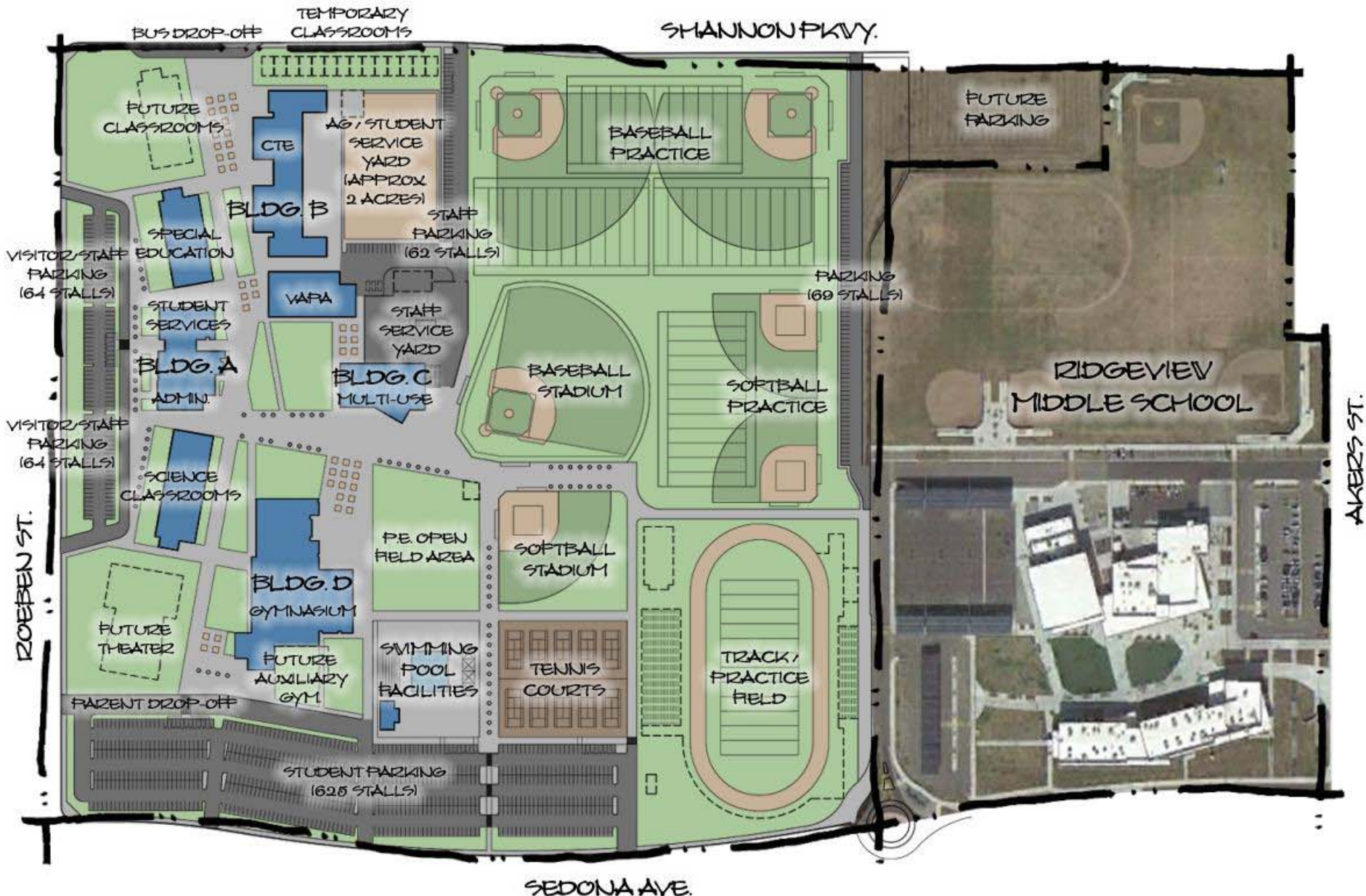

**OPTION 4: \$132M Construction Cost (\$150M Total Budget)**  
**CONCEPTUAL DESIGN**

NEW HIGH SCHOOL (180 Students)  
VISALIA UNIFIED SCHOOL DISTRICT

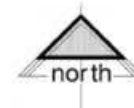

03/17/20