

VIEW FROM THE WEST ALONG CARNEGIE AVE



VIEW FROM THE NORTH LOOKING ALONG EAST CRILE MALL



SITE PLAN

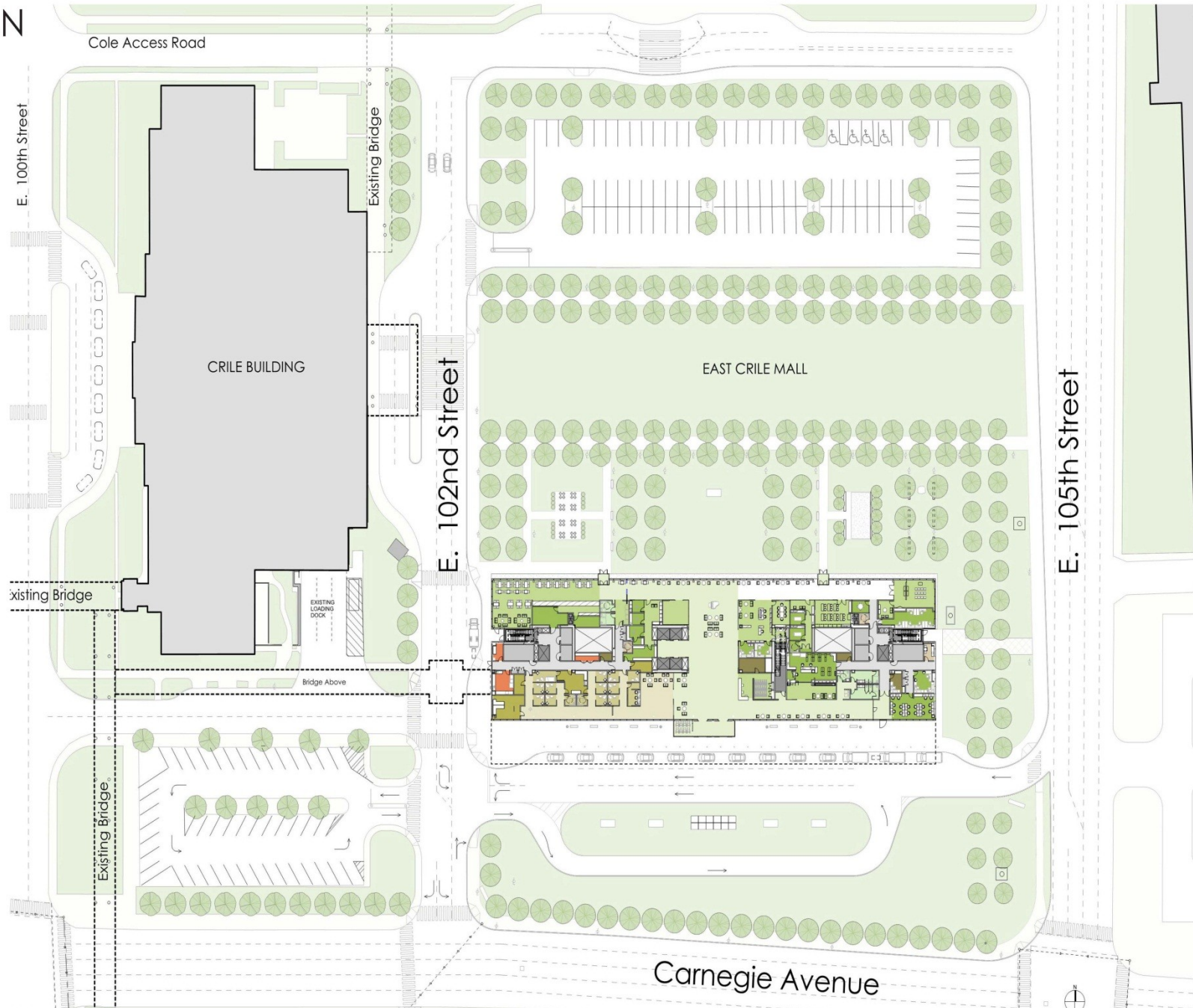



Lower Level

100% DESIGN DEVELOPMENT
10 SEPTEMBER 2014



DISCLAIMER:
NO CLAIM IS MADE FOR THE ACCURACY OF THE INFORMATION ON THIS DRAWING OR DIGITAL OR HARD COPY FORM. THE INFORMATION ON THIS DRAWING IS PROVIDED FOR THE USER'S CONVENIENCE ONLY. ANY AND ALL USERS MUST VERIFY ALL DIMENSIONS IN THE FIELD. USERS MUST ASSUME ALL RISK AND LIABILITY FOR ANY ALTERATION OF THIS INFORMATION.

Project Team

- Architect:** Skidmore, OWINGS & Merrill, P.A. (Architect of Record)
1335 Lee Boulevard, Suite 1900
Cleveland, OH 44115-3900
Tel: 216-444-6400 Fax: 216-445-8800
- Interior Designer:** The Interior Group, LLC
10000 Eastman Avenue, Suite 1000
Cleveland, OH 44130-1000
Tel: 216-445-4000 Fax: 216-445-4000
- Mechanical, Electrical & Plumbing Engineer:** Rockwell Research Consulting Engineers, LLC
Rockwell Research Consulting Engineers, LLC
The American Oil Center, 277 Avenue B
Westerville, OH 43081-2777
Tel: 614-883-3333 Fax: 614-883-3333
- Structural Engineer:** Lathrop & Condit, Inc.
10000 Eastman Avenue, Suite 1000
Cleveland, OH 44130-1000
Tel: 216-445-4000 Fax: 216-445-4000
- Civil Engineer:** O'Brien Engineering, LLC
10000 Eastman Avenue, Suite 1000
Cleveland, OH 44130-1000
Tel: 216-445-4000 Fax: 216-445-4000
- Telcom & Security Engineer:** Telcom & Security Engineering, LLC
10000 Eastman Avenue, Suite 1000
Cleveland, OH 44130-1000
Tel: 216-445-4000 Fax: 216-445-4000
- Medical Equipment Planner:** Safco Resources Group
2000 Main Street, Suite 200
Cleveland, OH 44115
Tel: 216-445-4000 Fax: 216-445-4000
- Landscape Architect:** Gensler & Associates, Inc.
10000 Eastman Avenue, Suite 1000
Cleveland, OH 44130-1000
Tel: 216-445-4000 Fax: 216-445-4000
- Construction Manager:** Turner Construction Company
The Heritage Building, 1425 Euclid Avenue, Suite 1400
Cleveland, OH 44115
Tel: 216-523-1100 Fax: 216-523-0240

2014

**Cleveland Clinic
Cancer Building
ANC09500
Cancer Building**
Cleveland, Ohio

**Cleveland Clinic
Buildings and Properties
Office of Construction**
9500 Euclid Avenue / CC4
Cleveland, Ohio 44195

Project Number: 2014007105
Drawing: Lower Level Department Plan

Scale: 1/16" = 1'-0"
Date: 08/13/2014
Sheet: A4.00

Level 1



CLEVELAND CLINIC MAIN CAMPUS SITE PLAN

DISCLAIMER:
NO CLAIM IS MADE FOR THE ACCURACY OF THE INFORMATION ON THIS DRAWING OR DIGITAL OR HARD COPY FORM. THE INFORMATION ON THIS DRAWING IS PROVIDED FOR THE USER'S CONVENIENCE ONLY. ANY AND ALL USERS MUST VERIFY ALL DIMENSIONS IN THE FIELD. USERS MUST ASSUME ALL RISK AND LIABILITY FOR ANY ALTERATION OF THIS INFORMATION.

Project Team

Architect
Stetson Architecture, Inc. (Architect of Record)
1335 Lake Shore Drive, Suite 1900
Columbus, OH 43260-9900
Tel: 614-449-8480 Fax: 614-449-8865

Interior Designer
The Cleveland Clinic
1335 Lake Shore Drive, Suite 1900
Columbus, OH 43260-9900
Tel: 614-449-8480 Fax: 614-449-8865

Mechanical, Electrical & Plumbing Engineer
Bach & Bach Research Consulting Engineers, LLC
11800 E. 12th Street, #11
Minnetonka, MN 55345
Tel: 763-845-1111 Fax: 763-845-1111

Structural Engineer
Ludwig & Conklin
15000 Eastman Avenue
Beverly Hills, CA 90210
Tel: 310-960-1200 Fax: 310-960-1200

Civil Engineer
O'Brien Engineering
15000 Eastman Avenue, Suite 300
Beverly Hills, CA 90210
Tel: 310-960-1200 Fax: 310-960-1200

Telcom & Security Engineer
Telcom & Security
15000 Eastman Avenue, Suite 300
Beverly Hills, CA 90210
Tel: 310-960-1200 Fax: 310-960-1200

Medical Equipment Planner
Sedco Associates
12500 Northway Street
Dallas, TX 75243
Tel: 214-418-1000

Landscape Architect
Campbell Associates, Inc.
6600 W. 15th Street
Overland Park, KS 66207
Tel: 913-241-7000 Fax: 913-241-7143

Construction Manager
Team Construction Company
The Heritage Building, 1425 E. 12th Avenue, Suite 1400
Columbus, OH 43260
Tel: 614-523-1100 Fax: 614-523-0540

**Cleveland Clinic
Cancer Building
ANC09500
Cancer Building
Cleveland, Ohio**

**Cleveland Clinic
Buildings and Properties
Office of Construction
8500 Euclid Avenue / CC4
Cleveland, Ohio 44195**

Construction Project # 2014007105

**LEVEL 1 DEPARTMENT
PLAN**

**2014 DESIGN DEVELOPMENT
10 SEPTEMBER 2014**



Sheet # 1/16" = 1'-0"
Date: 08/13/2014
A4.01

2014007105-1001-4-R01.PLM ORIGINAL SHEET - 8/13/2014

Level 2

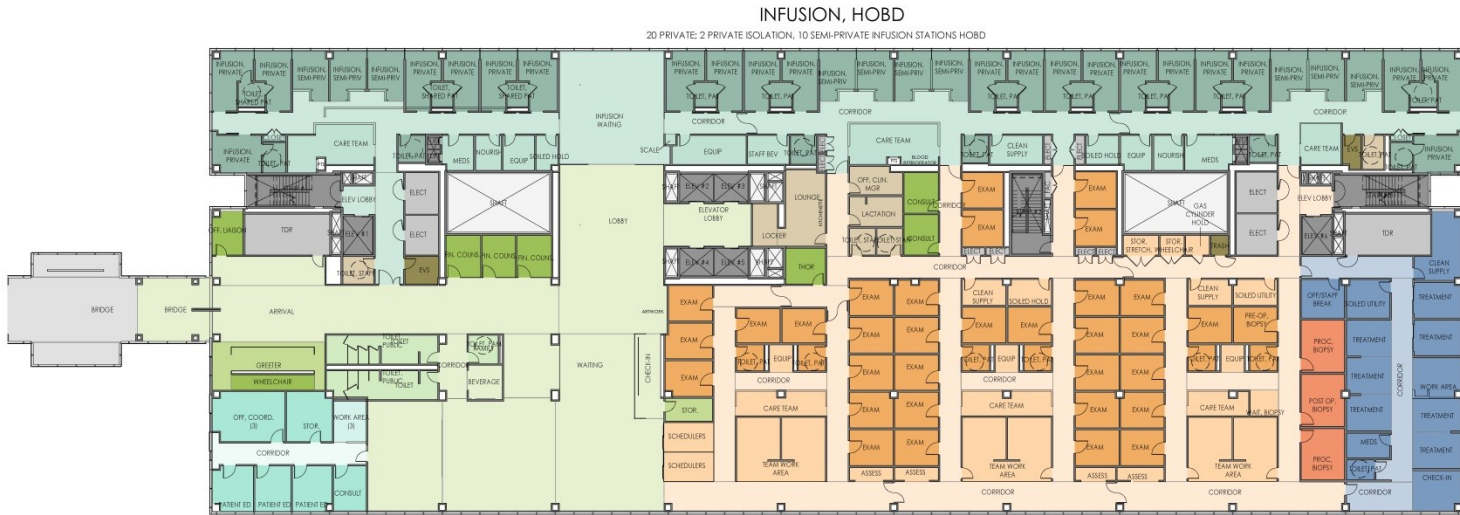

PATIENT SERVICES

BMT PATIENT EDUCATION

3 PATIENT EDUCATION ROOMS

CLINICAL PRACTICE AREA, HOBD
32 EXAM ROOMS

BONE MARROW BIOPSY SUITE
2 PROCEDURE, 1 POST OP

APHERESIS
7 TREATMENT STATIONS

INFUSION, HOBD

20 PRIVATE: 2 PRIVATE ISOLATION, 10 SEMI-PRIVATE INFUSION STATIONS HOBD



CLEVELAND CLINIC MAIN CAMPUS SITE PLAN

DISCLAIMER:
NO CLAIM IS MADE FOR THE ACCURACY OF THE INFORMATION ON THIS DRAWING OR DIGITAL OR HARD COPY FORM. THE INFORMATION ON THIS DRAWING IS PROVIDED FOR THE USER'S CONVENIENCE ONLY. ANY AND ALL USERS MUST ASSUME ALL RISK AND LIABILITY FOR ANY ALTERATION OF THIS INFORMATION.

Project Team

Architect
Stark Architecture, Inc. (Architect of Record)
1255 Lake Shore Drive, Suite 700
Cleveland, OH 44115-3900
Tel: 216-445-4400 Fax: 216-445-8800

Interior Designer
Terra Interior Design, LLC
11111 East 15th Avenue, Suite 1110
Denver, CO 80232
Tel: 303-752-3470 Fax: 303-752-4020

Mechanical, Electrical & Plumbing Engineer
Rock Hill Research Consulting Engineers, LLC
The American Oil Company, 277 Avenue B
Westport, NY 10590-2100
Tel: 914-668-6300 Fax: 914-668-8800

Structural Engineer
Lefebvre Consulting
1320 Cleveland Park Road
Beverly Hills, CA 90212
Tel: 310-658-0200 Fax: 310-658-7000

Civil Engineer
Carter Engineering
12000 Lorain Road, Suite 300
Lakewood, CO 80401
Tel: 303-981-2000 Fax: 303-981-3000

Telcom & Security Engineer
TSC Engineering
10000 W. 12th Avenue, Suite 200
Golden, CO 80401
Tel: 303-441-5000 Fax: 303-441-5000

Medical Equipment Planner
Salem Associates
2000 West 12th Avenue, Suite 200
Golden, CO 80401
Tel: 303-441-5000 Fax: 303-441-5000

Landscape Architect
Landscape Architecture
10000 W. 12th Avenue, Suite 200
Golden, CO 80401
Tel: 303-441-5000 Fax: 303-441-5000

Construction Manager
Terra Interior Design, LLC
11111 East 15th Avenue, Suite 1110
Denver, CO 80232
Tel: 303-752-3470 Fax: 303-752-4020

Cleveland Clinic
Cancer Building
ANC09500
Cancer Building
Cleveland, Ohio

Cleveland Clinic
Buildings and Properties
Office of Construction
8500 Euclid Avenue / CC4
Cleveland, Ohio 44195

Construction Project:
2014007105
Owner: CC
Contractor:
216-445-2000 Fax: 216-445-7000

100% DESIGN DEVELOPMENT
10 SEPTEMBER 2014



Scale:
1/16" = 1'-0"
Date:
08/13/2014
Sheet:
A4.02

Level 3



CLINICAL PRACTICE AREA, LUNG / H&N

10 PRIVATE; 1 PRIVATE ISOLATION; 5 SEMI PRIVATE; 16 TOTAL INFUSION TREATMENT STATIONS LUNG/ H & N

CLINICAL PRACTICE AREA, GI / CNS

10 PRIVATE; 1 PRIVATE ISOLATION; 5 SEMI PRIVATE; 16 TOTAL INFUSION TREATMENT STATIONS GI/ CNS

18 EXAM ROOMS; 1 PROCEDURE ROOM

30 EXAM ROOMS; 2 PROCEDURE ROOMS; 1 EN PROCEDURE



CLEVELAND CLINIC MAIN CAMPUS SITE PLAN
 DISCLAIMER:
 NO CLAIM IS MADE FOR THE ACCURACY OF THE INFORMATION ON THIS DRAWING OR DIGITAL OR HARD COPY FORM. THE INFORMATION ON THIS DRAWING IS PROVIDED FOR THE USER'S CONFORMANCE ONLY. ANY AND ALL USERS MUST ASSUME ALL RISK AND LIABILITY FOR ANY ALTERATION OF THIS INFORMATION.

Project Team

- Architect**
 Skidmore, OWINGS & Merrill, P.C.
 100 East Broadway, Suite 1700
 Columbus, OH 43260-3000
 Tel: 614-462-8000 Fax: 614-462-8000
- Interior Designer**
 The Interior Group, Inc.
 15 West Ohio Avenue, Suite 1100
 Columbus, OH 43215
 Tel: 614-233-3470 Fax: 614-461-8000
- Mechanical, Electrical & Plumbing Engineer**
 Beck & Beckwith Real Estate Engineers, LLC
 The American Co. Co., Dayton, OH
 1000 North Main Street, Suite 1000
 Dayton, OH 45402-1000
- Structural Engineer**
 Lathrop & Condit, Inc.
 150 East Broad Street, Suite 1000
 Newark, OH 43055
 Tel: 614-863-0200 Fax: 614-863-0200
- Civil Engineer**
 O'Brien Engineering, Inc.
 1200 North State Street, Suite 300
 Columbus, OH 43215
 Tel: 614-462-3000 Fax: 614-462-3000
- Telcom & Security Engineer**
 HNTB Company, Inc.
 1000 North State Street, Suite 300
 Columbus, OH 43215
 Tel: 614-462-3000 Fax: 614-462-3000
- Medical Equipment Planner**
 Sellen Resources Group
 2000 Montgomery Avenue
 Dayton, OH 45424-1310
 Tel: 937-233-0811 Fax: 937-233-0777
- Landscape Architect**
 Clark & Associates, Inc.
 6600 Westwood Drive
 Columbus, OH 43235
 Tel: 614-277-7000 Fax: 614-277-7410
- Construction Manager**
 Team Construction Company
 The Heritage Building, 1425 East Avenue, Suite 1400
 Columbus, OH 43215
 Tel: 614-523-1100 Fax: 614-523-0940

2014

**Cleveland Clinic
 Cancer Building
 ANC09500
 Cancer Building
 Cleveland, Ohio**

**Cleveland Clinic
 Buildings and Properties
 Office of Construction
 8500 Euclid Avenue / CC4
 Cleveland, Ohio 44195**

CLINICAL PRACTICE AREA, LUNG / H&N
 CLINICAL PRACTICE AREA, GI / CNS
 2014007105

100% DESIGN DEVELOPMENT
 10 SEPTEMBER 2014



LEVEL 3 DEPARTMENT
 PLAN

Scale: 1/16" = 1'-0"
 Date: 08/13/2014

Sheet: A4.03

Level 4



CLEVELAND CLINIC MAIN CAMPUS SITE PLAN

DISCLAIMER:
NO CLAIM IS MADE FOR THE ACCURACY OF THE INFORMATION ON THIS DRAWING OR DIGITAL OR HARD COPY FORM. THE INFORMATION ON THIS DRAWING IS PROVIDED FOR THE USER'S CONVENIENCE ONLY. ANY AND ALL USERS MUST ASSUME ALL RISK AND LIABILITY FOR ANY ALTERATION OF THIS INFORMATION.

Project Team

Architect
Stark Architecture, Inc. (Architect of Record)
135 Lake Shore Drive, Suite 100
Cleveland, OH 44115
Tel: 216.442.1000
Fax: 216.442.4800

Interior Designer
The Interior Group, LLC
135 Lake Shore Drive, Suite 100
Cleveland, OH 44115
Tel: 216.442.1000
Fax: 216.442.4800

Mechanical, Electrical & Plumbing Engineer
Rock Hill Research Consulting Engineers, LLC
The American Oil Co. Center, 277 Avenue Street
Mentor, OH 44130
Tel: 216.442.1000

Structural Engineer
Lathrop & Condit, Inc.
135 Lake Shore Drive, Suite 100
Cleveland, OH 44115
Tel: 216.442.1000

Civil Engineer
Cody Engineering, LLC
135 Lake Shore Drive, Suite 100
Cleveland, OH 44115
Tel: 216.442.1000

Telcom & Security Engineer
TSC Engineering, LLC
135 Lake Shore Drive, Suite 100
Cleveland, OH 44115
Tel: 216.442.1000

Medical Equipment Planner
Sedco Associates, Inc.
2000 Westwood Center
Dallas, TX 75201
Tel: 214.448.5000

Landscape Architect
Camp & Associates, Inc.
10000 W. 15th Street
Overland Park, KS 66204
Tel: 913.241.7000, Fax: 913.241.7143

Construction Manager
Team Construction Company
The Metro Building, 1425 East Avenue, Suite 1400
Cleveland, OH 44115
Tel: 216.522.1100, Fax: 216.522.0240

2014

Cleveland Clinic Cancer Building ANC09500
Cancer Building
Cleveland, Ohio

Cleveland Clinic Buildings and Properties Office of Construction
8500 Euclid Avenue / CC4
Cleveland, Ohio 44115
Tel: 216.644.2000, Fax: 216.644.7020, email:officemgmt@ccc.com

2014/07/105

LEVEL 4 DEPARTMENT PLAN

100% DESIGN DEVELOPMENT
10 SEPTEMBER 2014

Scale: 1/16" = 1'-0"
Date: 08/13/2014

Sheet: A4.04

Level 5



CLEVELAND CLINIC MAIN CAMPUS SITE PLAN

DISCLAIMER:
NO CLAIM IS MADE FOR THE ACCURACY OF THE INFORMATION ON THIS DRAWING OR DIGITAL OR HARD COPY FORM. THE INFORMATION ON THIS DRAWING IS PROVIDED FOR THE USER'S CONVENIENCE ONLY. ANY AND ALL USERS MUST VERIFY ALL DIMENSIONS IN THE FIELD. USERS MUST ASSUME ALL RISK AND LIABILITY FOR ANY ALTERATION OF THIS INFORMATION.

Project Team

- Architect**
Stetson Architecture, Inc. (Architect of Record)
1255 East Broad Street, Suite 100
Columbus, OH 43202-9900
Tel: 614-442-4444 Fax: 614-445-8800
- Interior Designer**
Stetson Architecture, Inc.
1255 East Broad Street, Suite 100
Columbus, OH 43202-9900
Tel: 614-442-4444 Fax: 614-445-8800
- Mechanical, Electrical & Plumbing Engineer**
Rock Hill Research Consulting Engineers, LLC
The Heritage Club Center, 777 Avenue of the Americas
New York, NY 10017-1001
Tel: 212-693-1000 Fax: 212-693-1000
- Structural Engineer**
Lafayette Consulting
1500 Eastland Park Road
Beverly Hills, CA 90210
Tel: 310-460-8000 Fax: 310-460-8000
- Civil Engineer**
Cody Engineering
12000 East 12th Avenue, Suite 300
Denver, CO 80231
Tel: 303-751-0001 Fax: 303-751-0077
- Telcom & Security Engineer**
TSC
10000 East 12th Avenue, Suite 300
Denver, CO 80231
Tel: 303-751-0001 Fax: 303-751-0077
- Medical Equipment Planner**
Salem Resource Group
12000 East 12th Avenue, Suite 300
Denver, CO 80231
Tel: 303-751-0001 Fax: 303-751-0077
- Landscape Architect**
Carter & Associates, Inc.
600 East Main Street
Cleveland, OH 44115
Tel: 440-247-7000 Fax: 440-247-7143
- Construction Manager**
Stetson Architecture, Inc.
1255 East Broad Street, Suite 100
Columbus, OH 43202-9900
Tel: 614-442-4444 Fax: 614-445-8800

2014

**Cleveland Clinic
Cancer Building
ANC09500
Cancer Building
Cleveland, Ohio**



100% DESIGN DEVELOPMENT
10 SEPTEMBER 2014

**LEVEL 5 DEPARTMENT
PLAN**

100% DESIGN DEVELOPMENT
10 SEPTEMBER 2014



Scale: 1/16" = 1'-0"
Date: 08/13/2014
Sheet: A4.05

Level 6



CLEVELAND CLINIC MAIN CAMPUS SITE PLAN

DISCLAIMER:
NO CLAIM IS MADE FOR THE ACCURACY OF THE INFORMATION ON THIS DRAWING OR THE DIGITAL OR HARD COPY FORMS. THE INFORMATION ON THIS DRAWING IS PROVIDED FOR THE USER'S CONVENIENCE ONLY. ANY AND ALL USERS MUST VERIFY ALL DIMENSIONS IN THE FIELD. USERS MUST ASSUME ALL RISK AND LIABILITY FOR ANY ALTERATION OF THIS INFORMATION.

Project Team

- Architect**
Stetson Architecture, Inc. (Architect of Record)
1251 Lee Boulevard, Suite 100
Columbus, OH 43260-9900
Tel: 614-442-6442 Fax: 614-445-8800
- Interior Designer**
Tetra Interiors, Inc.
10000 Eastman Avenue, Suite 100
Columbus, OH 43240-9800
Tel: 614-445-6800 Fax: 614-445-8800
- Mechanical, Electrical & Plumbing Engineer**
Hatch Mott MacDonald (Engineer of Record)
The American Consulting Engineers Council
1800 North 17th Street, Suite 1150
Columbus, OH 43217
Tel: 614-442-3470 Fax: 614-442-3475
- Structural Engineer**
Lathrop Construction
13500 Cleveland Road
Bexley, OH 43185
Tel: 614-865-3255 Fax: 614-865-8800
- Civil Engineer**
Carter Engineering
10000 Eastman Avenue, Suite 300
Columbus, OH 43240
Tel: 270-641-2000 Fax: 270-641-8200
- Telcom & Security Engineer**
Hatch Mott MacDonald
1800 North 17th Street, Suite 1150
Columbus, OH 43217
Tel: 614-442-3470 Fax: 614-442-3475
- Medical Equipment Planner**
Salem Equipment Planning
2000 Monaca Street
Dallas, TX 75201
Tel: 214-445-1000
- Landscape Architect**
Carter & Associates, Inc.
600 East Main Street
Columbus, OH 43215
Tel: 614-221-7000 Fax: 614-221-7143
- Construction Manager**
Hatch Mott MacDonald
The American Consulting Engineers Council
1800 North 17th Street, Suite 1150
Columbus, OH 43217
Tel: 270-641-2000 Fax: 270-641-8200

2014

**Cleveland Clinic
Cancer Building
ANC09500
Cancer Building
Cleveland, Ohio**



Sheet: 2014007105
Date: 08/13/2014

LEVEL 6 DEPARTMENT PLAN

**100% DESIGN DEVELOPMENT
10 SEPTEMBER 2014**



Scale: 1/16" = 1'-0"
Date: 08/13/2014
Sheet: A4.06

Master Plan

Roof Plan









